



**SCOTTISHPOWER
RENEWABLES**

East Anglia ONE North and East Anglia TWO Offshore Windfarms

Applicants' Responses to Examining Authority's Written Questions

Appendix 10 Landfall Indicative HDD Working Area

Applicants: East Anglia ONE North Limited and East Anglia TWO Limited
Document Reference: ExA.WQ-1.A10.D1.V1
SPR Reference: EA1N_EA2-DWF-ENV-REP-IBR-001085_0010

Date: 2nd November 2020
Revision: Version 01
Author: Royal HaskoningDHV

Applicable to East Anglia ONE North and East Anglia TWO

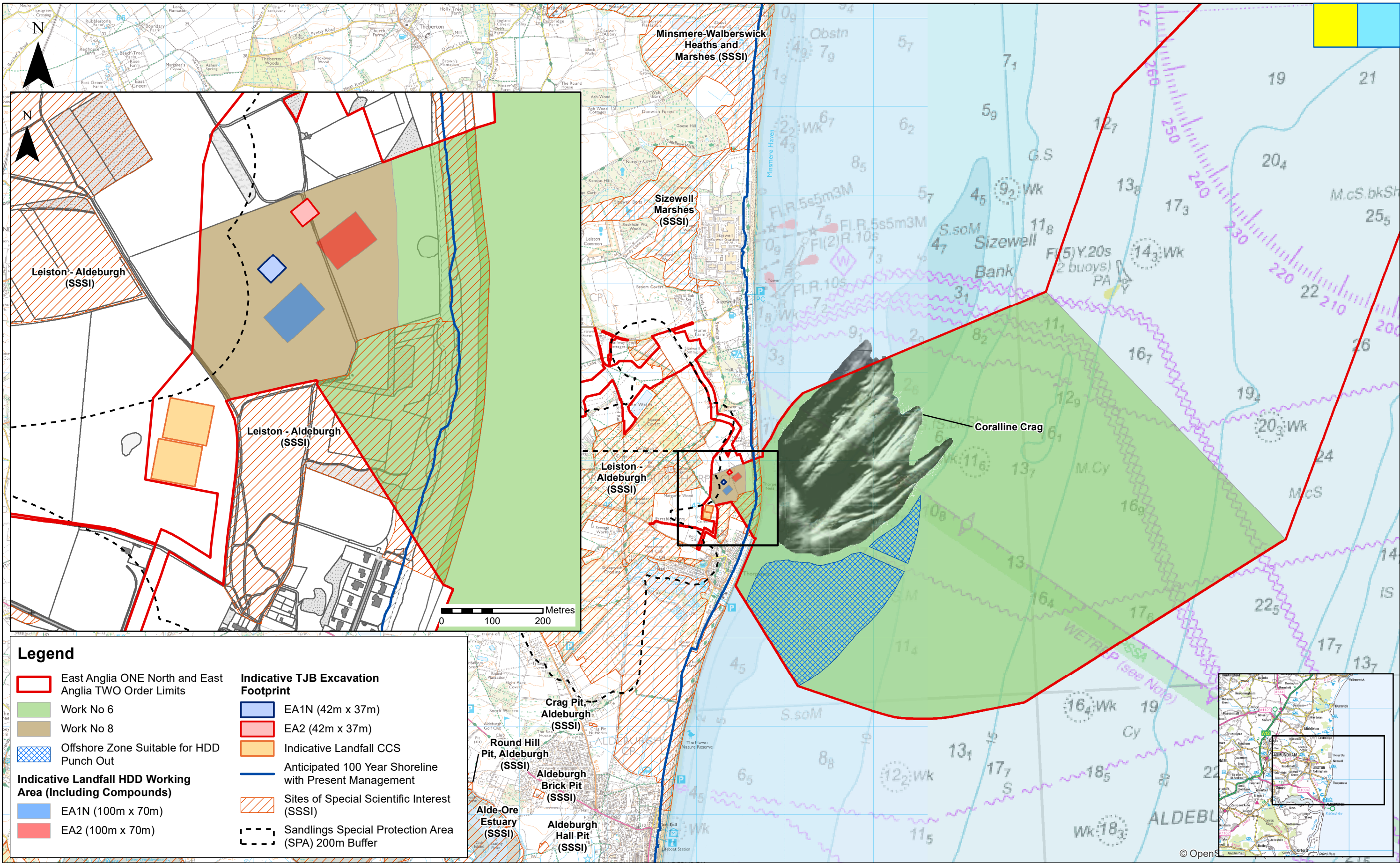

4	27/10/2020	AB	Fourth Issue.
3	22/10/2020	AB	Third Issue.
2	19/10/2020	AB	Second Issue.
Rev	Date	By	Comment

Prepared:	AB
Checked:	BD
Approved:	PP

A horizontal scale bar with alternating black and white segments. Below the bar are numerical markers for 0, 1, and 2. To the right of the bar, the word 'Kilometres' is written.

East Anglia ONE North and East Anglia TWO

Indicative Temporary Landfall Infrastructure

ExA Q1.11.7

Drg No	EA1N-EA2-DEV-DRG-IBR-001123	
Rev	4	Coordinate System: BNG Datum: OSGB36
Date	27/10/20	
Figure	1	