

REVISIONS

No.	DESCRIPTION	DATE
A	Generally updated prior planning issue. Issued to design team.	18/03/19 VP JO
B	Issued for planning	21/03/19 VP JO

NOTE:

- INDICATED BUILDING FOOTPRINT REFLECTS THE MOST RECENT SITE SURVEY AS RECIEVED FROM CLIENT.
- INDICATED EXISTING INTERNAL LAYOUT REFLECTS DLA's CLOSEST INTERPRETATION OF HISTORIC RASTER IMAGES OF THE BUILDING FLOOR PLANS.
- FACADE ARRANGEMENTS/ DETAILS - SUBJECT TO DETAILED BUILDING SURVEY. ARRANGEMENTS INDICATED ON THIS DRAWING REPRESENTS DLA's CLOSEST INTERPRETATION BASED ON CURRENT AND HISTORIC PHOTOGRAPHS.
- EXTENT OF LISTING PLOTTED OF A RASTER IMAGE FROM HISTORIC ENGLAND's WEBSITE.

NORTH



ARCHITECTURE

No. 55 | St Paul's Street | Leeds | LS1 2TE  
0113 887 3100 | www.dla-design.co.uk

PROJECT  
PRINCES QUAY, HULL

TITLE  
EXISTING SECOND FLOOR PLAN  
EARL DE GREY

SCALE | DATE  
As indicated @ A3 | 13/02/19

DLA REF	DRAWN	REVIEWED
2016-223	VP	JO

DRAWING NAME					
PROJECT	ORIGINATOR	ZONE	LEVEL	TYPE	ROLE   NUMBER
	DLA				0067

STATUS	SUITABILITY DESCRIPTION
	FOR PLANNING

REVISION	REVISION DESCRIPTION
B	

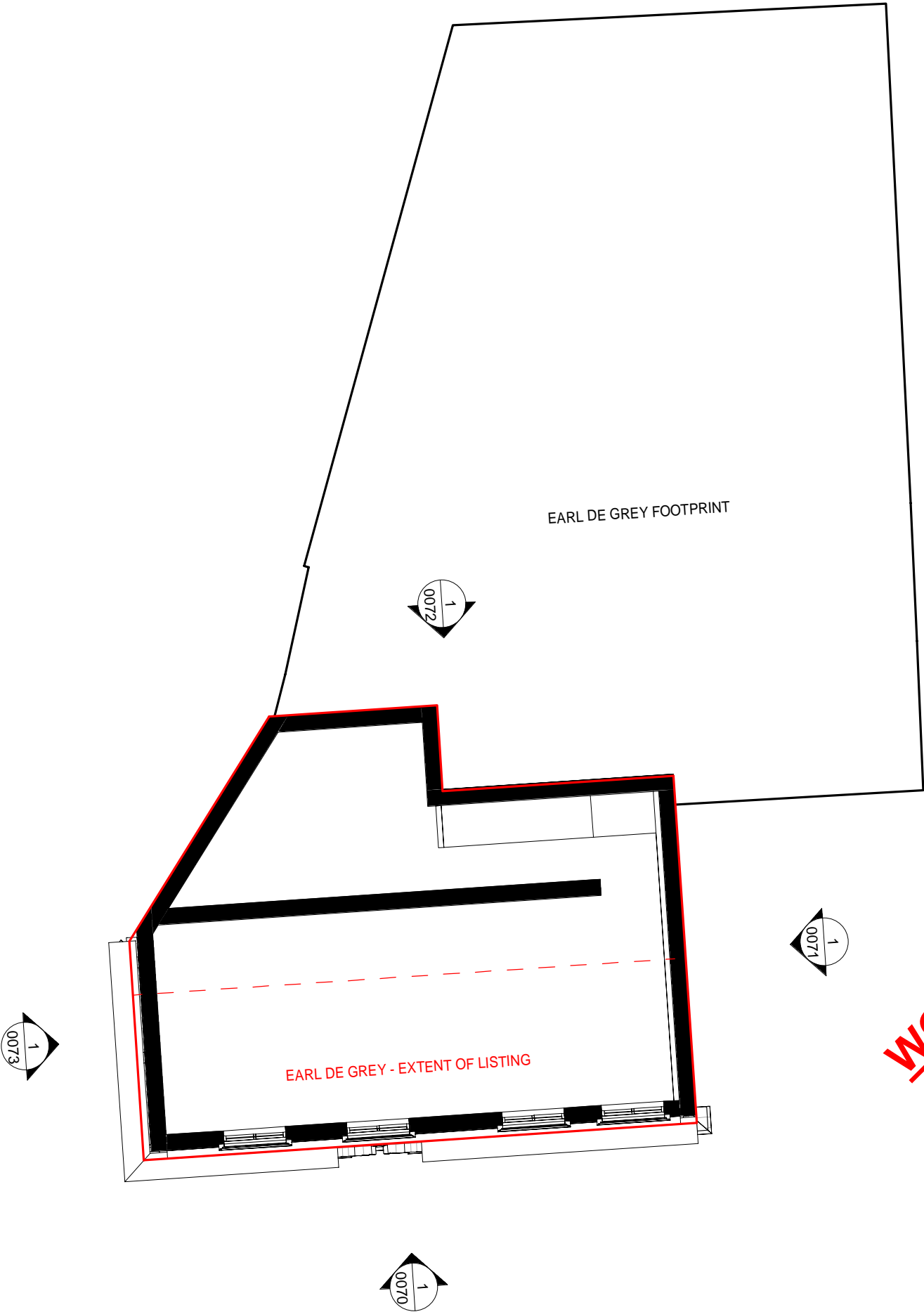

WORK IN PROGRESS: PENDING SURVEY

