

## **A38 Derby Junctions**

**TR010022**

**Volume 6**

### **6.3 Environmental Statement Appendices**

#### **Appendix 8.7a: Reptile Surveys in 2018**

Regulation 5(2)(a)

Planning Act 2008

Infrastructure Planning (Applications: Prescribed  
Forms and Procedure) Regulations 2009

April 2019

## Infrastructure Planning

### Planning Act 2008

#### **The Infrastructure Planning (Applications: Prescribed Forms and Procedure) Regulations 2009**

### A38 Derby Junctions Development Consent Order 202[ ]

---

#### **6.3 Environmental Statement Appendices Appendix 8.7a: Reptile Surveys in 2018**

---

<b>Regulation Number</b>	Regulation 5(2)(a)
<b>Planning Inspectorate Scheme Reference</b>	TR010022
<b>Application Document Reference</b>	6.3
<b>Author</b>	A38 Derby Junctions Project Team, Highways England

<b>Version</b>	<b>Date</b>	<b>Status of Version</b>
1	April 2019	DCO Application

## TECHNICAL NOTE

<b>Project:</b>	<b>A38 Derby Junctions</b>				
<b>Title:</b>	<b>Reptile Survey Report 2018</b>				
<b>Doc ID:</b>	<b>HE514503-ACM-EBD-A38_SW_PR_ZZ-TN-EG-0006</b>				
<b>Date:</b>	<b>November 2018</b>	Version:	<b>P02</b>	Status:	<b>S4</b>

Revision	Date	Prepared by	Reviewed by	Approved by
P01	07/11/2018	Claudia Ardrey	Darryn Nash	Paul Benyon
P02	14/11/2018	Claudia Ardrey	Charlotte Bragg Simon Wild	Andy Wilson

### 1 Introduction

- 1.1 AECOM has been instructed by Highways England to provide design services with regards to the A38 Derby Junctions scheme (referred to herein as the Scheme).
- 1.2 To assist with the assessment of the Scheme's potential environmental effects, a range of environmental surveys have been undertaken since 2015 to define prevailing baseline conditions. However, as the Scheme's design progresses, a number of updates have occurred and the Scheme boundary has been refined.
- 1.3 Three new discrete locations were identified in 2017, as part of the updated Phase 1 Habitat survey (AECOM(a), 2017; HE514503-ACM-EBD-A38\_SW\_PR\_ZZ-RP-EG-0004) to have potential habitat to support reptiles. Reptile surveys of these three locations were undertaken in 2017 (AECOM(b), 2017; HE514503-ACM-EBD-A38\_SW\_PR\_ZZ-RP-EG-0012). However, due to access issues and vandalism, two sites had their surveys aborted (Site 10 and Site 19) and so surveys were repeated in 2018 - the results obtained are provided herein.
- 1.4 Refer to the A38 Reptile 2017 Survey (AECOM(b), 2017) for details of relevant ecological legislation and policy regarding reptiles, 2017 desk study results and habitat descriptions.

### 2 Methodology

- 2.1 Reptile surveys were carried out from April to June 2018 to determine presence/absence of reptiles at Site 10 and Site 19 (see Figure 1, Appendix A).
- 2.2 Surveys generally utilise three recognised methods i.e.:
  - Manual searches of natural refugia present on site;
  - Checks for signs of reptile activity including sloughed skins, egg laying sites *etc*; and
  - Sustained visual observation of suitable basking spots within the site (visual encounter survey).
- 2.3 However, artificial refugia were not used for these surveys due to the persistent public interference with the refugia in 2017.
- 2.4 To address this limitation, the number of survey visits was increased to 10.

- 2.5 Attention was paid to the forecast temperatures to ensure periods of extreme heat were avoided during the surveys. Surveys were carried out between 6.30 am and 11 am, in an effort to ensure that surveying was undertaken between guideline temperatures of 10°C and 18°C and when there was little wind and intermittent hazy sunshine (representing ideal basking temperatures for UK reptiles). Table 1 lists the weather conditions at each survey visit.
- 2.6 In order to minimise any potential disturbance to basking reptiles, the surveyor's approach was cautious and slow, and where possible from the south where potential basking areas were observed with binoculars from a distance.
- 2.7 A log was kept of any reptiles observed (where applicable), noting species, number, gender (where possible) and age of reptiles i.e. adult, or juvenile (where possible). Other animals, such as amphibians and small rodents, were recorded (where applicable) as well as the date, weather conditions and temperature during each survey.

**Table 1: Reptile survey conditions**

Visit number	Date	Weather conditions	Temperature range throughout survey
1	16/04/2018	95% cloud cover with gentle breeze, damp ground conditions	12°C
2	19/04/2018	0% cloud cover, no wind with damp ground conditions	12°C - 16°C
3	23/04/2018	80% cloud cover at start of survey, clearing to 60% towards the end. Light breeze and dry ground conditions.	8°C - 13°C
4	26/04/2018	50% cloud cover with light breeze and damp ground conditions. Survey after rain, with sunny spells.	13°C
5	03/05/2018	50% cloud cover with light breeze. Damp ground conditions.	12°C - 13°C
6	10/05/2018	30% cloud cover with light breeze.	11°C
7	17/05/2018	75% cloud cover with no wind. Dry ground conditions.	15°C
8	24/05/2018	80% cloud cover with light breeze. Dry ground conditions.	13°C
9	04/06/2018	100% cloud cover with no wind. Damp ground conditions.	14°C - 16°C
10	07/06/2018	65% cloud cover with light breeze. Dry ground conditions.	13°C - 14°C

### 3 Results

- 3.1 No reptiles were recorded during the surveys at the two locations (Sites 10 and 19). Additionally, no amphibians or small rodents were recorded.

---

## 4 Summary and Recommendations

### Summary

- 4.1 A presence/ absence survey for reptiles was undertaken at two locations (Sites 10 and 19) within the Scheme boundary and associated 50m buffer identified as being of potential suitability to reptiles.
- 4.2 No reptiles were recorded during the surveys.

### Recommendations

- 4.3 Recommendations for mitigation and/ or enhancement of the Scheme for reptiles will be considered and reported in the Environmental Statement.

## 5 References

AECOM(a), Extended Phase 1 Habitat 2017 Report. Ref. No. HE514503-ACM-EBD-A38\_SW\_PR\_ZZ-RP-EG-0012.

AECOM(b), Reptile 2017 Survey Report. Ref. No. HE514503-ACM-EBD-A38\_SW\_PR\_ZZ-RP-EG-0012

## **Appendix A      Figure**

This map is produced from Ordnance Survey material with permission of Ordnance Survey on behalf of the Controller of Her Majesty's Stationery Office (C) Crown Copyright. Unauthorized reproduction infringes Crown Copyright and may lead to prosecution or civil proceedings. Highways England 100030649 2018.



Legend

- Scheme boundary (20180905)
- Reptile survey extent

Habitats

- Broad-leaved woodland
- Plantation broad-leaved woodland
- Coniferous Plantation
- Dense scrub
- Scattered scrub
- Scattered broad-leaved trees
- Semi-improved grassland
- Improved grassland
- Marshy grassland
- Poor semi-improved grassland
- Tall ruderal
- Water
- Dry pond
- Rocks
- Invasive Non-Native Species
- Arable
- Amenity
- Building
- Bare ground
- Hard standing
- No access
- Private Gardens - Not surveyed

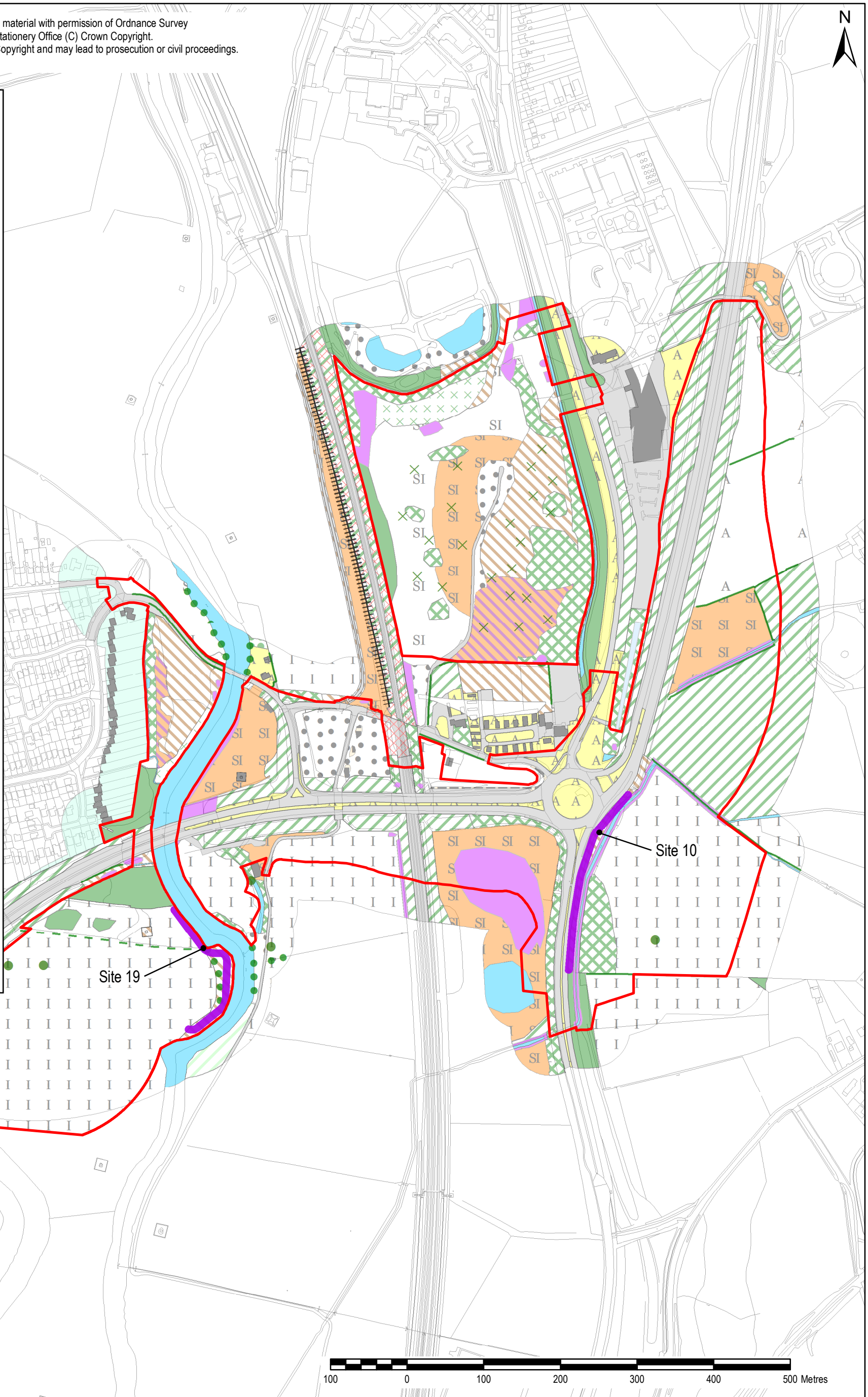

Project Title/Drawing Title	
A38 DERBY JUNCTIONS REPTILE SURVEY LITTLE EATON SPRING 2018	
THIS DOCUMENT HAS BEEN PREPARED PURSUANT TO AND SUBJECT TO THE TERMS OF AECOM'S APPOINTMENT BY ITS CLIENT. AECOM ACCEPTS NO LIABILITY FOR ANY USE OF THIS DOCUMENT OTHER THAN BY ITS ORIGINAL CLIENT OR FOLLOWING AECOM'S EXPRESS AGREEMENT TO SUCH USE, AND ONLY FOR THE PURPOSES FOR WHICH IT WAS PREPARED AND PROVIDED.	

AECOM Internal Project Number 60533462		
Drawn GSB	Checked DJN	Approved PB
Date 07/11/2018	Scale @ A3 1:5,000	Purpose of issue FINAL
Drawing Number Figure 1		Rev 0

A38 Derby Junctions Project  
Highways England, Floor 5  
2 Colmore Square  
38 Colmore Circus  
Birmingham  
B4 6BN

 highways  
england

---

AECOM  
Royal Court  
Basil Close, Chesterfield  
Derbyshire, S41 7SL  
+44 (0) 1246 209221  
+44 (0) 1246 209229  
[www.aecom.com](http://www.aecom.com)

 **AECOM**

File Name: \\W:\Highways Agency\47071390 A38 Derby Jns - Environment\Technical\Ecology\GIS A38\_2018\project\_files\Reptile\_2018\A38\_Reptile\_2018.mxd