

M42 Junction 6 Development Consent Order

Scheme Number TR010027

Volume 2

2.6(a) Traffic Regulation Measures Plans

Part 1 - Clearways and Weight Limits

Regulation 5(2)(o)

Planning Act 2008

Infrastructure Planning (Applications: Prescribed
Forms and Procedure) Regulations 2009

November 2019

Infrastructure Planning

Planning Act 2008

**The Infrastructure Planning
(Applications: Prescribed Forms
and Procedure) Regulations 2009**

M42 Junction 6
Development Consent Order 202[]

Traffic Regulation Measures Plans

**Part 1 – Clearways and Weight
Limits**

Regulation Number	Regulation 5(2)(o)
Planning Inspectorate Scheme Reference	TR010027
Application Document Reference	2.6(a)
Author	M42 Junction 6 Project Team and Highways England

Version	Date	Status of Version
1	January 2019	DCO Application
2	November 2019	DCO Examination Deadline 9

Schedule of Plans included in this Application Document

Drawing Number	Drawing Title	Revision
HE551485-ACM-GEN-ZZ_SW_DCO_ZZ-DR-DC-2600	Traffic Regulation Measures Regulation 5(2)(o) Clearways & Weight Limits Key Plan	C02
HE551485-ACM-GEN-ZZ_SW_DCO_ZZ-DR-DC-2601	Traffic Regulation Measures Regulation 5(2)(o) Clearways & Weight Limits Sheet 1 of 7	C02
HE551485-ACM-GEN-ZZ_SW_DCO_ZZ-DR-DC-2602	Traffic Regulation Measures Regulation 5(2)(o) Clearways & Weight Limits Sheet 2 of 7	C02
HE551485-ACM-GEN-ZZ_SW_DCO_ZZ-DR-DC-2603	Traffic Regulation Measures Regulation 5(2)(o) Clearways & Weight Limits Sheet 3 of 7	C02
HE551485-ACM-GEN-ZZ_SW_DCO_ZZ-DR-DC-2604	Traffic Regulation Measures Regulation 5(2)(o) Clearways & Weight Limits Sheet 4 of 7	C02
HE551485-ACM-GEN-ZZ_SW_DCO_ZZ-DR-DC-2605	Traffic Regulation Measures Regulation 5(2)(o) Clearways & Weight Limits Sheet 5 of 7	C02
HE551485-ACM-GEN-ZZ_SW_DCO_ZZ-DR-DC-2606	Traffic Regulation Measures Regulation 5(2)(o) Clearways & Weight Limits Sheet 6 of 7	C02
HE551485-ACM-GEN-ZZ_SW_DCO_ZZ-DR-DC-2607	Traffic Regulation Measures Regulation 5(2)(o) Clearways & Weight Limits Sheet 7 of 7	C02

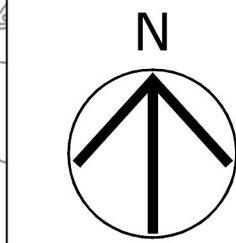

This map is based upon Ordnance Survey material with the permission of Ordnance Survey on behalf of the Controller of Her Majesty's Stationery Office © Crown copyright. Unauthorised reproduction infringes Crown copyright and may lead to prosecution or civil proceedings. Highways England 100030649 2019



NOTES

- DO NOT SCALE FROM THIS DRAWING, USE ONLY PRINTED DIMENSIONS.
- THE PROPOSED WORKS SHOWN ARE ILLUSTRATIVE ONLY AND WILL BE SUBJECT TO CHANGE AS PART OF DETAILED DESIGN DEVELOPMENT. ANY CHANGES WILL BE LIMITED TO BEING WITHIN THE ORDER LIMITS AND ANY OTHER CONSTRAINTS INCLUDED IN THE DEVELOPMENT CONSENT ORDER.
- THIS DRAWING IS TO BE READ IN CONJUNCTION WITH ALL OTHER PLANS AND DOCUMENTATION.

LEGEND

-  LIMITS OF LAND TO BE ACQUIRED OR USED PERMANENTLY OR TEMPORARILY (THE ORDER LIMITS)
-  LAND NOT INCLUDED WITHIN THE ORDER LIMITS

First Issue	WC	LIB	17/05/19	C01
Revised for Deadline 9	WC	PJK	14/11/19	C02
Revision Details		By	Date	Suffix
		Check		

DCO SUBMISSION

Client
Highways England
Floor 5
Two Colindale Square
38 Colindale Avenue
B4 6BN



Development Consent Order Number
TR010027

Project Title
M42 JUNCTION 6 IMPROVEMENT

Drawing Title
TRAFFIC REGULATION MEASURES, REGULATION 5(4) CLEARWAYS & WEIGHT LIMITS KEY PLAN

Designed CW	Drawn WC	Checked JCH	Approved PJK	Date 14/11/19
Internal Project No. 60543032		Suitability D7		
Scale @ A1 NTS		Zone Scheme Wide General		

THIS DOCUMENT HAS BEEN PREPARED PURSUANT TO AND SUBJECT TO THE TERMS OF AECOM'S APPOINTMENT BY ITS CLIENT. AECOM ACCEPTS NO LIABILITY FOR ANY USE OF THIS DOCUMENT OTHER THAN BY ITS ORIGINAL CLIENT OR FOLLOWING AECOM'S EXPRESS AGREEMENT TO SUCH USE, AND ONLY FOR THE PURPOSES FOR WHICH IT WAS PREPARED AND PROVIDED.

Drawing Number Highways England PIN HE551485 -ACM	I Originator -GEN -	I Volume ZZ SW_DCO_ZZ -DR-DC-2600	Rev C02
Localities	I Type	I Role	I Number

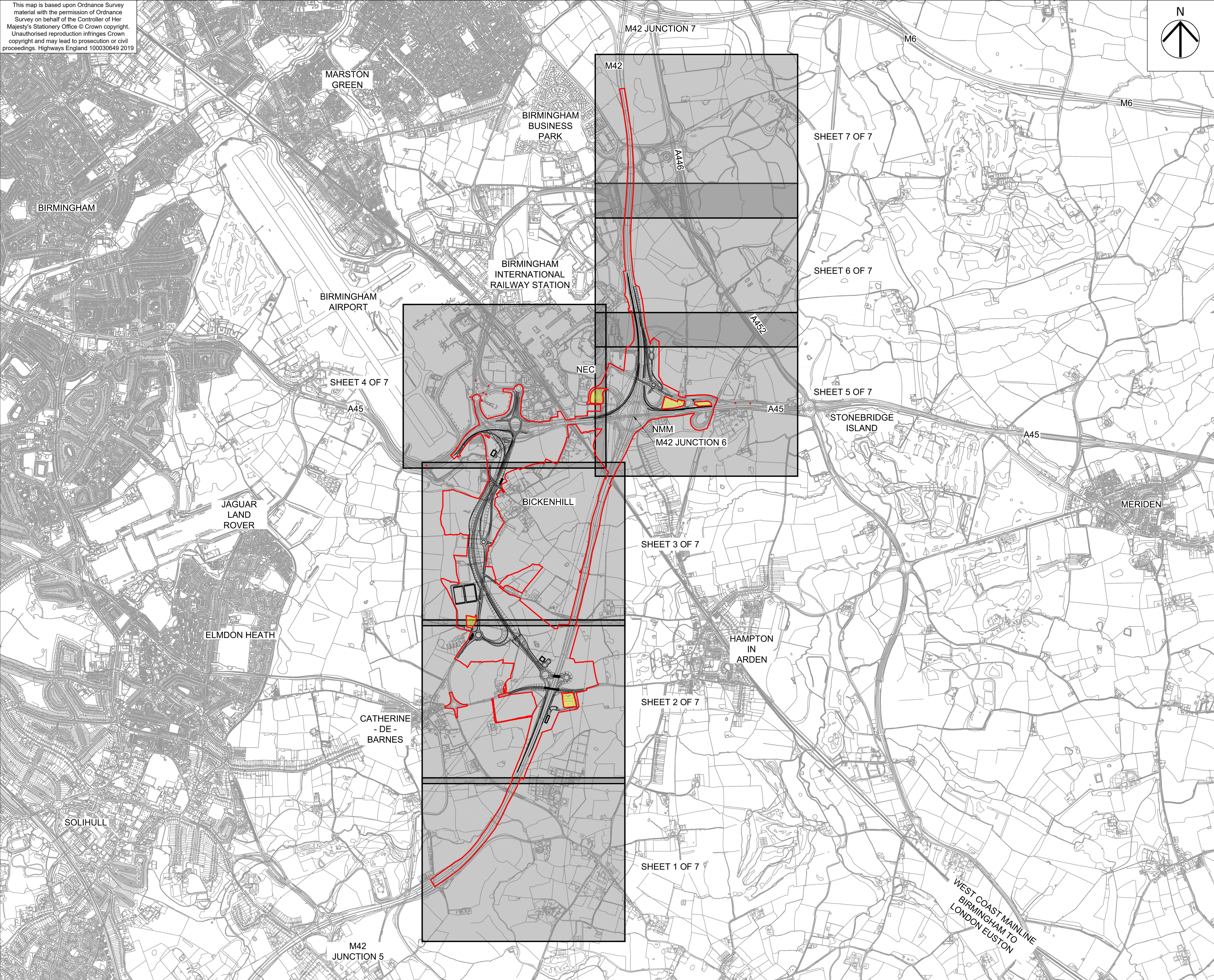

This map is based upon Ordnance Survey material with the permission of Ordnance Survey on behalf of the Controller of Her Majesty's Stationery Office © Crown copyright. Unauthorised reproduction infringes Crown copyright and may lead to prosecution or civil proceedings. Highways England 100030649 2019

SHEET 2

SHEET 1

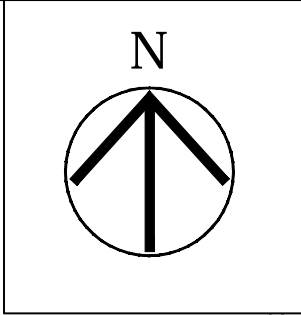

- NOTES
1. ALL DIMENSIONS IN METRES UNLESS STATED OTHERWISE.
 2. DO NOT SCALE FROM THIS DRAWING. USE ONLY PRINTED DIMENSIONS.
 3. THE PROPOSED WORKS SHOWN ARE ILLUSTRATIVE ONLY AND WILL BE SUBJECT TO CHANGE AS PART OF DETAILED DESIGN DEVELOPMENT. ANY CHANGES WILL BE LIMITED TO BEING WITHIN THE ORDER LIMITS AND ANY OTHER CONSTRAINTS INCLUDED IN THE DEVELOPMENT CONSENT ORDER.
 4. THIS DRAWING IS TO BE READ IN CONJUNCTION WITH ALL OTHER PLANS AND DOCUMENTATION, IN PARTICULAR SCHEDULE 3 OF THE DEVELOPMENT CONSENT ORDER [TR010027/APP/3.1] AND THE GENERAL ARRANGEMENT PLANS [TR010027/APP/2.4].

- LEGEND
- LIMITS OF LAND TO BE ACQUIRED OR USED PERMANENTLY OR TEMPORARILY (THE ORDER LIMITS)
 - LAND NOT INCLUDED WITHIN THE ORDER LIMITS
 - LIMITS OF LAND TO BE TEMPORARILY ACQUIRED FOR SIGNAGE INSTALLATION
 - - - EXISTING RED ROUTE ON LOCAL ROADS TO BE RETAINED
 - - - WEIGHT RESTRICTION 7.5T
 - - - PROPOSED RED ROUTE CLEARWAY ON TRUNK ROADS
 - - - PROPOSED RED ROUTE CLEARWAY ON LOCAL ROADS
 - PROHIBITION OF ENTRY
 - PROPOSED STRUCTURE

SHEET NOT USED AS PART OF THIS DRAWING SERIES

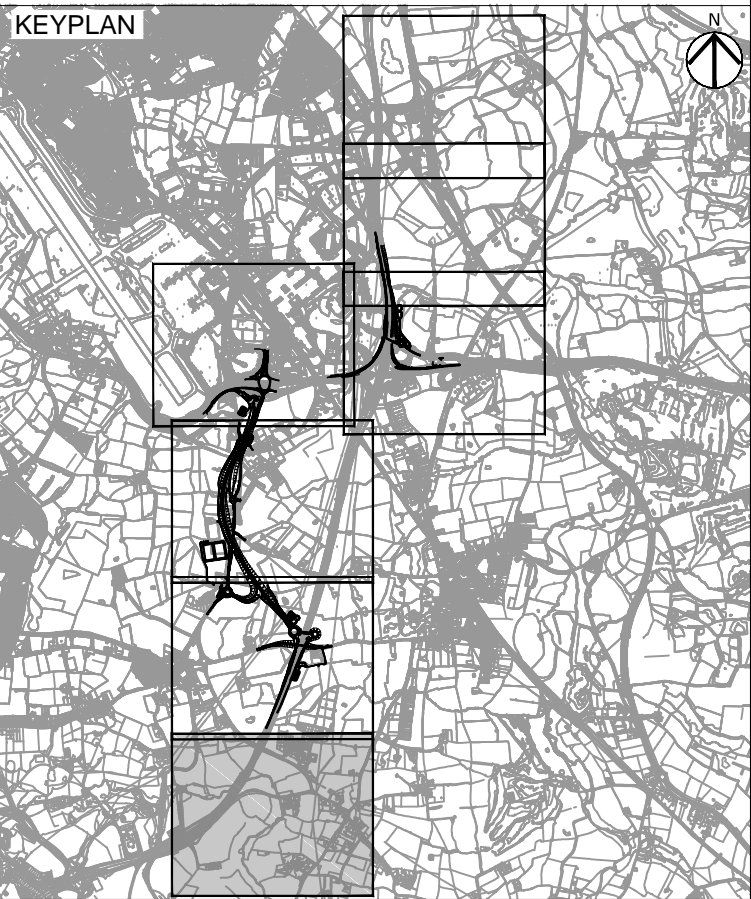

First Issue	WC	LIB	20/08/19	C01
Revised for Deadline 9	WC	PJK	14/11/19	C02
Revision Details	By	Check	Date	Suffix

Purpose of issue
DCO SUBMISSION

Client
Highways England
Floor 5
Two Colmore Square
38 Colmore Circus
B4 6BN



Development Consent Order Number
TR010027

Project Title
M42 JUNCTION 6 IMPROVEMENT

Drawing Title
TRAFFIC REGULATION MEASURES, REGULATION 5(2)(o) CLEARWAYS & WEIGHT LIMITS SHEET 1 OF 7

Designed CW	Drawn WC	Checked JCH	Approved PJK	Date 14/11/19
Internal Project No. 60543032		Suitability D7		
Scale @ A1 1:2500		Zone Scheme Wide General		

THIS DOCUMENT HAS BEEN PREPARED PURSUANT TO AND SUBJECT TO THE TERMS OF AECOM'S APPOINTMENT BY ITS CLIENT. AECOM ACCEPTS NO LIABILITY FOR ANY USE OF THIS DOCUMENT OTHER THAN BY ITS ORIGINAL CLIENT OR FOLLOWING AECOM'S EXPRESS AGREEMENT TO SUCH USE, AND ONLY FOR THE PURPOSES FOR WHICH IT WAS PREPARED AND PROVIDED.

Drawing Number Highways England PIN HE551485	Originator -ACM	Volume -GEN-	Rev C02
Location ZZ_SW_DCO_ZZ	Type -DR-DC-2601	Role Location	Number 1

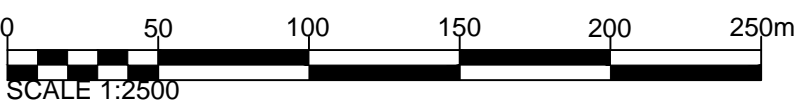

This map is based upon Ordnance Survey material with the permission of Ordnance Survey on behalf of the Controller of Her Majesty's Stationery Office © Crown copyright. Unauthorised reproduction infringes Crown copyright and may lead to prosecution or civil proceedings. Highways England 100030649 2019

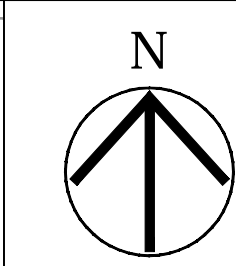
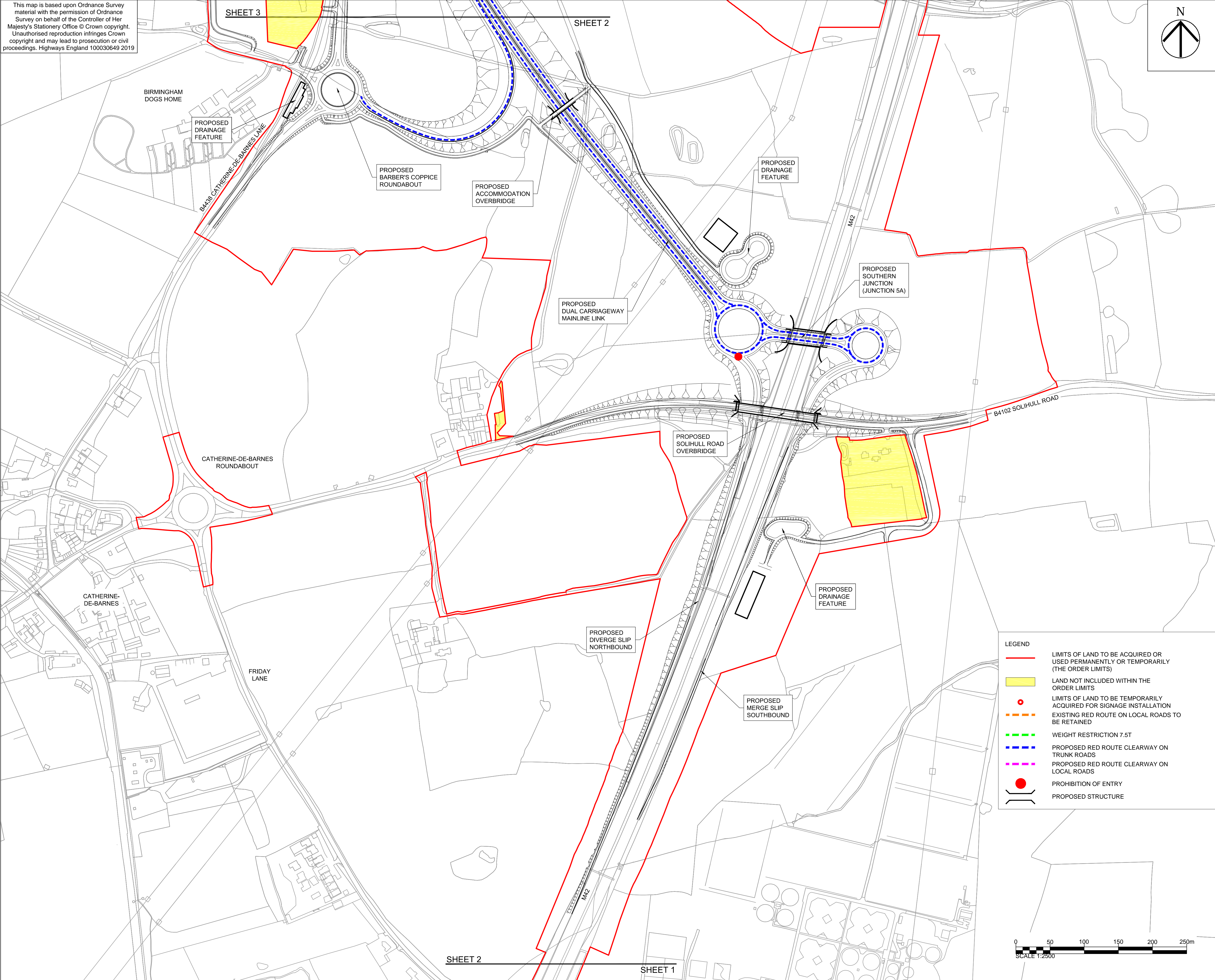

- NOTES
1. ALL DIMENSIONS IN METRES UNLESS STATED OTHERWISE.
 2. DO NOT SCALE FROM THIS DRAWING, USE ONLY PRINTED DIMENSIONS.
 3. THE PROPOSED WORKS SHOWN ARE ILLUSTRATIVE ONLY AND WILL BE SUBJECT TO CHANGE AS PART OF DETAILED DESIGN DEVELOPMENT. ANY CHANGES WILL BE LIMITED TO BEING WITHIN THE ORDER LIMITS AND ANY OTHER CONSTRAINTS INCLUDED IN THE DEVELOPMENT CONSENT ORDER.
 4. THIS DRAWING IS TO BE READ IN CONJUNCTION WITH ALL OTHER PLANS AND DOCUMENTATION, IN PARTICULAR SCHEDULE 3 OF THE DEVELOPMENT CONSENT ORDER [TR010027/APP/3.1] AND THE GENERAL ARRANGEMENT PLANS [TR010027/APP/2.4].

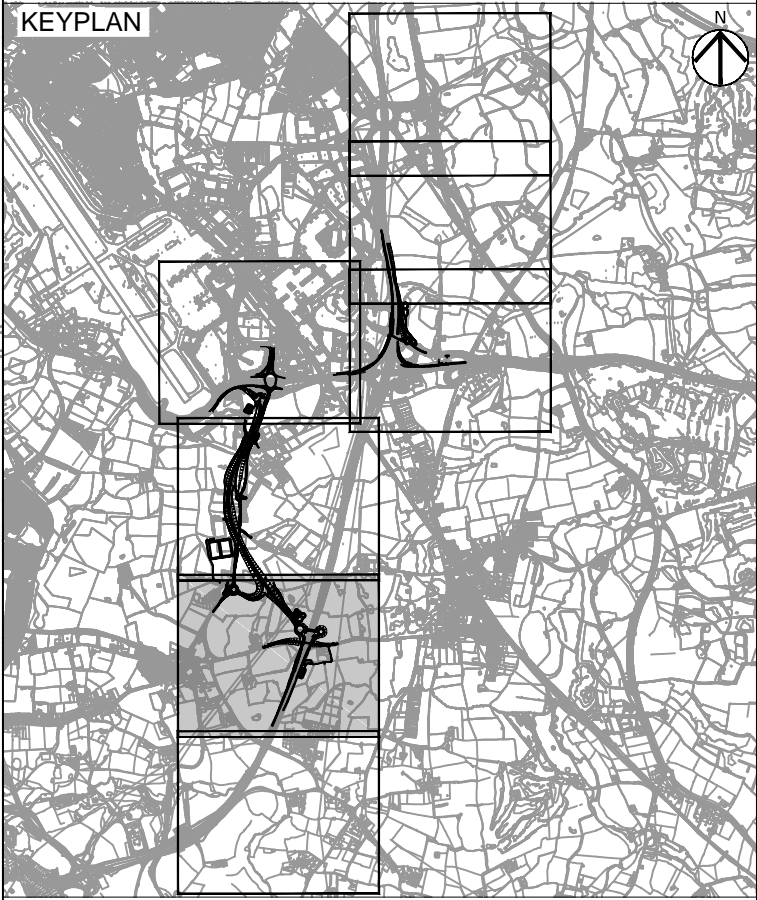

First Issue	WC	LIB	20/08/19	C01
Revised for Deadline 9	WC	PJK	14/11/19	C02
Revision Details	By	Check	Date	Suffix

DCO SUBMISSION

Client
Highways England
Floor 5
Two Colmore Square
38 Colmore Circus
B4 6BN



Development Consent Order Number
TR010027

M42 JUNCTION 6 IMPROVEMENT

TRAFFIC REGULATION MEASURES, REGULATION 5(2)(o) CLEARWAYS & WEIGHT LIMITS SHEET 2 OF 7

Designed CW	Drawn WC	Checked JCH	Approved PJK	Date 14/11/19
Internal Project No. 60543032	Suitability D7	Zone 1:2500	Scheme Wide General	

THIS DOCUMENT HAS BEEN PREPARED PURSUANT TO AND SUBJECT TO THE TERMS OF AECOM'S APPOINTMENT BY ITS CLIENT. AECOM ACCEPTS NO LIABILITY FOR ANY USE OF THIS DOCUMENT OTHER THAN BY ITS ORIGINAL CLIENT OR FOLLOWING AECOM'S EXPRESS AGREEMENT TO SUCH USE, AND ONLY FOR THE PURPOSES FOR WHICH IT WAS PREPARED AND PROVIDED.

Drawing Number HE551485 -ACM	Originator -GEN -	Volume ZZ_SW_DCO_ZZ	Rev C02
Location ZZ_SW_DCO_ZZ	Type I	Role I	Number I

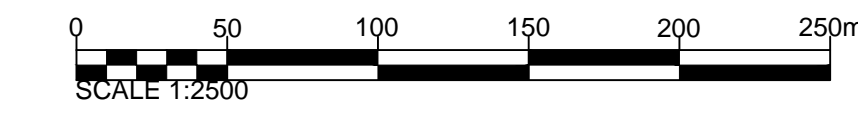

This map is based upon Ordnance Survey material with the permission of Ordnance Survey on behalf of the Controller of Her Majesty's Stationery Office © Crown copyright. Unauthorised reproduction infringes Crown copyright and may lead to prosecution or civil proceedings. Highways England 100030649 2019

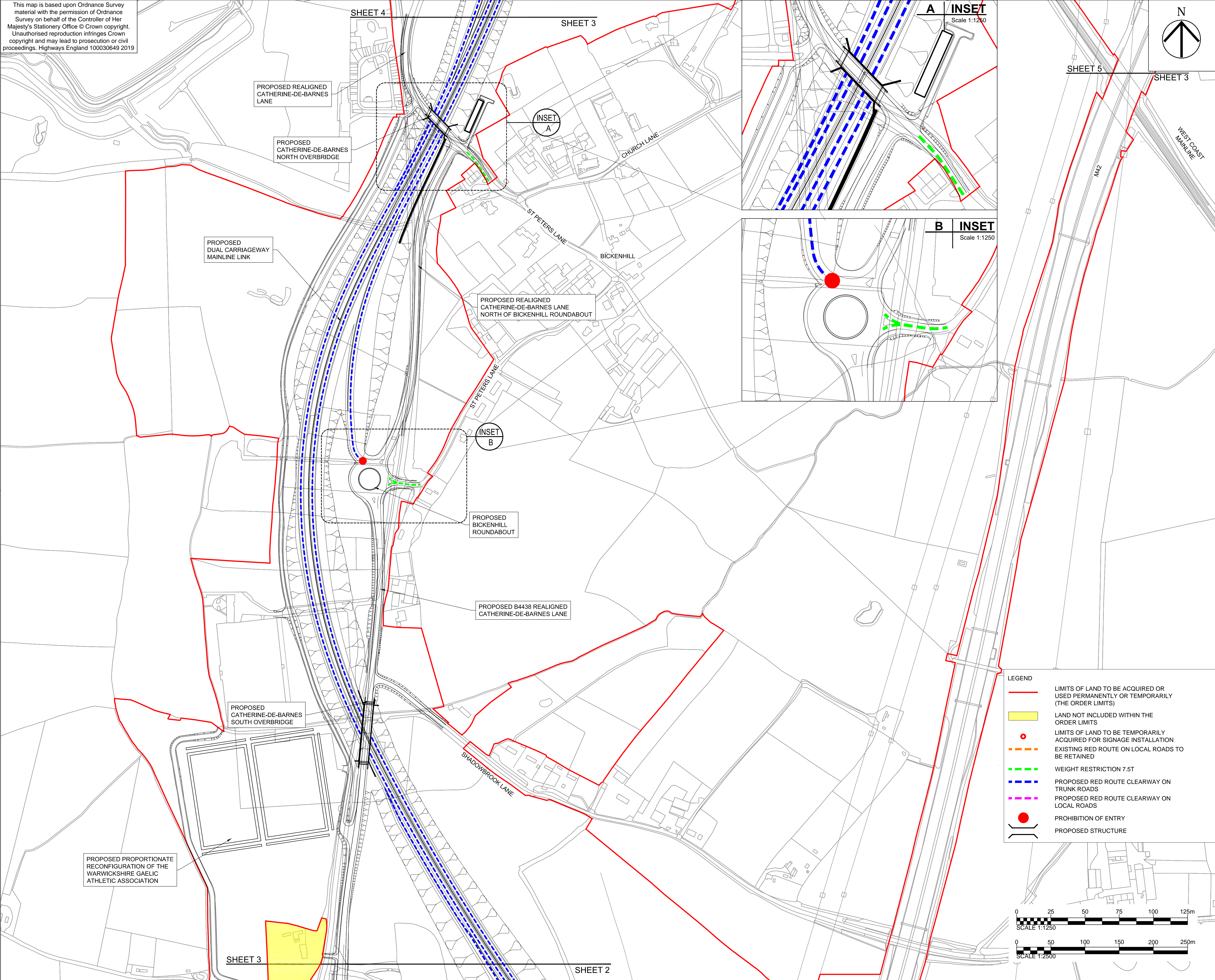

- NOTES
1. ALL DIMENSIONS IN METRES UNLESS STATED OTHERWISE.
 2. DO NOT SCALE FROM THIS DRAWING, USE ONLY PRINTED DIMENSIONS.
 3. THE PROPOSED WORKS SHOWN ARE ILLUSTRATIVE ONLY AND WILL BE SUBJECT TO CHANGE AS PART OF DETAILED DESIGN DEVELOPMENT. ANY CHANGES WILL BE LIMITED TO BEING WITHIN THE ORDER LIMITS AND ANY OTHER CONSTRAINTS INCLUDED IN THE DEVELOPMENT CONSENT ORDER.
 4. THIS DRAWING IS TO BE READ IN CONJUNCTION WITH ALL OTHER PLANS AND DOCUMENTATION, IN PARTICULAR SCHEDULE 3 OF THE DEVELOPMENT CONSENT ORDER [TR010027/APP/3.1] AND THE GENERAL ARRANGEMENT PLANS [TR010027/APP/2.4].

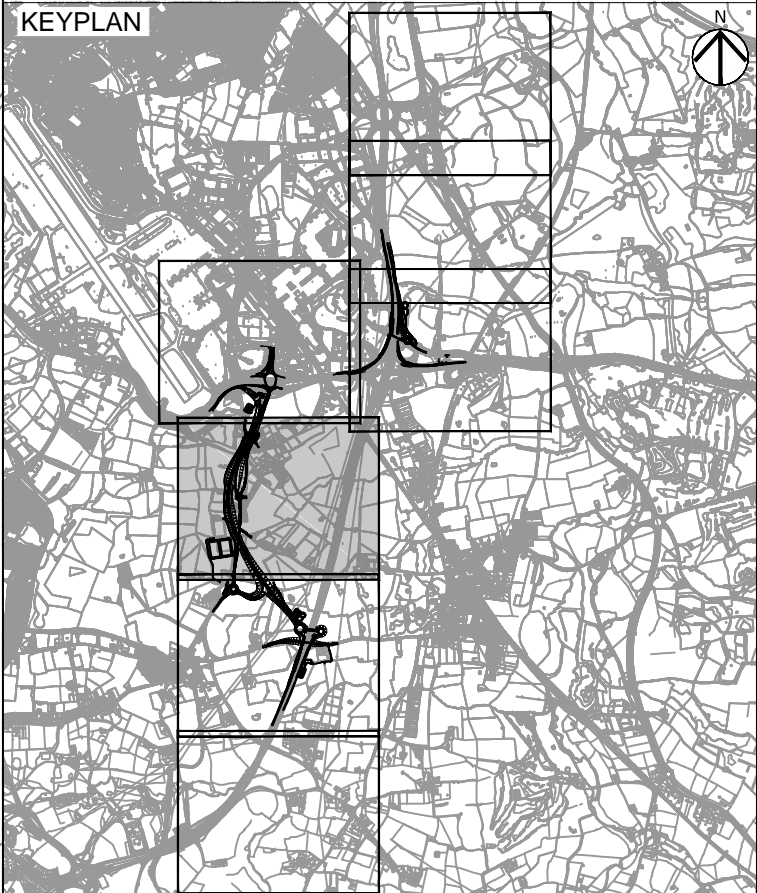

First Issue	WC	LIB	20/08/19	C01
Revised for Deadline 9	WC	PJK	14/11/19	C02
Revision Details	By	Check	Date	Suffix

DCO SUBMISSION

Client
Highways England
Floor 5
Two Colmore Square
38 Colmore Circus
B4 6BN



Development Consent Order Number
TR010027

M42 JUNCTION 6 IMPROVEMENT

TRAFFIC REGULATION MEASURES, REGULATION 5(2)(o) CLEARWAYS & WEIGHT LIMITS SHEET 3 OF 7

Designed CW	Drawn WC	Checked JCH	Approved PJK	Date 14/11/19
Internal Project No. 60543032	Suitability D7	Zone 1:2500	Scheme Wide General	

THIS DOCUMENT HAS BEEN PREPARED PURSUANT TO AND SUBJECT TO THE TERMS OF AECOM'S APPOINTMENT BY ITS CLIENT. AECOM ACCEPTS NO LIABILITY FOR ANY USE OF THIS DOCUMENT OTHER THAN BY ITS ORIGINAL CLIENT OR FOLLOWING AECOM'S EXPRESS AGREEMENT TO SUCH USE, AND ONLY FOR THE PURPOSES FOR WHICH IT WAS PREPARED AND PROVIDED.

Drawing Number Highways England PIN HE551485	I Originator -ACM	I Volume -GEN-	Rev C02
Location ZZ_SW_DCO_ZZ	I Type -DR-DC	I Role 2603	

- LEGEND
- LIMITS OF LAND TO BE ACQUIRED OR USED PERMANENTLY OR TEMPORARILY (THE ORDER LIMITS)
 - LAND NOT INCLUDED WITHIN THE ORDER LIMITS
 - LIMITS OF LAND TO BE TEMPORARILY ACQUIRED FOR SIGNAGE INSTALLATION
 - - - EXISTING RED ROUTE ON LOCAL ROADS TO BE RETAINED
 - - - WEIGHT RESTRICTION 7.5T
 - - - PROPOSED RED ROUTE CLEARWAY ON TRUNK ROADS
 - - - PROPOSED RED ROUTE CLEARWAY ON LOCAL ROADS
 - PROHIBITION OF ENTRY
 - PROPOSED STRUCTURE

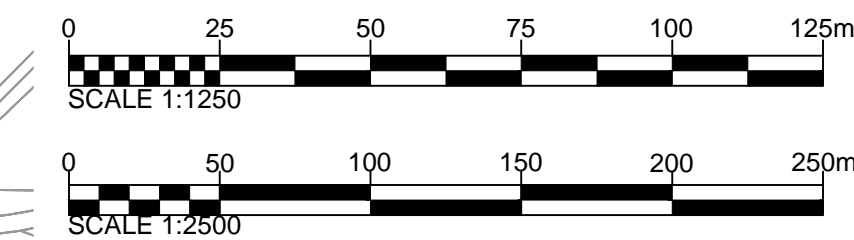

This map is based upon Ordnance Survey material with the permission of Ordnance Survey on behalf of the Controller of Her Majesty's Stationery Office © Crown copyright. Unauthorised reproduction infringes Crown copyright and may lead to prosecution or civil proceedings. Highways England 100030649 2019.

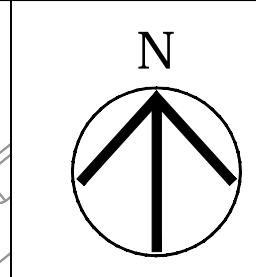

- NOTES
1. ALL DIMENSIONS IN METRES UNLESS STATED OTHERWISE.
 2. DO NOT SCALE FROM THIS DRAWING. USE ONLY PRINTED DIMENSIONS.
 3. THE PROPOSED WORKS SHOWN ARE ILLUSTRATIVE ONLY AND WILL BE SUBJECT TO CHANGE AS PART OF DETAILED DESIGN DEVELOPMENT. ANY CHANGES WILL BE LIMITED TO BEING WITHIN THE ORDER LIMITS AND ANY OTHER CONSTRAINTS INCLUDED IN THE DEVELOPMENT CONSENT ORDER.
 4. THIS DRAWING IS TO BE READ IN CONJUNCTION WITH ALL OTHER PLANS AND DOCUMENTATION, IN PARTICULAR SCHEDULE 3 OF THE DEVELOPMENT CONSENT ORDER [TR010027/APP/3.1] AND THE GENERAL ARRANGEMENT PLANS [TR010027/APP/2.4].

LEGEND

- LIMITS OF LAND TO BE ACQUIRED OR USED PERMANENTLY OR TEMPORARILY (THE ORDER LIMITS)
- LAND NOT INCLUDED WITHIN THE ORDER LIMITS
- LIMITS OF LAND TO BE TEMPORARILY ACQUIRED FOR SIGNAGE INSTALLATION
- EXISTING RED ROUTE ON LOCAL ROADS TO BE RETAINED
- WEIGHT RESTRICTION 7.5T
- PROPOSED RED ROUTE CLEARWAY ON TRUNK ROADS
- PROPOSED RED ROUTE CLEARWAY ON LOCAL ROADS
- PROHIBITION OF ENTRY
- PROPOSED STRUCTURE

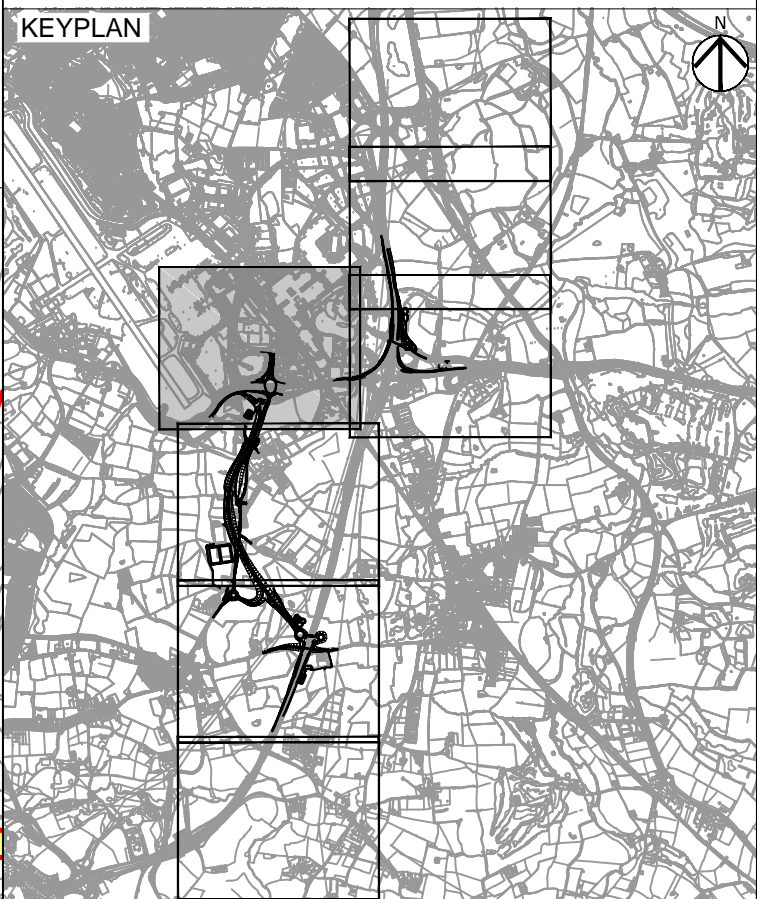

First Issue	WC	LIB	20/08/19	C01
Revised for Deadline 9	WC	PJK	14/11/19	C02
Revision Details		By	Date	Suffix
		Check		

DCO SUBMISSION

Client
Highways England
Floor 5
Two Colonnade Square
38 Colonnade Circus
B4 6BN



Development Consent Order Number
TR010027

M42 JUNCTION 6 IMPROVEMENT

TRAFFIC REGULATION MEASURES, REGULATION 5(2)(o) CLEARWAYS & WEIGHT LIMITS SHEET 4 OF 7

Designed	Drawn	Checked	Approved	Date
CW	JCH	PJK	PJK	14/11/19
Internal Project No.		Suitability		
60543032		D7		
Scale @ A1		Zone		
1:2500		Scheme Wide General		

THIS DOCUMENT HAS BEEN PREPARED PURSUANT TO AND SUBJECT TO THE TERMS OF AECOM'S APPOINTMENT BY ITS CLIENT. AECOM ACCEPTS NO LIABILITY FOR ANY USE OF THIS DOCUMENT OTHER THAN BY ITS ORIGINAL CLIENT OR FOLLOWING AECOM'S EXPRESS AGREEMENT TO SUCH USE, AND ONLY FOR THE PURPOSES FOR WHICH IT WAS PREPARED AND PROVIDED.

Drawing Number	Highways England PIN	I Originator	I Volume	Rev
HE551485	-ACM	-GEN	-	C02
ZZ SW_DCO_ZZ	-DR-DC	2604		
Location	I Type	I Role	I Number	

BIRMINGHAM AIRPORT

BIRMINGHAM INTERNATIONAL RAILWAY STATION

PENDIGO LAKE

NEC

AIRPORT WAY

B4438 BICKENHILL LANE

BICKENHILL LANE

REALIGNED A45 EASTBOUND LINK TO BICKENHILL LANE

SEGREGATED LEFT TURN LANE TO A45 WESTBOUND

BICKENHILL LANE

REALIGNED BICKENHILL LANE

TRINITY PARK

CLOCK INTERCHANGE

ARDEN HOTEL

PERIMETER ROAD

SOUTH CAR PARK ROAD

SHEET 5

A45 COVENTRY ROAD

PROPOSED PEDESTRIAN OVERBRIDGE

CHURCH LANE

WEST COAST MAINLINE

SHEET 4

PROPOSED FREE FLOW LINK TO AIRPORT WAY CONNECTOR ROAD

PROPOSED DUAL CARRIAGEWAY MAINLINE LINK

SHEET 4

SHEET 3

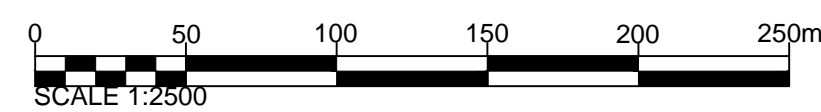

This map is based upon Ordnance Survey material with the permission of Ordnance Survey on behalf of the Controller of Her Majesty's Stationery Office © Crown copyright. Unauthorised reproduction infringes Crown copyright and may lead to prosecution or civil proceedings. Highways England 100030649 2019

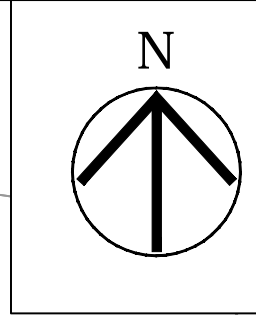

- NOTES
1. ALL DIMENSIONS IN METRES UNLESS STATED OTHERWISE.
 2. DO NOT SCALE FROM THIS DRAWING, USE ONLY PRINTED DIMENSIONS.
 3. THE PROPOSED WORKS SHOWN ARE ILLUSTRATIVE ONLY AND WILL BE SUBJECT TO CHANGE AS PART OF DETAILED DESIGN DEVELOPMENT. ANY CHANGES WILL BE LIMITED TO BEING WITHIN THE ORDER LIMITS AND ANY OTHER CONSTRAINTS INCLUDED IN THE DEVELOPMENT CONSENT ORDER.
 4. THIS DRAWING IS TO BE READ IN CONJUNCTION WITH ALL OTHER PLANS AND DOCUMENTATION, IN PARTICULAR SCHEDULE 3 OF THE DEVELOPMENT CONSENT ORDER [TR010027/APP/3.1] AND THE GENERAL ARRANGEMENT PLANS [TR010027/APP/2.4].

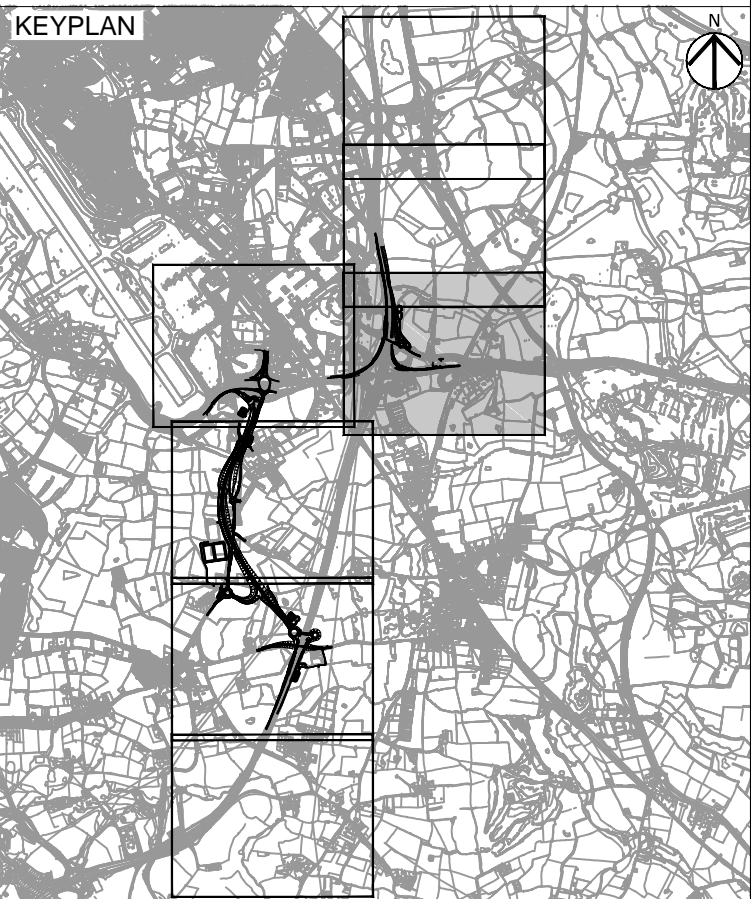
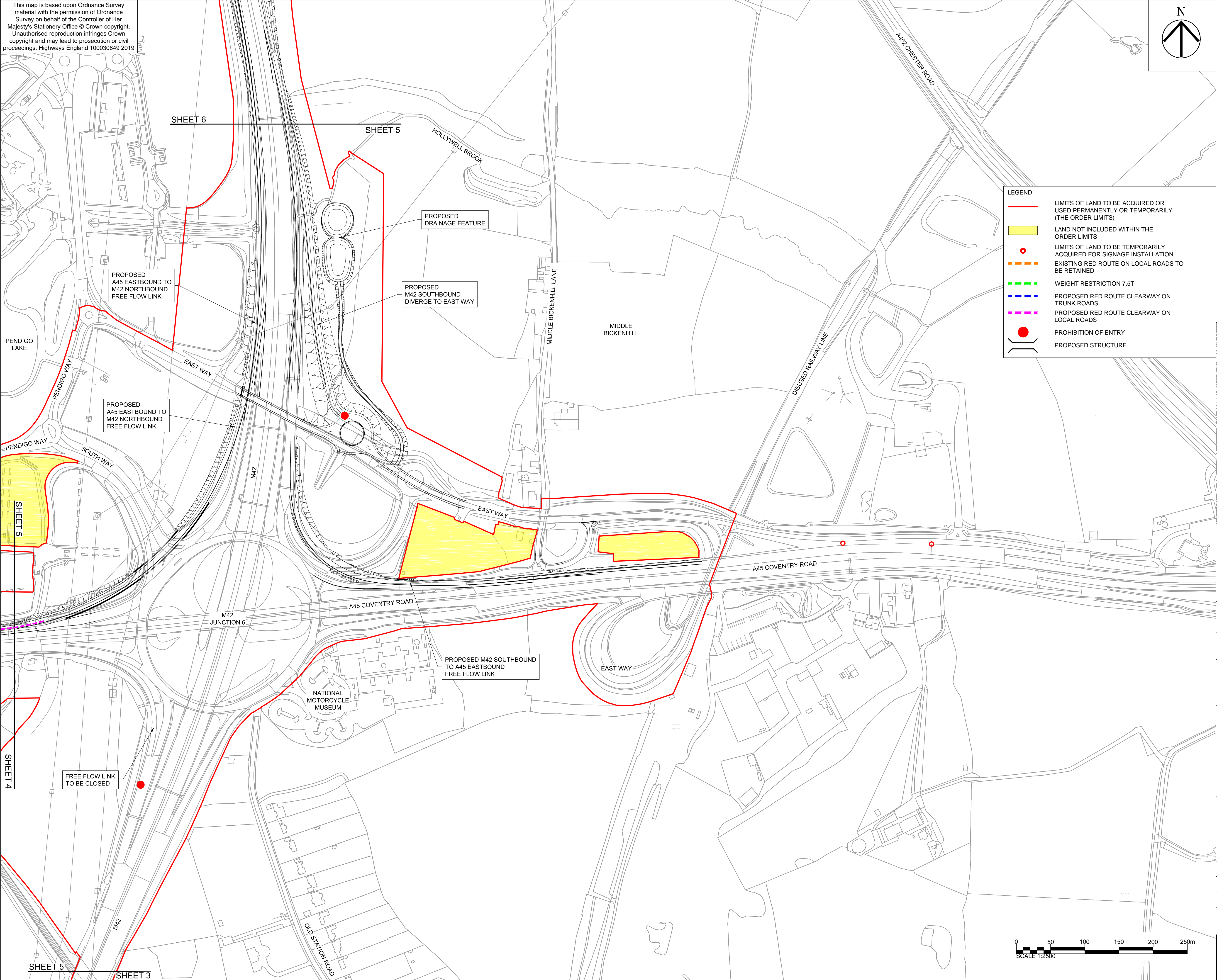

First Issue	WC	LIB	20/08/19	C01
Revised for Deadline 9	WC	PJK	14/11/19	C02
Revision Details		By	Date	Suffix
		Check		

DCO SUBMISSION

Client
Highways England
Floor 5
Two Colmore Square
38 Colmore Circus
B4 6BN



Development Consent Order Number
TR010027

Project Title
M42 JUNCTION 6 IMPROVEMENT

Drawing Title
TRAFFIC REGULATION MEASURES, REGULATION 5(2)(o) CLEARWAYS & WEIGHT LIMITS SHEET 5 OF 7

Designed CW	Drawn WC	Checked JCH	Approved PJK	Date 14/11/19
Internal Project No. 60543032		Suitability D7		
Scale @ A1 1:2500		Zone Scheme Wide General		

THIS DOCUMENT HAS BEEN PREPARED PURSUANT TO AND SUBJECT TO THE TERMS OF AECOM'S APPOINTMENT BY ITS CLIENT. AECOM ACCEPTS NO LIABILITY FOR ANY USE OF THIS DOCUMENT OTHER THAN BY ITS ORIGINAL CLIENT OR FOLLOWING AECOM'S EXPRESS AGREEMENT TO SUCH USE, AND ONLY FOR THE PURPOSES FOR WHICH IT WAS PREPARED AND PROVIDED.

Drawing Number Highways England PIN HE551485	Originator -ACM	Volume -GEN-	Rev C02
Location ZZ_SW_DCO_ZZ	Type -DR-DC	Role 2605	

Plot Date: 14 November 2019 15:56:44
File Name: C:\PWORKING\GACOML\EDUANES\HE\IN\GWAY\03071827\HE551485-ACM-GEN-ZZ_SW_DCO_ZZ-DR-DC-2605

This map is based upon Ordnance Survey material with the permission of Ordnance Survey on behalf of the Controller of Her Majesty's Stationery Office © Crown copyright. Unauthorised reproduction infringes Crown copyright and may lead to prosecution or civil proceedings. Highways England 100030649 2019

SHEET 7

SHEET 6

WYEVALE
GARDEN
CENTRE

A446 STONEBRIDGE ROAD

A462 CHESTER ROAD

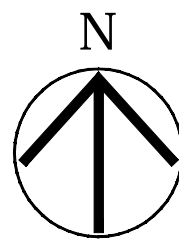

- NOTES
1. ALL DIMENSIONS IN METRES UNLESS STATED OTHERWISE.
 2. DO NOT SCALE FROM THIS DRAWING, USE ONLY PRINTED DIMENSIONS.
 3. THE PROPOSED WORKS SHOWN ARE ILLUSTRATIVE ONLY AND WILL BE SUBJECT TO CHANGE AS PART OF DETAILED DESIGN DEVELOPMENT. ANY CHANGES WILL BE LIMITED TO BEING WITHIN THE ORDER LIMITS AND ANY OTHER CONSTRAINTS INCLUDED IN THE DEVELOPMENT CONSENT ORDER.
 4. THIS DRAWING IS TO BE READ IN CONJUNCTION WITH ALL OTHER PLANS AND DOCUMENTATION, IN PARTICULAR SCHEDULE 3 OF THE DEVELOPMENT CONSENT ORDER [TR010027/APP/3.1] AND THE GENERAL ARRANGEMENT PLANS [TR010027/APP/2.4].

- LEGEND
- LIMITS OF LAND TO BE ACQUIRED OR USED PERMANENTLY OR TEMPORARILY (THE ORDER LIMITS)
 - LAND NOT INCLUDED WITHIN THE ORDER LIMITS
 - LIMITS OF LAND TO BE TEMPORARILY ACQUIRED FOR SIGNAGE INSTALLATION
 - EXISTING RED ROUTE ON LOCAL ROADS TO BE RETAINED
 - WEIGHT RESTRICTION 7.5T
 - PROPOSED RED ROUTE CLEARWAY ON TRUNK ROADS
 - PROPOSED RED ROUTE CLEARWAY ON LOCAL ROADS
 - PROHIBITION OF ENTRY
 - PROPOSED STRUCTURE

SHEET NOT USED AS PART OF
THIS DRAWING SERIES

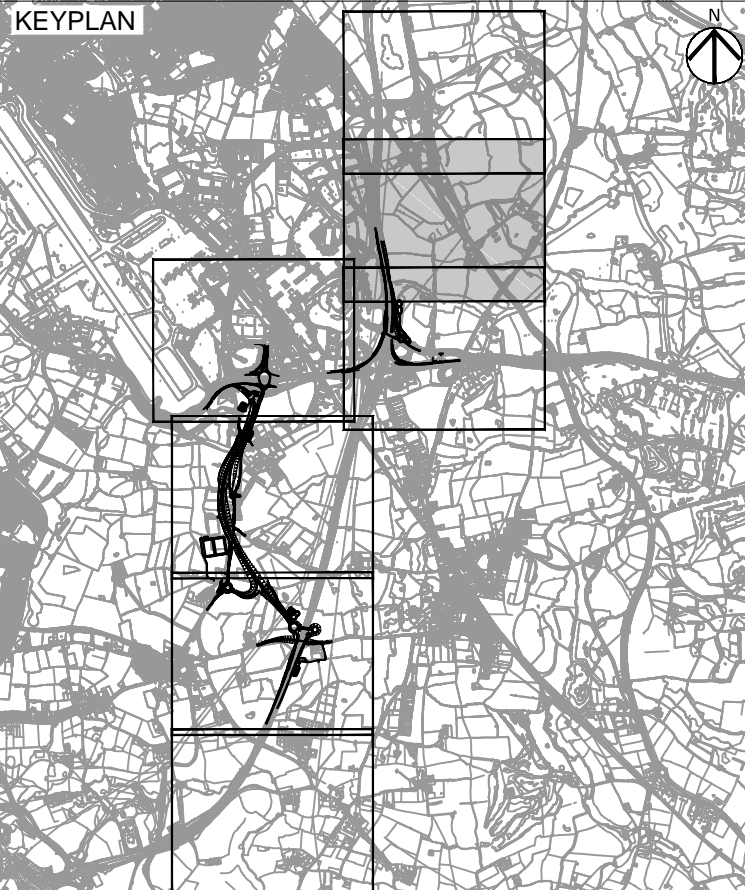

First Issue	WC	LIB	20/08/19	C01
Revised for Deadline 9	WC	PJK	14/11/19	C02
Revision Details	By	Check	Date	Suffix

Purpose of issue
DCO SUBMISSION

Client
Highways England
Floor 5
Two Colmore Square
38 Colmore Circus
B4 6BN

Development Consent Order Number
TR010027

Project Title
**M42 JUNCTION 6
IMPROVEMENT**

Drawing Title
**TRAFFIC REGULATION MEASURES, REGULATION 5(2)(o)
CLEARWAYS & WEIGHT
LIMITS SHEET 6 OF 7**

Designed CW	Drawn WC	Checked JCH	Approved PJK	Date 14/11/19
Internal Project No. 60543032		Suitability D7		
Scale @ A1 1:2500		Zone Scheme Wide General		

THIS DOCUMENT HAS BEEN PREPARED PURSUANT TO AND SUBJECT TO THE TERMS OF AECOM'S APPOINTMENT BY ITS CLIENT. AECOM ACCEPTS NO LIABILITY FOR ANY USE OF THIS DOCUMENT OTHER THAN BY ITS ORIGINAL CLIENT OR FOLLOWING AECOM'S EXPRESS AGREEMENT TO SUCH USE, AND ONLY FOR THE PURPOSES FOR WHICH IT WAS PREPARED AND PROVIDED.

Drawing Number Highways England PIN HE551485	Originator -ACM	Volume -GEN -	Rev C02
Location ZZ SW_DCO_ZZ	I Type -DR-DC	I Role 2606	I Number



This map is based upon Ordnance Survey material with the permission of Ordnance Survey on behalf of the Controller of Her Majesty's Stationery Office © Crown copyright. Unauthorised reproduction infringes Crown copyright and may lead to prosecution or civil proceedings. Highways England 100030649 2019

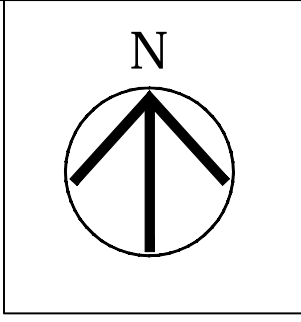

- NOTES
1. ALL DIMENSIONS IN METRES UNLESS STATED OTHERWISE.
 2. DO NOT SCALE FROM THIS DRAWING. USE ONLY PRINTED DIMENSIONS.
 3. THE PROPOSED WORKS SHOWN ARE ILLUSTRATIVE ONLY AND WILL BE SUBJECT TO CHANGE AS PART OF DETAILED DESIGN DEVELOPMENT. ANY CHANGES WILL BE LIMITED TO BEING WITHIN THE ORDER LIMITS AND ANY OTHER CONSTRAINTS INCLUDED IN THE DEVELOPMENT CONSENT ORDER.
 4. THIS DRAWING IS TO BE READ IN CONJUNCTION WITH ALL OTHER PLANS AND DOCUMENTATION, IN PARTICULAR SCHEDULE 3 OF THE DEVELOPMENT CONSENT ORDER [TR010027/APP/3.1] AND THE GENERAL ARRANGEMENT PLANS [TR010027/APP/2.4].

- LEGEND
- LIMITS OF LAND TO BE ACQUIRED OR USED PERMANENTLY OR TEMPORARILY (THE ORDER LIMITS)
 - LAND NOT INCLUDED WITHIN THE ORDER LIMITS
 - LIMITS OF LAND TO BE TEMPORARILY ACQUIRED FOR SIGNAGE INSTALLATION
 - EXISTING RED ROUTE ON LOCAL ROADS TO BE RETAINED
 - WEIGHT RESTRICTION 7.5T
 - PROPOSED RED ROUTE CLEARWAY ON TRUNK ROADS
 - PROPOSED RED ROUTE CLEARWAY ON LOCAL ROADS
 - PROHIBITION OF ENTRY
 - PROPOSED STRUCTURE

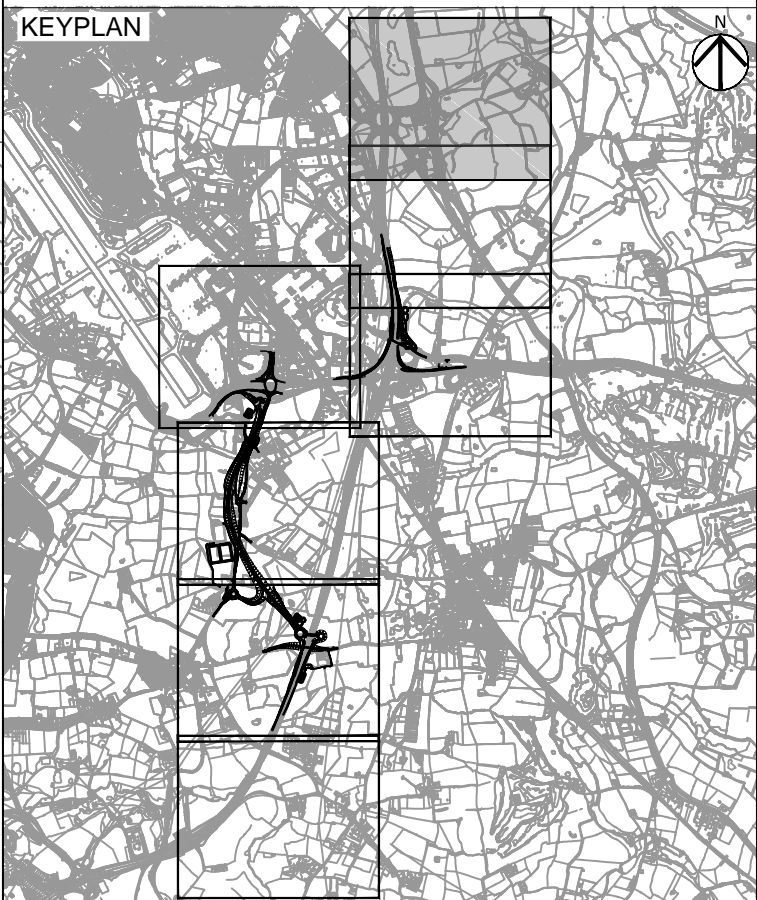

SHEET NOT USED AS PART OF
THIS DRAWING SERIES

First Issue	WC	LIB	20/08/19	C01
Revised for Deadline 9	WC	PJK	14/11/19	C02
Revision Details	By	Check	Date	Suffix

Purpose of issue
DCO SUBMISSION

Client
Highways England
Floor 5
Two Colmore Square
38 Colmore Circus
B4 6BN



Development Consent Order Number
TR010027

Project Title
M42 JUNCTION 6 IMPROVEMENT

Drawing Title
TRAFFIC REGULATION MEASURES, REGULATION 5(2)(o) CLEARWAYS & WEIGHT LIMITS SHEET 7 OF 7

Designed CW	Drawn WC	Checked JCH	Approved PJK	Date 14/11/19
Internal Project No. 60543032		Suitability D7		
Scale @ A1 1:2500		Zone Scheme Wide General		

THIS DOCUMENT HAS BEEN PREPARED PURSUANT TO AND SUBJECT TO THE TERMS OF AECOM'S APPOINTMENT BY ITS CLIENT. AECOM ACCEPTS NO LIABILITY FOR ANY USE OF THIS DOCUMENT OTHER THAN BY ITS ORIGINAL CLIENT OR FOLLOWING AECOM'S EXPRESS AGREEMENT TO SUCH USE, AND ONLY FOR THE PURPOSES FOR WHICH IT WAS PREPARED AND PROVIDED.

Drawing Number Highways England PIN HE551485	Originator -ACM	Volume -GEN -	Rev C02
Location ZZ SW_DCO_ZZ		Type -DR-DC-2607	

