

A47 Wansford to Sutton Dualling

Scheme Number: TR010039

Volume 2 **2.2 Land Plans**

APFP Regulation 5(2)(i)

Planning Act 2008

Infrastructure Planning (Applications: Prescribed
Forms and Procedure) Regulations 2009

April 2022

Deadline 5

Infrastructure Planning

Planning Act 2008

The Infrastructure Planning (Applications: Prescribed Forms and Procedure) Regulations 2009

The A47 Wansford to Sutton Development Consent Order 202[x]

2.2 LAND PLANS

| | |
|---|--|
| Regulation Number: | Regulation 5(2)(i) |
| Planning Inspectorate Scheme Reference | TR010039 |
| Application Document Reference | TR010039/APP/2.2 |
| Author: | A47 Wansford to Sutton Project Team, National Highways |

| Version | Date | Status of Version |
|----------------|---------------|-------------------------------|
| Rev 0 | June 2021 | Application Issue |
| Rev 1 | August 2021 | Updated following PINS advice |
| Rev 2 | February 2022 | Deadline 2 |
| Rev 3 | April 2022 | Deadline 5 |

CONTENTS

| | | |
|-----|--|----------|
| 1 | INTRODUCTION..... | 1 |
| 1.1 | Purpose of this Document..... | 1 |
| 2 | SCHEDULE OF PLANS INCLUDED IN THIS APPLICATION DOCUMENT | 2 |

1 INTRODUCTION

1.1 Purpose of this Document

- 1.1.1 These Land Plans (these “Plans”) relate to an application made by Highways England (the “Applicant”) to the Secretary of State for Transport via the Planning Inspectorate (the “Inspectorate”) under the Planning Act 2008 (the “2008 Act”) for a Development Consent Order (DCO). If made, the DCO would grant consent for the A47 Wansford to Sutton Scheme (the “Scheme”).
- 1.1.2 The Scheme comprises the alteration of an existing highway by way of an upgrade to an existing 2.5km of single carriageway between Wansford and Sutton. It will include building a new dual carriageway, partly to the north and also to the south of the existing A47 plus a free flow link from the A1 southbound’ improving traffic flow and reducing congestion on the route. A detailed description of the Scheme can be found in Chapter 2: The Proposed Scheme of the Environmental Statement (ES) (**TR010039/APP/6.1**). These Plans cover the Scheme in its entirety.
- 1.1.3 These Plans comprise part of the suite of application documentation and are included in the application in compliance with Regulation 5(2)(i) of the Infrastructure Planning (Applications: Prescribed Forms and Procedure) Regulations 2009 (the “2009 Regulations”), which requires:
- “5(2)(i) a land plan identifying: -*
- i. the land required for, or affected by, the proposed development;*
 - ii. where applicable, any land over which it is proposed to exercise powers of compulsory acquisition or any rights to use land;*
 - iii. any land in relation to which it is proposed to extinguish easements, servitudes and other private rights; and*
 - iv. where the land includes special category land and replacement land, that special category land and replacement land.”*
- 1.1.4 These Plans contain a key plan in order to comply with Regulation 5(4) of the 2009 Regulations which states:
- “Where a plan comprises three or more separate sheets a key plan must be provided showing the relationship between the different sheets.”*
- 1.1.5 As these Plans are part of the application documentation, they should be read alongside and are informed by the other application documents. In particular, these Plans should be read alongside Schedule 1 of the draft DCO (**TR010039/APP/3.1**), the Statement of Reasons (**TR010039/APP/4.1**) and the Book of Reference (**TR010039/APP/4.3**).

2 SCHEDULE OF PLANS INCLUDED IN THIS APPLICATION DOCUMENT

| Drawing Title | DCO Document Number | Drawing Number | Revision |
|--|---------------------------|----------------------------------|----------|
| Land Plans – Regulation 5(2)(i) Key Plan | TR010039/APP/2.2 Rev 2 | HE551494-GTY-LLO-000-DR-BL-30000 | P02 |
| Land Plans – Regulation 5(2)(i) Sheet 1 of 7 | TR010039/APP/2.2(a) Rev 2 | HE551494-GTY-LLO-000-DR-BL-30001 | P04 |
| Land Plans – Regulation 5(2)(i) Sheet 2 of 7 | TR010039/APP/2.2(b) Rev 2 | HE551494-GTY-LLO-000-DR-BL-30002 | P02 |
| Land Plans – Regulation 5(2)(i) Sheet 3 of 7 | TR010039/APP/2.2(c) Rev 2 | HE551494-GTY-LLO-000-DR-BL-30003 | P02 |
| Land Plans – Regulation 5(2)(i) Sheet 4 of 7 | TR010039/APP/2.2(d) Rev 2 | HE551494-GTY-LLO-000-DR-BL-30004 | P02 |
| Land Plans – Regulation 5(2)(i) Sheet 5 of 7 | TR010039/APP/2.2(e) Rev 2 | HE551494-GTY-LLO-000-DR-BL-30005 | P02 |
| Land Plans – Regulation 5(2)(i) Sheet 6 of 7 | TR010039/APP/2.2(f) Rev 2 | HE551494-GTY-LLO-000-DR-BL-30006 | P02 |
| Land Plans – Regulation 5(2)(i) Sheet 7 of 7 | TR010039/APP/2.2(g) Rev 2 | HE551494-GTY-LLO-000-DR-BL-30007 | P02 |

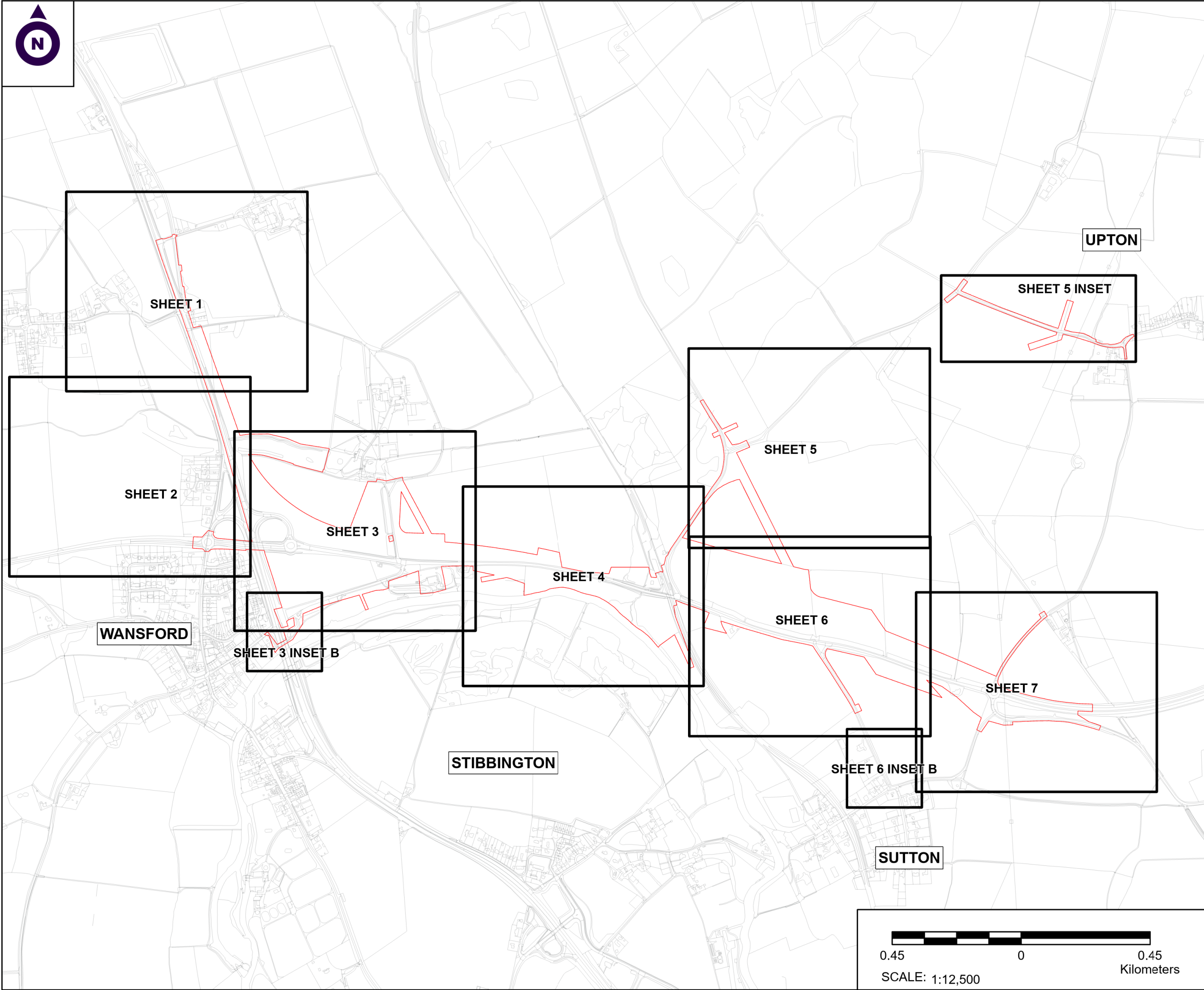

NOTES

1. ALL DIMENSIONS ARE IN METRES UNLESS STATED OTHERWISE.

2. EACH PLOT SHOWN ON THE LAND PLANS IS SHOWN ON A SINGLE SHEET AND NO PLOT STRADDLES TWO OR MORE SHEETS. WHERE A PLOT MEETS A CUT LINE, THAT CUT LINE IS CO-EXTENSIVE WITH PLOT BOUNDARY.

3. DO NOT SCALE FROM THIS DRAWING, USE ONLY PRINTED DIMENSIONS.

4. ALL EASEMENTS, SERVITUDES AND PRIVATE RIGHTS ARE PROPOSED TO BE EXTINGUISHED ON LAND THAT IS TO BE ACQUIRED, UNLESS STATED OTHERWISE IN THE BOOK OF REFERENCE

5. THIS DRAWING IS TO BE READ IN CONJUNCTION WITH ALL OTHER PLANS AND DOCUMENTATION, IN PARTICULAR THE WORKS PLANS AND THE BOOK OF REFERENCE.

LEGEND

- ORDER LIMITS
- PLOT REFERENCE NUMBER (REFER TO BOOK OF REFERENCE FOR FURTHER INFORMATION)
- EXISTING PUBLIC RIGHT OF WAY
- PARISH BOUNDARY

| | | | | |
|------------------|--------|-------|------------|--------|
| First Issue | By JJF | JF | 16/04/2021 | PO1 |
| Second Issue | By MW | JF | 11/08/2021 | PO2 |
| Revision Details | By | Check | Date | Suffix |

Purpose of issue

DCO APPLICATION

Client

Highways England

Development Consent Order Number:

TR010039

Project Title:

A47 WANSFORD TO SUTTON

Development Consent Order Drawing Number:

TR010039/APP/2.2

Drawing Title:

LAND PLANS
REGULATION 5(2)(i)
KEY PLAN

| | | | |
|----------|-------|---------|------------|
| Designed | Drawn | Checked | Date |
| -- | JJF | JF | 08/06/2021 |

| | |
|--------------------------|-------------|
| Internal Project Number: | Suitability |
| J0031921-21-00b | -- |

| | |
|------------|------------|
| Scale @ A3 | Zone |
| 1:12,500 | Whole Site |

THIS DOCUMENT HAS BEEN PREPARED PURSUANT TO AND SUBJECT TO THE TERMS OF CARTER JONAS' APPOINTMENT BY ITS CLIENT. CARTER JONAS ACCEPTS NO LIABILITY FOR ANY USE OF THIS DOCUMENT OTHER THAN BY ITS ORIGINAL CLIENT OR FOLLOWING CARTER JONAS' EXPRESS AGREEMENT TO SUCH USE, AND ONLY FOR THE PURPOSES FOR WHICH IT WAS PREPARED AND PROVIDED

| | |
|--------------------------------------|-----|
| Drawing Number | Rev |
| Highways England PIN | |
| HE551494- GTY-LLO-000-DR-BL-30000 | P02 |
| Location | |

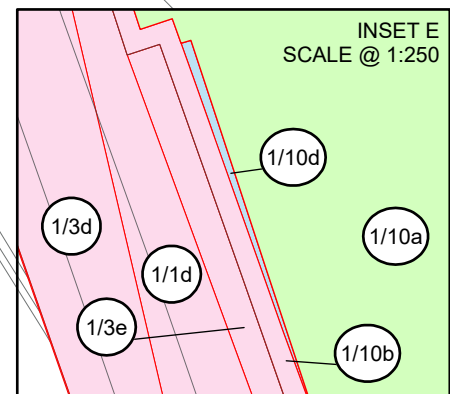

Pond

SHEET 2

SHEET 1

100

0

Meters

SCALE: 1:2,500

NOTES

1. ALL DIMENSIONS ARE IN METRES UNLESS STATED OTHERWISE.

2. EACH PLOT SHOWN ON THE LAND PLANS IS SHOWN ON A SINGLE SHEET AND NO PLOT STRADDLES TWO OR MORE SHEETS. WHERE A PLOT MEETS A CUT LINE, THAT CUT LINE IS CO-EXTENSIVE WITH PLOT BOUNDARY.

3. ALL EASEMENTS, SERVITUDES AND PRIVATE RIGHTS ARE PROPOSED TO BE EXTINGUISHED ON LAND COLOURED PINK ON THESE LAND PLANS UNLESS STATED OTHERWISE IN THE BOOK OF REFERENCE. ALL EASEMENTS, SERVITUDES AND PRIVATE RIGHTS ARE PROPOSED TO BE EXTINGUISHED, HOWEVER, THEIR COLOURS ARE NOT TO BE EXERCISED INCONSISTENT WITH THE EXERCISE OF THE RIGHTS AND RESTRICTIONS PROPOSED TO BE ACQUIRED BY THE UNDERTAKER ON LAND COLOURED BLUE ON THESE LAND PLANS UNLESS STATED OTHERWISE IN THE BOOK OF REFERENCE. ALL EASEMENTS, SERVITUDES AND PRIVATE RIGHTS ARE PROPOSED TO BE EXTINGUISHED, HOWEVER, THEIR COLOURS ARE NOT TO BE EXERCISED IN POSSESSION OF THE LAND COLOURED GREEN ON THESE LAND PLANS UNLESS STATED OTHERWISE IN THE BOOK OF REFERENCE.

4. THIS DRAWING IS TO BE READ IN CONJUNCTION WITH ALL OTHER PLANS AND DOCUMENTATION, IN PARTICULAR THE WORKS PLANS AND THE BOOK OF REFERENCE.

LEGEND

— ORDER LIMITS

1/1 PLOT REFERENCE NUMBER (REFER TO BOOK OF REFERENCE FOR FURTHER INFORMATION)

— EXISTING OR ALLEGED PUBLIC RIGHT OF WAY

 PARISH BOUNDARY
 LAND TO BE ACQUIRED PERMANENTLY

LAND TO BE USED TEMPORARILY

☐ LAND TO BE USED TEMPORARILY AND RIGHTS TO BE ACQUIRED PERMANENTLY

| | | | |
|------------------|-----------------|------------|--------|
| First Issue | By JJH JF | 05/06/2020 | PO1 |
| Second Issue | By JJH JF | 24/09/2020 | PO2 |
| Third Issue | By JJF JF | 16/04/2021 | PO3 |
| Fourth Issue | By MW JF | 07/04/2022 | PO4 |
| Revision Details | By Check | Date | Suffix |

| |
|------------------|
| Purpose of issue |
|------------------|

Issue DCO APPLICATION

Client
Highways England



Development Consent Order Number:

TR010039

Project Title:

A47 WANSFORD TO
SUTTON

Development Consent Order Drawing Number:

TR010039/APP/2.2(a)

Drawing Title:

LAND PLANS
REGULATION 5(2)(i)
SHEET 1 OF 7

| | | | |
|---|--------------|-------------------------------|--------------------|
| Designed -- | Drawn JJF | Checked JF | Date 07/04/2022 |
| Internal Project Number: J0028671-21-02d | | Suitability DCO Submission | |
| Scale @ A3 1:2,500 | | Zone Whole Site | |

THIS DOCUMENT HAS BEEN PREPARED PURSUANT TO AND
SUBJECT TO THE TERMS OF CARTER JONAS' APPOINTMENT BY ITS
CLIENT. CARTER JONAS ACCEPTS NO LIABILITY FOR ANY USE OF THIS
DOCUMENT OTHER THAN BY ITS ORIGINAL CLIENT OR FOLLOWING
CARTER JONAS' EXPRESS AGREEMENT TO SUCH USE,
AND ONLY FOR THE PURPOSES FOR WHICH IT WAS PREPARED
AND PROVIDED

Drawing Number
Highways England PIN
HE551492-
GTY-LLO-000-DR-BL-30001

| | |
|-----|--|
| Rev | |
| P04 | |



CITY OF PETERBOROUGH
PARISH OF THORNHAUGH

SHEET 2

SHEET 1



CITY OF PETERBOROUGH
PARISH OF WANSFORD

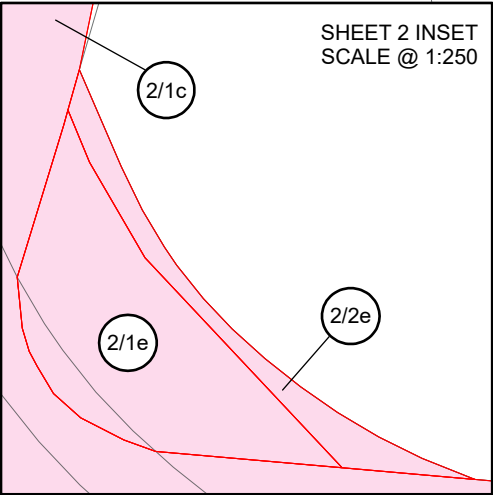

- NOTES
1. ALL DIMENSIONS ARE IN METRES UNLESS STATED OTHERWISE.
 2. EACH PLOT SHOWN ON THE LAND PLANS IS SHOWN ON A SINGLE SHEET AND NO PLOT STRADDLES TWO OR MORE SHEETS. WHERE A PLOT MEETS A CUT LINE, THAT CUT LINE IS CO-EXTENSIVE WITH PLOT BOUNDARY.
 3. ALL EASEMENTS, SERVITUDES AND PRIVATE RIGHTS ARE PROPOSED TO BE EXTINGUISHED ON LAND, COLOURED PINK ON THESE LAND PLANS UNLESS STATED OTHERWISE IN THE BOOK OF REFERENCE. ALL EASEMENTS, SERVITUDES AND PRIVATE RIGHTS ARE PROPOSED TO BE EXTINGUISHED, SO FAR AS THEIR CONTINUED EXERCISE WOULD BE INCONSISTENT WITH THE EXERCISE OF THE RIGHTS AND RESTRICTIONS PROPOSED TO BE ACQUIRED BY THE UNDERTAKER ON LAND COLOURED BLUE ON THESE LAND PLANS UNLESS STATED OTHERWISE IN THE BOOK OF REFERENCE. ALL EASEMENTS, SERVITUDES AND PRIVATE RIGHTS ARE PROPOSED TO BE SUSPENDED WHILE THE UNDERTAKER IS IN TEMPORARY POSSESSION OF THE LAND COLOURED GREEN ON THESE LAND PLANS UNLESS STATED OTHERWISE IN THE BOOK OF REFERENCE.
 4. THIS DRAWING IS TO BE READ IN CONJUNCTION WITH ALL OTHER PLANS AND DOCUMENTATION, IN PARTICULAR THE WORKS PLANS AND THE BOOK OF REFERENCE.

- LEGEND
- ORDER LIMITS
 - PLOT REFERENCE NUMBER (REFER TO BOOK OF REFERENCE FOR FURTHER INFORMATION)
 - EXISTING PUBLIC RIGHT OF WAY
 - PARISH BOUNDARY
 - LAND TO BE ACQUIRED PERMANENTLY
 - LAND TO BE USED TEMPORARILY
 - LAND TO BE USED TEMPORARILY AND RIGHTS TO BE ACQUIRED PERMANENTLY

| | | | | |
|------------------|-----------|-------|------------|--------|
| First Issue | By JJF | JF | 16/04/2021 | PO1 |
| Second Issue | By MW | JF | 07/04/2022 | PO2 |
| Revision Details | By | Check | Date | Suffix |

Purpose of issue
DCO APPLICATION

Client
Highways England

Development Consent Order Number:
TR010039

Project Title:
A47 WANSFORD
TO SUTTON

Development Consent Order Drawing Number:
TR010039/APP/2.2(b)

Drawing Title:
LAND PLANS
REGULATION 5(2)(i)
SHEET 2 OF 7

| | | | |
|---|--------------|-------------------------------|--------------------|
| Designed -- | Drawn JJF | Checked JF | Date 07/04/2022 |
| Internal Project Number: J0031921-21-02b | | Suitability DCO Submission | |
| Scale @ A3 1:2,500 | | Zone Whole Site | |

THIS DOCUMENT HAS BEEN PREPARED PURSUANT TO AND SUBJECT TO THE TERMS OF CARTER JONAS' APPOINTMENT BY ITS CLIENT. CARTER JONAS ACCEPTS NO LIABILITY FOR ANY USE OF THIS DOCUMENT OTHER THAN BY ITS ORIGINAL CLIENT OR FOLLOWING CARTER JONAS' EXPRESS AGREEMENT TO SUCH USE, AND ONLY FOR THE PURPOSES FOR WHICH IT WAS PREPARED AND PROVIDED

| | |
|--|------------|
| Drawing Number Highways England PIN HE551494- GTU-LLO-000-DR-BL-30002 | Rev P02 |
|--|------------|

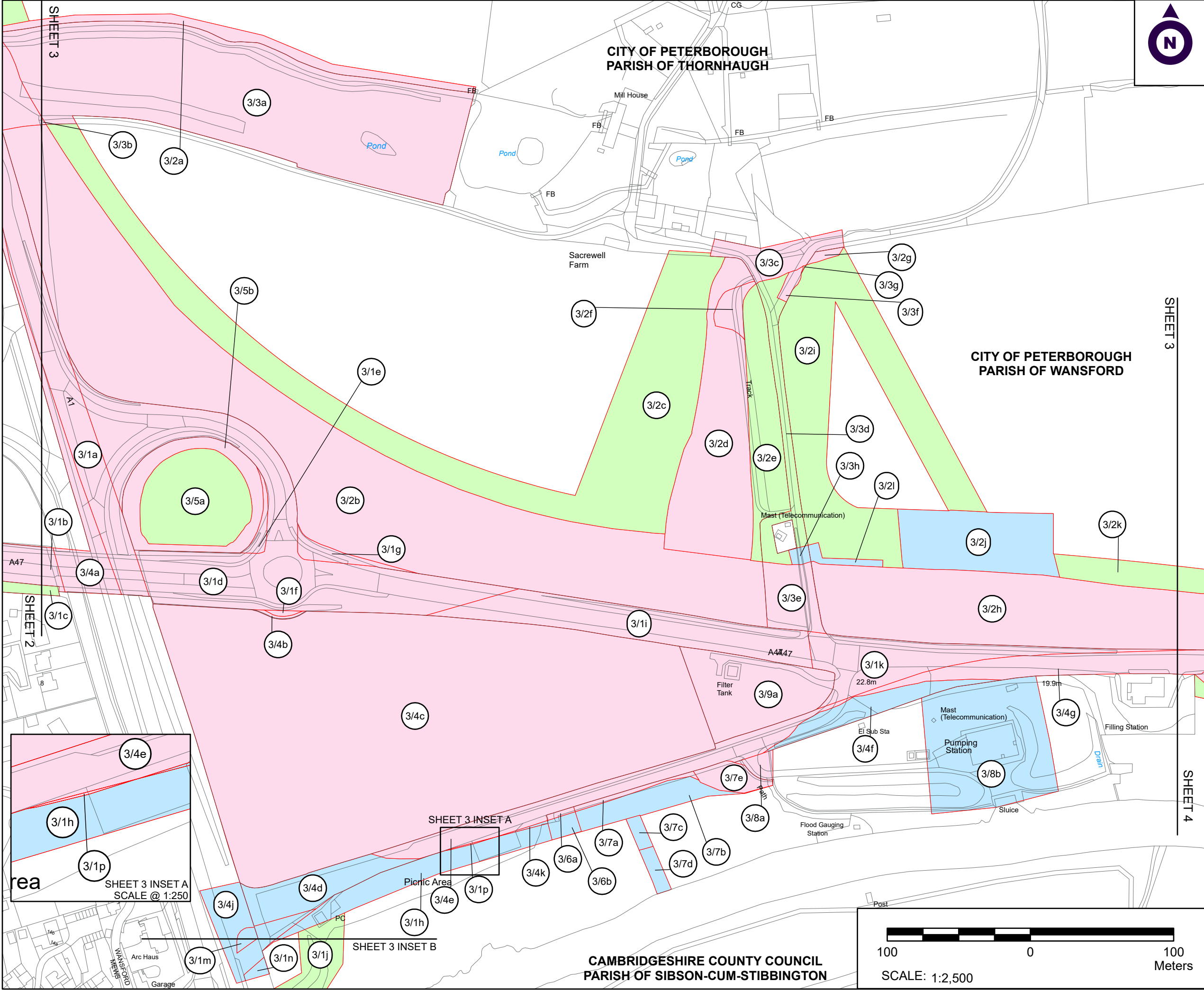

NOTES

1. ALL DIMENSIONS ARE IN METRES UNLESS STATED OTHERWISE.

2. EACH PLOT SHOWN ON THE LAND PLANS IS SHOWN ON A SINGLE SHEET AND NO PLOT STRADDLES TWO OR MORE SHEETS. WHERE A PLOT MEETS A CUT LINE, THAT CUT LINE IS CO-EXTENSIVE WITH PLOT BOUNDARY.

3. ALL EASEMENTS, SERVITUDES AND PRIVATE RIGHTS ARE PROPOSED TO BE EXTINGUISHED ON LAND, COLOURED PINK ON THESE LAND PLANS UNLESS STATED OTHERWISE IN THE BOOK OF REFERENCE. ALL EASEMENTS, SERVITUDES AND PRIVATE RIGHTS ARE PROPOSED TO BE EXTINGUISHED, SO FAR AS THEIR CONTINUED EXERCISE WOULD BE INCONSISTENT WITH THE EXERCISE OF THE RIGHTS AND RESTRICTIONS PROPOSED TO BE ACQUIRED BY THE UNDERTAKER ON LAND COLOURED BLUE ON THESE LAND PLANS UNLESS STATED OTHERWISE IN THE BOOK OF REFERENCE. ALL EASEMENTS, SERVITUDES AND PRIVATE RIGHTS ARE PROPOSED TO BE SUSPENDED WHILE THE UNDERTAKER IS IN TEMPORARY POSSESSION OF THE LAND COLOURED GREEN ON THESE LAND PLANS UNLESS STATED OTHERWISE IN THE BOOK OF REFERENCE.

4. THIS DRAWING IS TO BE READ IN CONJUNCTION WITH ALL OTHER PLANS AND DOCUMENTATION, IN PARTICULAR THE WORKS PLANS AND THE BOOK OF REFERENCE.

LEGEND

- ORDER LIMITS
- PLOT REFERENCE NUMBER (REFER TO BOOK OF REFERENCE FOR FURTHER INFORMATION)
- EXISTING PUBLIC RIGHT OF WAY
- PARISH BOUNDARY
- LAND TO BE ACQUIRED PERMANENTLY
- LAND TO BE USED TEMPORARILY
- LAND TO BE USED TEMPORARILY AND RIGHTS TO BE ACQUIRED PERMANENTLY

| | | | | |
|------------------|--------|-------|------------|--------|
| First Issue | By JJJ | JF | 16/04/2021 | PO1 |
| Second Issue | By MW | JF | 11/04/2022 | PO2 |
| Revision Details | By | Check | Date | Suffix |

Purpose of issue

DCO APPLICATION

Client

Highways England

Development Consent Order Number:

TR010039

Project Title:

A47 WANSFORD TO SUTTON

Development Consent Order Drawing Number:

TR010039/APP/2.2(c)

Drawing Title:

LAND PLANS
REGULATION 5(2)(i)
SHEET 3 OF 7

| | | | |
|----------|-------|---------|------------|
| Designed | Drawn | Checked | Date |
| -- | JJJ | JF | 11/04/2022 |

Internal Project Number:

J0031921-21-03b

Scale @ A3

1:2,500

Suitability

DCO Submission

Zone

Whole Site

THIS DOCUMENT HAS BEEN PREPARED PURSUANT TO AND SUBJECT TO THE TERMS OF CARTER JONAS' APPOINTMENT BY ITS CLIENT. CARTER JONAS ACCEPTS NO LIABILITY FOR ANY USE OF THIS DOCUMENT OTHER THAN BY ITS ORIGINAL CLIENT OR FOLLOWING CARTER JONAS' EXPRESS AGREEMENT TO SUCH USE, AND ONLY FOR THE PURPOSES FOR WHICH IT WAS PREPARED AND PROVIDED

Drawing Number

Highways England PIN

HE551494-
GTU-LLO-000-DR-BL-30003

Rev

P02









**CITY OF PETERBOROUGH
PARISH OF WANSFORD**

**CITY OF PETERBOROUGH
PARISH OF SUTTON**

NOTES

1. ALL DIMENSIONS ARE IN METRES UNLESS STATED OTHERWISE.
2. EACH PLOT SHOWN ON THE LAND PLANS IS SHOWN ON A SINGLE SHEET AND NO PLOT STRADDLES TWO OR MORE SHEETS. WHERE A PLOT MEETS A CUT LINE, THAT CUT LINE IS CO-EXTENSIVE WITH PLOT BOUNDARY.
3. ALL EASEMENTS, SERVITUDES AND PRIVATE RIGHTS ARE PROPOSED TO BE EXTINGUISHED ON LAND, COLOURED PINK ON THESE LAND PLANS UNLESS STATED OTHERWISE IN THE BOOK OF REFERENCE. ALL EASEMENTS, SERVITUDES AND PRIVATE RIGHTS ARE PROPOSED TO BE EXTINGUISHED, SO FAR AS THEIR CONTINUED EXERCISE WOULD BE INCONSISTENT WITH THE EXERCISE OF THE RIGHTS AND RESTRICTIONS PROPOSED TO BE ACQUIRED BY THE UNDERTAKER ON LAND COLOURED BLUE ON THESE LAND PLANS UNLESS STATED OTHERWISE IN THE BOOK OF REFERENCE. ALL EASEMENTS, SERVITUDES AND PRIVATE RIGHTS ARE PROPOSED TO BE SUSPENDED WHILE THE UNDERTAKER IS IN TEMPORARY POSSESSION OF THE LAND COLOURED GREEN ON THESE LAND PLANS UNLESS STATED OTHERWISE IN THE BOOK OF REFERENCE.
4. THIS DRAWING IS TO BE READ IN CONJUNCTION WITH ALL OTHER PLANS AND DOCUMENTATION, IN PARTICULAR THE WORKS PLANS AND THE BOOK OF REFERENCE.

LEGEND

-  ORDER LIMITS
 PLOT REFERENCE NUMBER (REFER TO BOOK OF REFERENCE FOR FURTHER INFORMATION)
 EXISTING PUBLIC RIGHT OF WAY
 PARISH BOUNDARY
 LAND TO BE ACQUIRED PERMANENTLY
 LAND TO BE USED TEMPORARILY
 LAND TO BE USED TEMPORARILY AND RIGHTS TO BE ACQUIRED PERMANENTLY

| | | | |
|------------------|--------------|------------|--------|
| First Issue | By JFJ JF | 16/04/2021 | PO1 |
| Second Issue | By MW JF | 11/08/2021 | PO2 |
| Revision Details | By Check | Date | Suffix |

| | |
|------------------|-----------------|
| Purpose of issue | DCO APPLICATION |
|------------------|-----------------|

Client
Highways England

The logo for Highways England, featuring a stylized blue and white graphic of a road or bridge structure to the left of the text "highways england" in a bold, sans-serif font.

Development Consent Order Number:
TR010039

Project Title:

**A47 WANSFORD
TO SUTTON**

Development Consent Order Drawing Number:
TR010039/APP/2.2(d)

Drawing Title:

LAND PLANS
REGULATION 5(2)(i)
SHEET 4 OF 7

| | | | |
|----------------|--------------|---------------|--------------------|
| Designed -- | Drawn JJF | Checked JF | Date 11/08/2021 |
|----------------|--------------|---------------|--------------------|

| | |
|---|-------------------------------|
| Internal Project Number: J0031921-21-04b | Suitability DCO Submission |
|---|-------------------------------|

| | |
|-----------------------|--------------------|
| Scale @ A3 1:2,500 | Zone Whole Site |
|-----------------------|--------------------|

THIS DOCUMENT HAS BEEN PREPARED PURSUANT TO AND
SUBJECT TO THE TERMS OF CARTER JONAS' APPOINTMENT BY ITS
CLIENT. CARTER JONAS ACCEPTS NO LIABILITY FOR ANY USE OF THIS
DOCUMENT OTHER THAN BY ITS ORIGINAL CLIENT OR FOLLOWING
CARTER JONAS' EXPRESS AGREEMENT TO SUCH USE,
AND ONLY FOR THE PURPOSES FOR WHICH IT WAS PREPARED
AND PROVIDED

| | |
|--|-----------------------|
| Drawing Number Highways England PIN HE551494- GTY-LLO-000-DR-BL-30004 Location | Rev P02 |
|--|-----------------------|

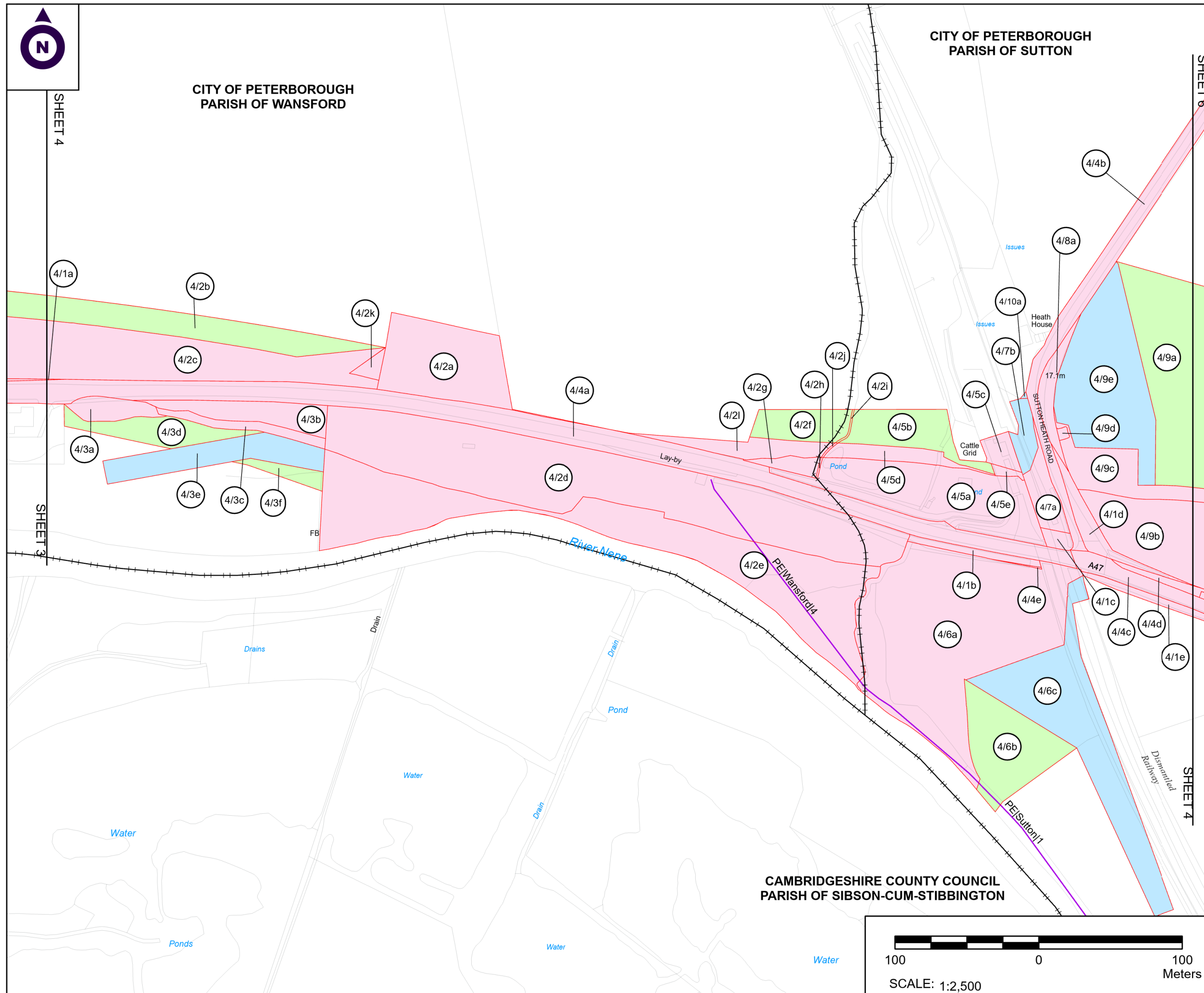

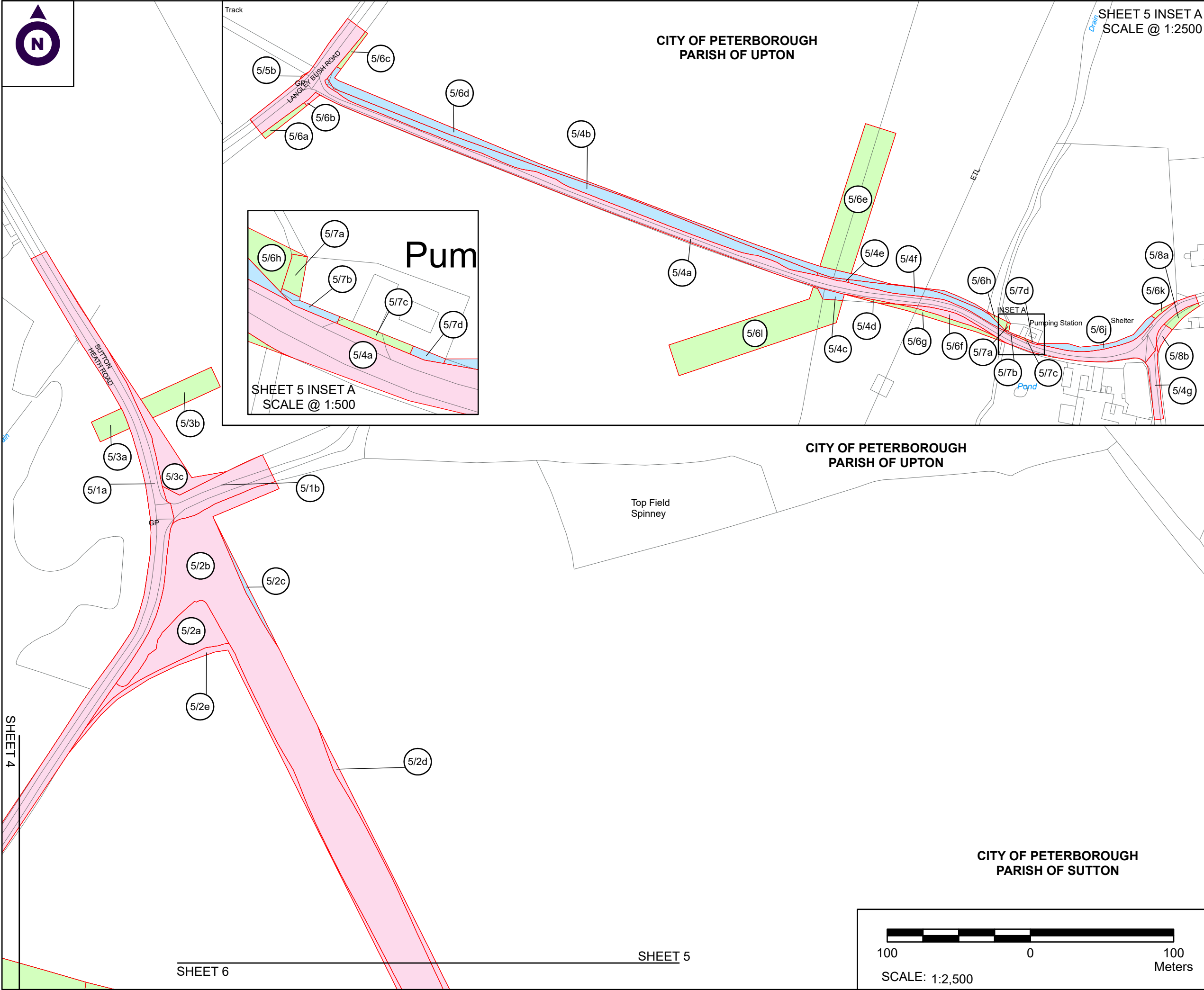

NOTES

1. ALL DIMENSIONS ARE IN METRES UNLESS STATED OTHERWISE.

2. EACH PLOT SHOWN ON THE LAND PLANS IS SHOWN ON A SINGLE SHEET AND NO PLOT STRADDLES TWO OR MORE SHEETS. WHERE A PLOT MEETS A CUT LINE, THAT CUT LINE IS CO-EXTENSIVE WITH PLOT BOUNDARY.

3. ALL EASEMENTS, SERVITUDES AND PRIVATE RIGHTS ARE PROPOSED TO BE EXTINGUISHED ON LAND, COLOURED PINK ON THESE LAND PLANS UNLESS STATED OTHERWISE IN THE BOOK OF REFERENCE. ALL EASEMENTS, SERVITUDES AND PRIVATE RIGHTS ARE PROPOSED TO BE EXTINGUISHED, SO FAR AS THEIR CONTINUED EXERCISE WOULD BE INCONSISTENT WITH THE EXERCISE OF THE RIGHTS AND RESTRICTIONS PROPOSED TO BE ACQUIRED BY THE UNDERTAKER ON LAND COLOURED BLUE ON THESE LAND PLANS UNLESS STATED OTHERWISE IN THE BOOK OF REFERENCE. ALL EASEMENTS, SERVITUDES AND PRIVATE RIGHTS ARE PROPOSED TO BE SUSPENDED WHILE THE UNDERTAKER IS IN TEMPORARY POSSESSION OF THE LAND COLOURED GREEN ON THESE LAND PLANS UNLESS STATED OTHERWISE IN THE BOOK OF REFERENCE.

4. THIS DRAWING IS TO BE READ IN CONJUNCTION WITH ALL OTHER PLANS AND DOCUMENTATION, IN PARTICULAR THE WORKS PLANS AND THE BOOK OF REFERENCE.

LEGEND

- ORDER LIMITS
- PLOT REFERENCE NUMBER (REFER TO BOOK OF REFERENCE FOR FURTHER INFORMATION)
- EXISTING PUBLIC RIGHT OF WAY
- PARISH BOUNDARY
- LAND TO BE ACQUIRED PERMANENTLY
- LAND TO BE USED TEMPORARILY
- LAND TO BE USED TEMPORARILY AND RIGHTS TO BE ACQUIRED PERMANENTLY

| | | | | |
|------------------|--------|-------|------------|--------|
| First Issue | By JJF | JF | 16/04/2021 | PO1 |
| Second Issue | By MW | JF | 11/04/2022 | PO2 |
| Revision Details | By | Check | Date | Suffix |

Purpose of issue

DCO APPLICATION

Client

Highways England

Development Consent Order Number:

TR010039

Project Title:

A47 WANSFORD TO SUTTON

Development Consent Order Drawing Number:

TR010039/APP/2.2(e)

Drawing Title:

**LAND PLANS
REGULATION 5(2)(i)
SHEET 5 OF 7**

| | | | |
|----------|-------|---------|------------|
| Designed | Drawn | Checked | Date |
| -- | JJF | JF | 11/04/2022 |

Internal Project Number:

J0031921-21-05b

Suitability

DCO Submission

Scale @ A3

1:2,500

Zone

Whole Site

THIS DOCUMENT HAS BEEN PREPARED PURSUANT TO AND SUBJECT TO THE TERMS OF CARTER JONAS' APPOINTMENT BY ITS CLIENT. CARTER JONAS ACCEPTS NO LIABILITY FOR ANY USE OF THIS DOCUMENT OTHER THAN BY ITS ORIGINAL CLIENT OR FOLLOWING CARTER JONAS' EXPRESS AGREEMENT TO SUCH USE, AND ONLY FOR THE PURPOSES FOR WHICH IT WAS PREPARED AND PROVIDED

Drawing Number

Highways England PIN

HE551494-
GTY-LLO-000-DR-BL-30005

Location

Rev

P02

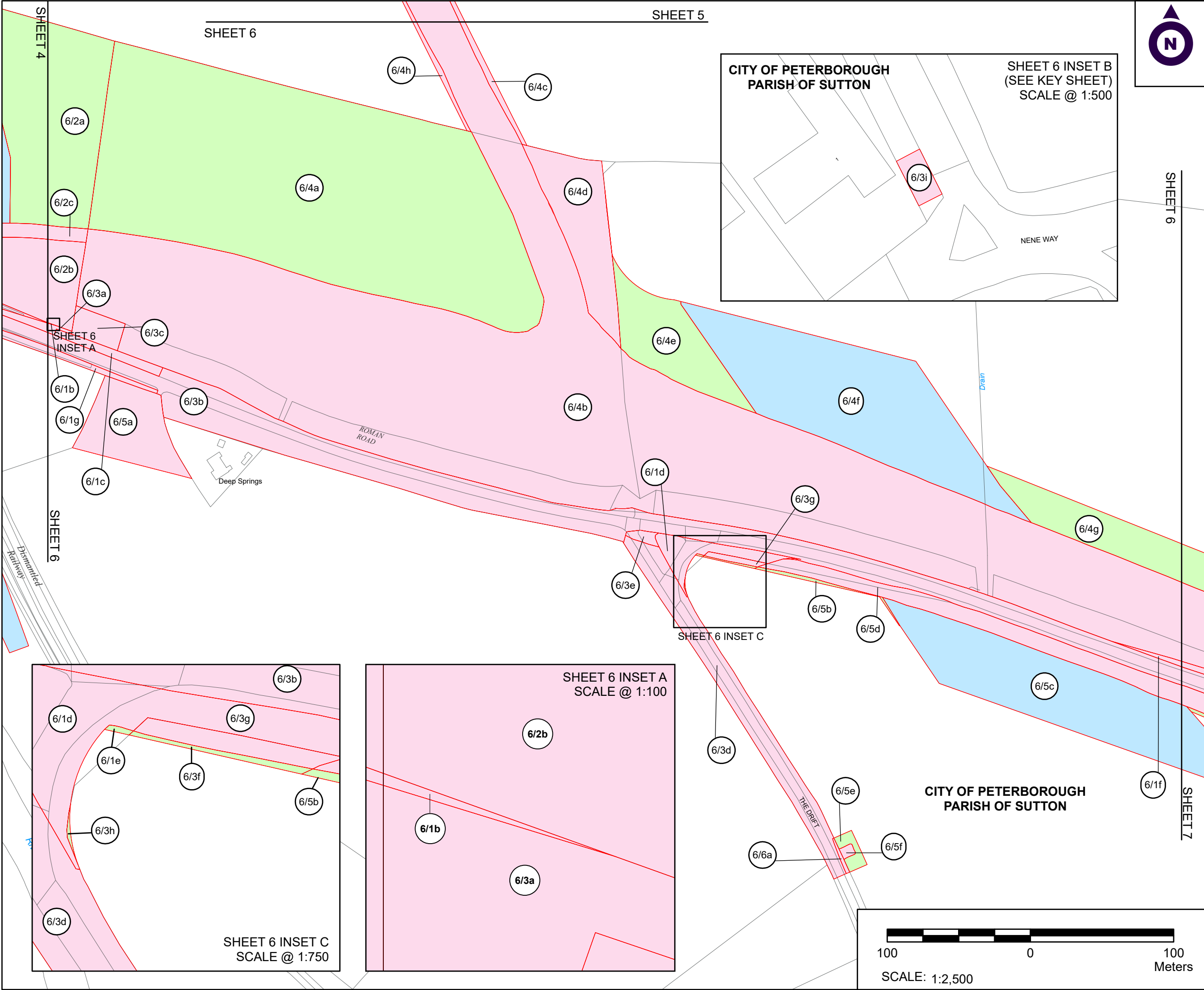

- NOTES
1. ALL DIMENSIONS ARE IN METRES UNLESS STATED OTHERWISE.
 2. EACH PLOT SHOWN ON THE LAND PLANS IS SHOWN ON A SINGLE SHEET AND NO PLOT STRADDLES TWO OR MORE SHEETS. WHERE A PLOT MEETS A CUT LINE, THAT CUT LINE IS CO-EXTENSIVE WITH PLOT BOUNDARY.
 3. ALL EASEMENTS, SERVITUDES AND PRIVATE RIGHTS ARE PROPOSED TO BE EXTINGUISHED ON LAND, COLOURED PINK ON THESE LAND PLANS UNLESS STATED OTHERWISE IN THE BOOK OF REFERENCE. ALL EASEMENTS, SERVITUDES AND PRIVATE RIGHTS ARE PROPOSED TO BE EXTINGUISHED, SO FAR AS THEIR CONTINUED EXERCISE WOULD BE INCONSISTENT WITH THE EXERCISE OF THE RIGHTS AND RESTRICTIONS PROPOSED TO BE ACQUIRED BY THE UNDERTAKER ON LAND COLOURED BLUE ON THESE LAND PLANS UNLESS STATED OTHERWISE IN THE BOOK OF REFERENCE. ALL EASEMENTS, SERVITUDES AND PRIVATE RIGHTS ARE PROPOSED TO BE SUSPENDED WHILE THE UNDERTAKER IS IN TEMPORARY POSSESSION OF THE LAND COLOURED GREEN ON THESE LAND PLANS UNLESS STATED OTHERWISE IN THE BOOK OF REFERENCE.
 4. THIS DRAWING IS TO BE READ IN CONJUNCTION WITH ALL OTHER PLANS AND DOCUMENTATION, IN PARTICULAR THE WORKS PLANS AND THE BOOK OF REFERENCE.

LEGEND

- ORDER LIMITS
- PLOT REFERENCE NUMBER (REFER TO BOOK OF REFERENCE FOR FURTHER INFORMATION)
- EXISTING PUBLIC RIGHT OF WAY
- PARISH BOUNDARY
- LAND TO BE ACQUIRED PERMANENTLY
- LAND TO BE USED TEMPORARILY
- LAND TO BE USED TEMPORARILY AND RIGHTS TO BE ACQUIRED PERMANENTLY

| | | | | |
|------------------|--------|-------|------------|--------|
| First Issue | By JJJ | JF | 16/04/2021 | PO1 |
| Second Issue | By MW | JF | 11/04/2022 | PO2 |
| Revision Details | By | Check | Date | Suffix |

Purpose of issue
DCO APPLICATION

Client
Highways England



Development Consent Order Number:
TR010039

Project Title:
A47 WANSFORD TO SUTTON

Development Consent Order Drawing Number:
TR010039/APP/2.2(f)

Drawing Title:
LAND PLANS
REGULATION 5(2)(i)
SHEET 6 OF 7

| | | | |
|---|--------------|-------------------------------|--------------------|
| Designed -- | Drawn JJF | Checked JF | Date 11/04/2022 |
| Internal Project Number: J0031921-21-06b | | Suitability DCO Submission | |
| Scale @ A3 1:2,500 | | Zone Whole Site | |

THIS DOCUMENT HAS BEEN PREPARED PURSUANT TO AND SUBJECT TO THE TERMS OF CARTER JONAS' APPOINTMENT BY ITS CLIENT. CARTER JONAS ACCEPTS NO LIABILITY FOR ANY USE OF THIS DOCUMENT OTHER THAN BY ITS ORIGINAL CLIENT OR FOLLOWING CARTER JONAS' EXPRESS AGREEMENT TO SUCH USE, AND ONLY FOR THE PURPOSES FOR WHICH IT WAS PREPARED AND PROVIDED

| | |
|--|------------|
| Drawing Number Highways England PIN HE551494- GTY-LLO-000-DR-BL-30006 | Rev P02 |
|--|------------|

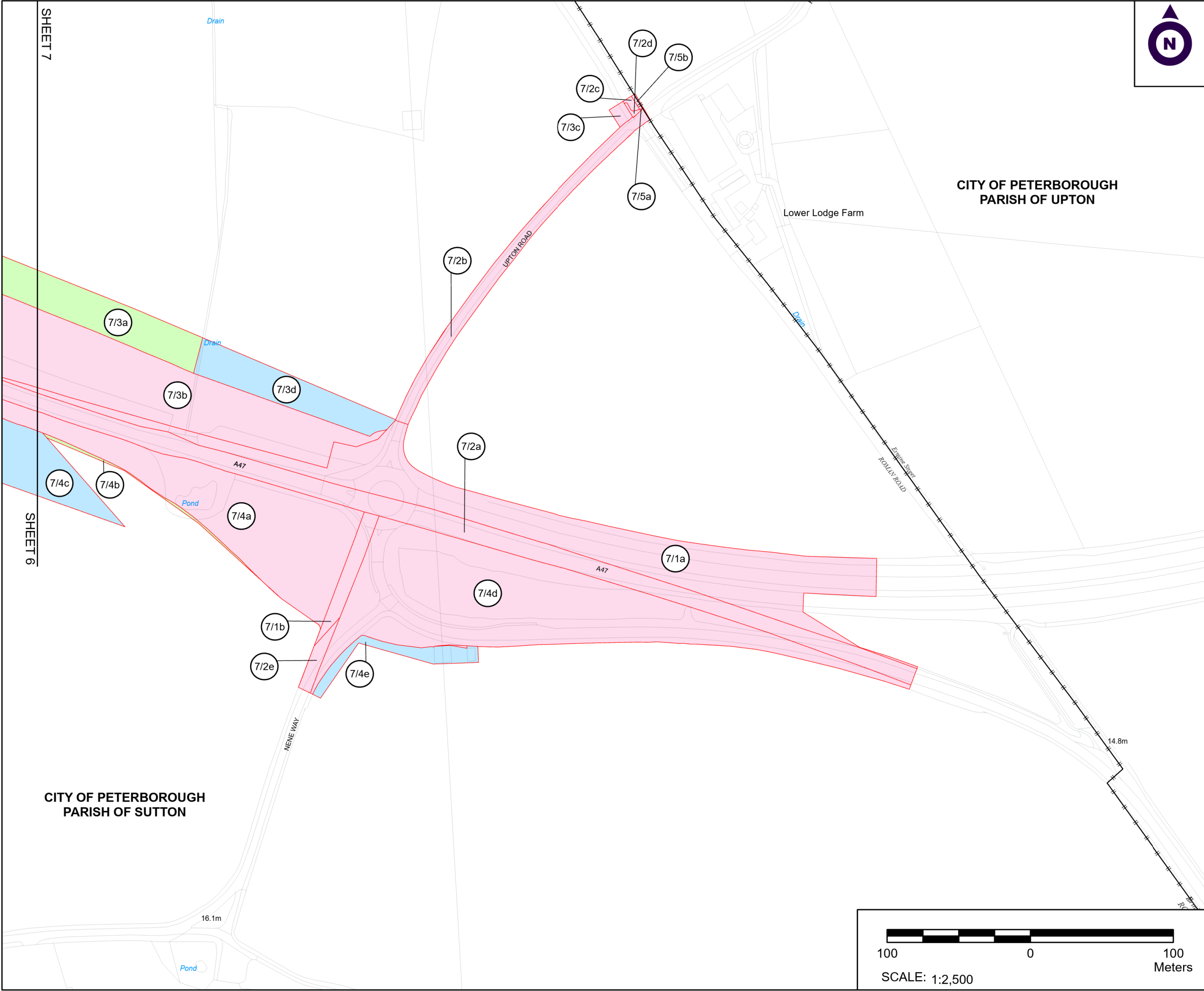

NOTES

1. ALL DIMENSIONS ARE IN METRES UNLESS STATED OTHERWISE.

2. EACH PLOT SHOWN ON THE LAND PLANS IS SHOWN ON A SINGLE SHEET AND NO PLOT STRADDLES TWO OR MORE SHEETS. WHERE A PLOT MEETS A CUT LINE, THAT CUT LINE IS CO-EXTENSIVE WITH PLOT BOUNDARY.

3. ALL EASEMENTS, SERVITUDES AND PRIVATE RIGHTS ARE PROPOSED TO BE EXTINGUISHED ON LAND, COLOURED PINK ON THESE LAND PLANS UNLESS STATED OTHERWISE IN THE BOOK OF REFERENCE. ALL EASEMENTS, SERVITUDES AND PRIVATE RIGHTS ARE PROPOSED TO BE EXTINGUISHED, SO FAR AS THEIR CONTINUED EXERCISE WOULD BE INCONSISTENT WITH THE EXERCISE OF THE RIGHTS AND RESTRICTIONS PROPOSED TO BE ACQUIRED BY THE UNDERTAKER ON LAND COLOURED BLUE ON THESE LAND PLANS UNLESS STATED OTHERWISE IN THE BOOK OF REFERENCE. ALL EASEMENTS, SERVITUDES AND PRIVATE RIGHTS ARE PROPOSED TO BE SUSPENDED WHILE THE UNDERTAKER IS IN TEMPORARY POSSESSION OF THE LAND COLOURED GREEN ON THESE LAND PLANS UNLESS STATED OTHERWISE IN THE BOOK OF REFERENCE.

4. THIS DRAWING IS TO BE READ IN CONJUNCTION WITH ALL OTHER PLANS AND DOCUMENTATION, IN PARTICULAR THE WORKS PLANS AND THE BOOK OF REFERENCE.

- LEGEND**
- ORDER LIMITS
 - PLOT REFERENCE NUMBER (REFER TO BOOK OF REFERENCE FOR FURTHER INFORMATION)
 - EXISTING PUBLIC RIGHT OF WAY
 - PARISH BOUNDARY
 - LAND TO BE ACQUIRED PERMANENTLY
 - LAND TO BE USED TEMPORARILY
 - LAND TO BE USED TEMPORARILY AND RIGHTS TO BE ACQUIRED PERMANENTLY

| | | | | |
|------------------|--------|-------|------------|--------|
| First Issue | By JJF | JF | 16/04/2021 | PO1 |
| Second Issue | By MW | JF | 11/08/2021 | PO2 |
| Revision Details | By | Check | Date | Suffix |

Purpose of issue
DCO APPLICATION

Client
Highways England

Development Consent Order Number:
TR010039

Project Title:
A47 WANSFORD TO SUTTON

Development Consent Order Drawing Number:
TR010039/APP/2.2(g)

Drawing Title:
**LAND PLANS
REGULATION 5(2)(i)
SHEET 7 OF 7**

| | | | |
|---|--------------|-------------------------------|--------------------|
| Designed -- | Drawn JJF | Checked JF | Date 11/08/2021 |
| Internal Project Number: J0031921-21-07b | | Suitability DCO Submission | |
| Scale @ A3 1:2,500 | | Zone Whole Site | |

THIS DOCUMENT HAS BEEN PREPARED PURSUANT TO AND SUBJECT TO THE TERMS OF CARTER JONAS' APPOINTMENT BY ITS CLIENT. CARTER JONAS ACCEPTS NO LIABILITY FOR ANY USE OF THIS DOCUMENT OTHER THAN BY ITS ORIGINAL CLIENT OR FOLLOWING CARTER JONAS' EXPRESS AGREEMENT TO SUCH USE, AND ONLY FOR THE PURPOSES FOR WHICH IT WAS PREPARED AND PROVIDED

| | |
|--|-------------------|
| Drawing Number Highways England PIN HE551494- GTY-LLO-000-DR-BL-30007 | Rev P02 |
|--|-------------------|

