

A428 Black Cat to Caxton Gibbet improvements

TR010044

Volume 2

2.2 Land Plans

Planning Act 2008

Regulation 5(2)(i)

Infrastructure Planning (Applications: Prescribed Forms and
Procedure) Regulations 2009

26 February 2021

Infrastructure Planning

Planning Act 2008

**The Infrastructure Planning
(Applications: Prescribed Forms and
Procedure) Regulations 2009**

**A428 Black Cat to Caxton Gibbet
improvements**
Development Consent Order 202[]

Land Plans

Regulation Reference:	Regulation 5(2)(i)
Planning Inspectorate Scheme Reference	TR010044
Application Document Reference	TR010044/APP/2.2
Author	A428 Black Cat to Caxton Gibbet improvements Project Team, Highways England

Version	Date	Status of Version
Rev 1	26 February 2021	DCO Application

Table of contents

Chapter	Pages
1	1
1.1	1
2	2
Appendix A	3

1 Introduction

1.1 General

- 1.1.1 Highways England (the Applicant) has submitted an application under Section 37 of the Planning Act 2008 (PA 2008) for an order to grant development consent for the A428 Black Cat to Caxton Gibbet improvements (the Scheme).
- 1.1.2 These Land Plans (these Plans) has been prepared to accompany the application for a Development Consent Order (DCO), made by the Applicant to the Secretary of State for Transport (SoS) via the Planning Inspectorate (the Inspectorate).
- 1.1.3 The Application is seeking powers to construct a new 10 mile (16km) dual 2-lane carriageway from Black Cat roundabout to Caxton Gibbet roundabout, to be known as the A421, and in addition approximately 1.8 miles (3km) of tie-in works. A detailed description of the Scheme can be found in **Chapter 2** of the Environmental Statement [TR010044/APP/6.1].
- 1.1.4 These Plans comprise part of the suite of Application documentation and are included in the Application in compliance with Regulation 5(2)(i) of the Infrastructure Planning (Applications: Prescribed Forms and Procedure) Regulations 2009 (the 2009 Regulations), which requires:
- '5(2)(i) a land plan identifying-*
- (i) the land required for, or affected by, the proposed development;*
 - (ii) where applicable, any land over which it is proposed to exercise powers of compulsory acquisition or any right to use land;*
 - (iii) any land in relation to which it is proposed to extinguish easements, servitudes and other private rights; and*
 - (iv) where the land includes special category land and replacement land, that special category and replacement land.'*
- 1.1.5 These Plans are also being submitted under Regulation 5(4) of the 2009 Regulations which states:
- "Where a plan comprises three or more separate sheets a key plan must be provided showing the relationship between the different sheets."*
- 1.1.6 As these Plans are part of the Application documentation, they should be read alongside and are informed by the other Application documents. In particular, these Plans should be read alongside the draft DCO [TR010044/APP/3.1], the Book of Reference [TR010044/APP/4.3] and the Statement of Reasons [TR010044/APP/4.1].

2 Schedule of plans included in this application document

Drawing Number	Drawing Title	Revision
HE551495-ARD-LSI-GEN_SW_Z_ZZ-DR-DC-2200	Land Plans Regulation 5(2)(i) Key Plan	P05
HE551495-ARD-LSI-ZN1_SW_Z_ZZ-DR-DC-2201	Land Plans Regulation 5(2)(i) Sheet 1	P05
HE551495-ARD-LSI-ZN1_SW_Z_ZZ-DR-DC-2202	Land Plans Regulation 5(2)(i) Sheet 2	P05
HE551495-ARD-LSI-ZN1_SW_Z_ZZ-DR-DC-2203	Land Plans Regulation 5(2)(i) Sheet 3	P05
HE551495-ARD-LSI-ZN2_SW_Z_ZZ-DR-DC-2204	Land Plans Regulation 5(2)(i) Sheet 4	P05
HE551495-ARD-LSI-ZN2_SW_Z_ZZ-DR-DC-2205	Land Plans Regulation 5(2)(i) Sheet 5	P05
HE551495-ARD-LSI-ZN2_SW_Z_ZZ-DR-DC-2206	Land Plans Regulation 5(2)(i) Sheet 6	P05
HE551495-ARD-LSI-ZN2_SW_Z_ZZ-DR-DC-2207	Land Plans Regulation 5(2)(i) Sheet 7	P05
HE551495-ARD-LSI-ZN3_SW_Z_ZZ-DR-DC-2208	Land Plans Regulation 5(2)(i) Sheet 8	P05
HE551495-ARD-LSI-ZN3_SW_Z_ZZ-DR-DC-2209	Land Plans Regulation 5(2)(i) Sheet 9	P05
HE551495-ARD-LSI-ZN3_SW_Z_ZZ-DR-DC-2210	Land Plans Regulation 5(2)(i) Sheet 10	P05
HE551495-ARD-LSI-ZN4_SW_Z_ZZ-DR-DC-2211	Land Plans Regulation 5(2)(i) Sheet 11	P05
HE551495-ARD-LSI-ZN4_SW_Z_ZZ-DR-DC-2212	Land Plans Regulation 5(2)(i) Sheet 12	P05
HE551495-ARD-LSI-ZN4_SW_Z_ZZ-DR-DC-2213	Land Plans Regulation 5(2)(i) Sheet 13	P05
HE551495-ARD-LSI-ZN5_SW_Z_ZZ-DR-DC-2214	Land Plans Regulation 5(2)(i) Sheet 14	P05
HE551495-ARD-LSI-ZN5_SW_Z_ZZ-DR-DC-2215	Land Plans Regulation 5(2)(i) Sheet 15	P05
HE551495-ARD-LSI-ZN5_SW_Z_ZZ-DR-DC-2216	Land Plans Regulation 5(2)(i) Sheet 16	P05

Appendix A Land plans

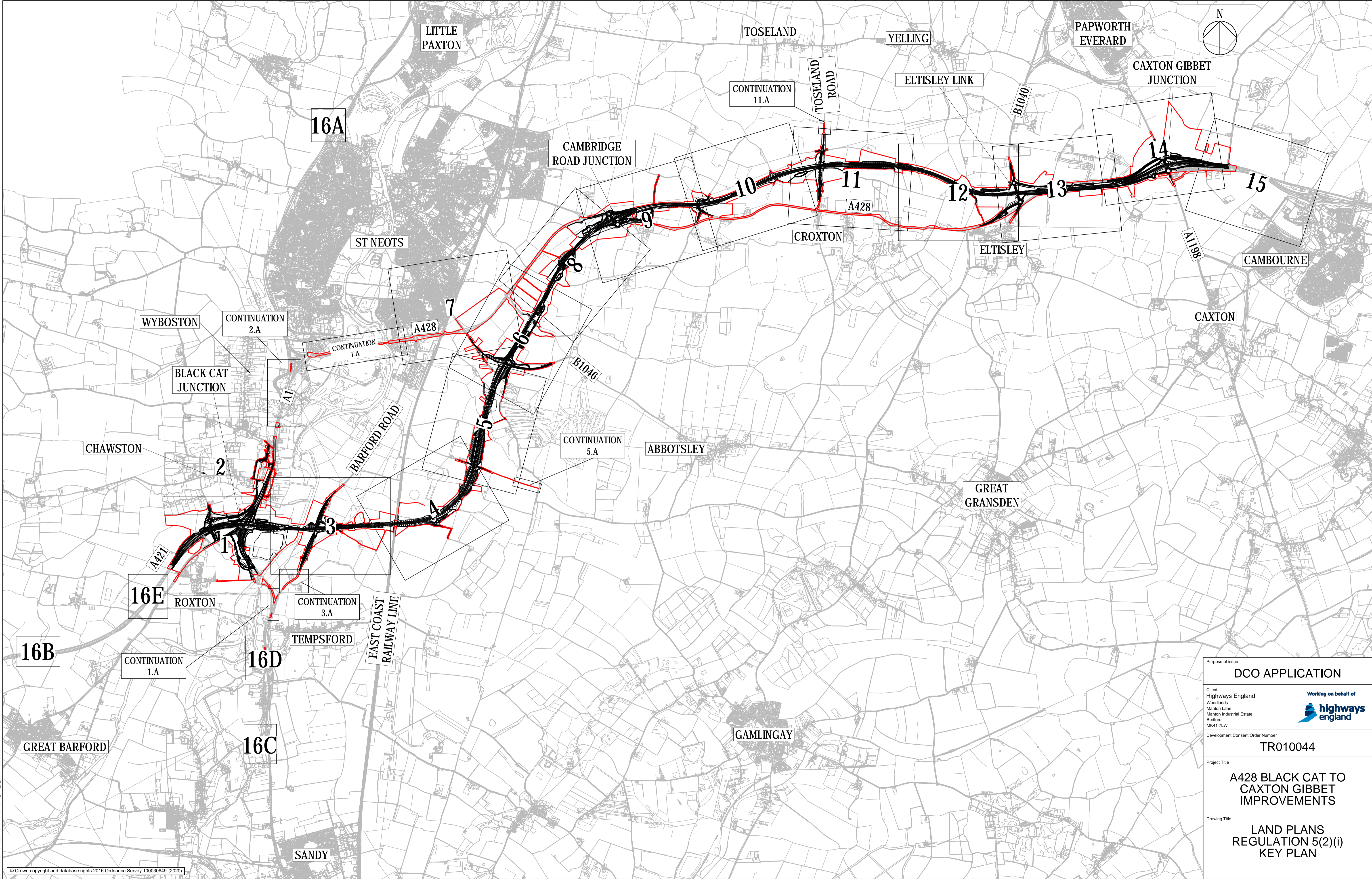

© Crown copyright and database rights 2016 Ordnance Survey 100030649 (2020)

Final for DCO Application	JT	21/01/21	P05
Revision Details	By	Date	Suffix
	Check		

- NOTES
- ALL DIMENSIONS ARE IN METRES UNLESS DEFINED OTHERWISE.
 - THIS PLAN SHOULD BE READ IN CONJUNCTION WITH OTHER PLAN APPLICATION DOCUMENTS IN PARTICULAR SCHEDULE 3 OF THE DEVELOPMENT CONSENT ORDER.
- LEGEND
- DEVELOPMENT CONSENT ORDER (DCO) BOUNDARY

Purpose of Issue

DCO APPLICATION

Client

Highways England

Woodlands

Manton Lane

Manton Industrial Estate

Bedford

MK41 7LW

Working on behalf of

highways
england

Development Consent Order Number

TR010044

Project Title

A428 BLACK CAT TO CAXTON GIBBET IMPROVEMENTS

Drawing Title

LAND PLANS
REGULATION 5(2)(i)
KEY PLAN

Designed	Drawn	Checked	Approved	Date
JT	JT	JMW	TD	15/01/21

Internal Project No.

60541541

Suitability

D7

Scale @ A1

1:25000

Zone

General

Drawing Number

Highways England PIN

HE551495

LSI

Location

GEN_SW_Z_ZZ

1 Type

1 Role

1 Number

Rev

P05

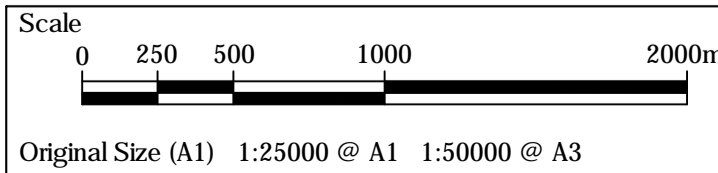

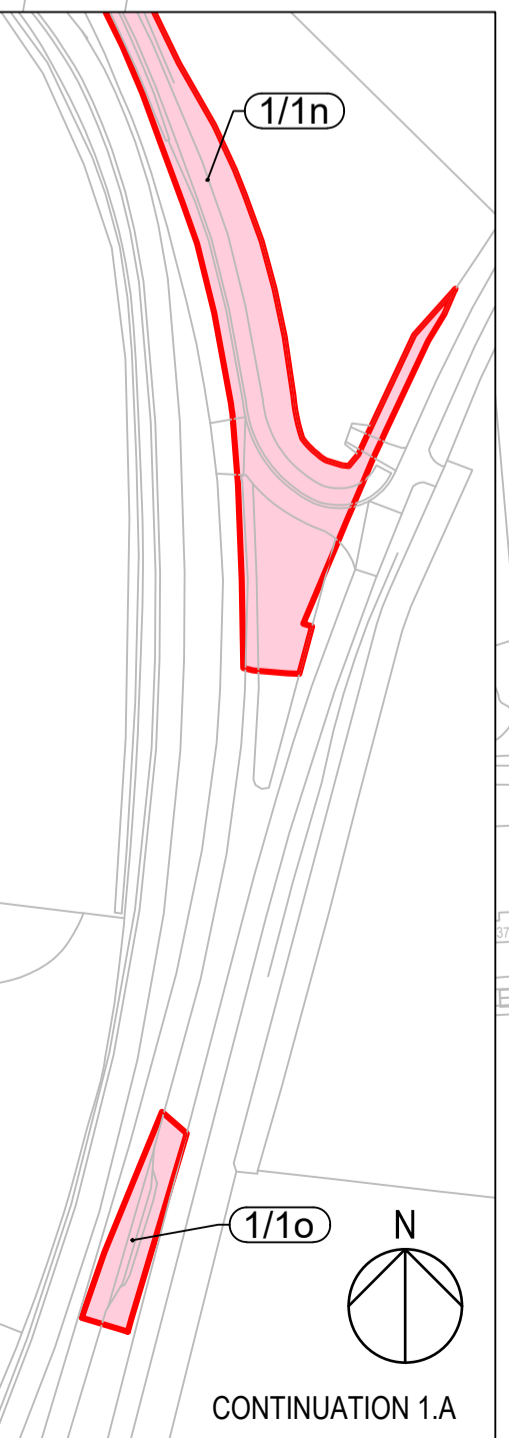
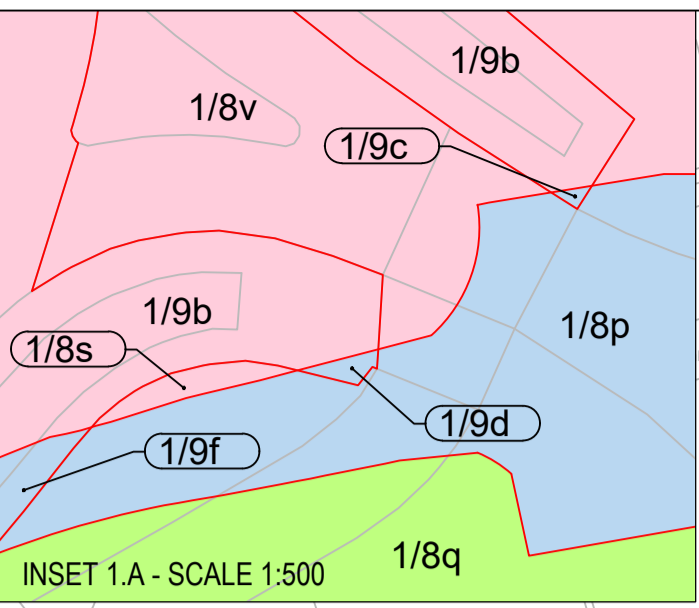
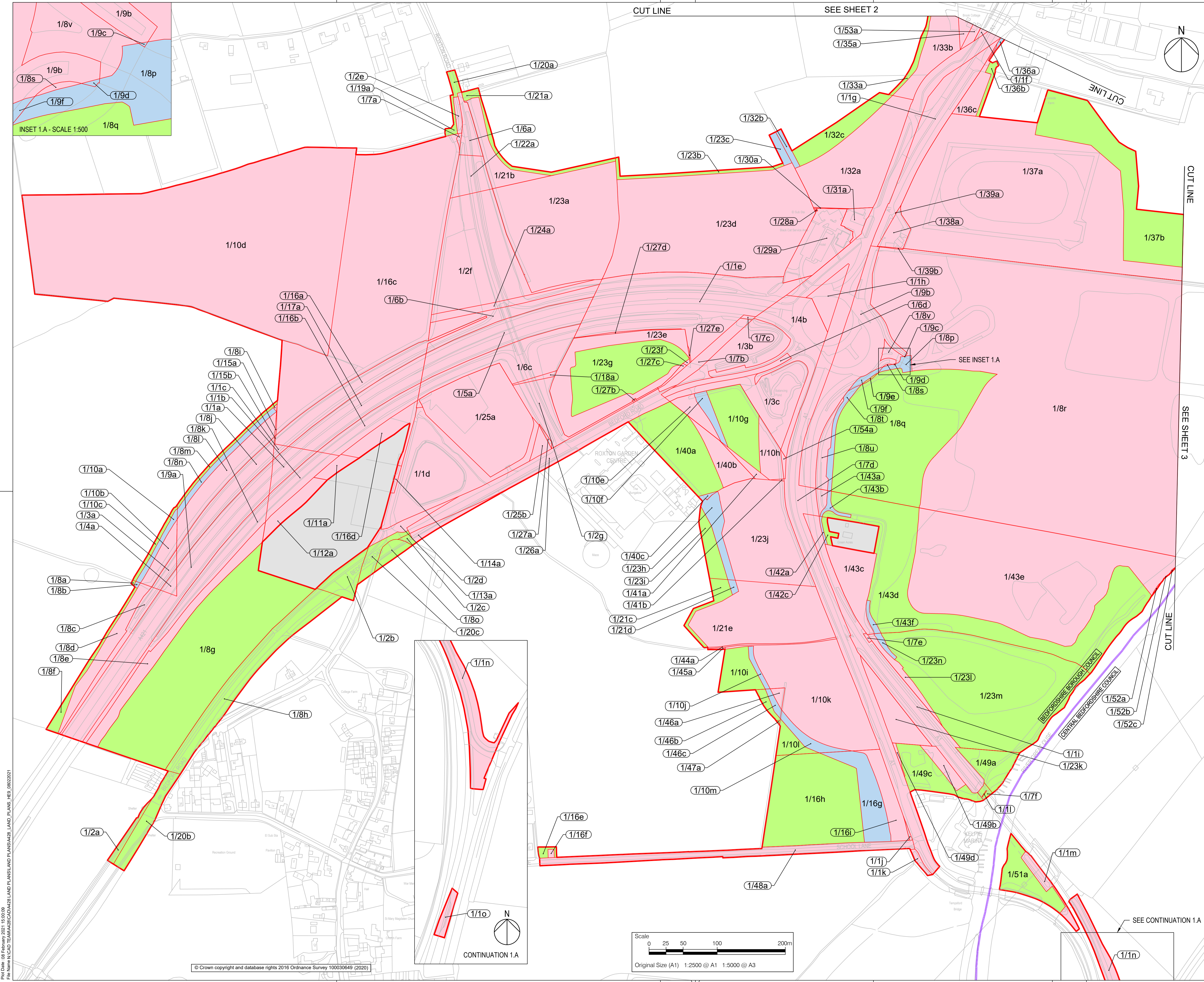

- NOTES
1. ALL DIMENSIONS ARE IN METRES UNLESS STATED OTHERWISE.
 2. DO NOT SCALE FROM THIS DRAWING, USE ONLY PRINTED DIMENSIONS.
 3. ALL EASEMENTS, SERVITUDES AND PRIVATE RIGHTS ARE PROPOSED TO BE EXTINGUISHED ON LAND THAT IS TO BE ACQUIRED UNLESS STATED OTHERWISE IN THE BOOK OF REFERENCE.
 4. THIS DRAWING IS TO BE READ IN CONJUNCTION WITH ALL OTHER PLANS AND DOCUMENTATION, IN PARTICULAR THE WORK PLANS [TR010044/APP/2.3] AND THE BOOK OF REFERENCE [TR010044/APP/4.3].

- LEGEND
- ORDER LIMITS
 - PERMANENT ACQUISITION
 - TEMPORARY POSSESSION
 - TEMPORARY POSSESSION AND ACQUISITION OF NEW RIGHTS
 - EXCLUSION FROM ORDER LIMITS
 - PARCEL NUMBERS
 - ADMINISTRATIVE BOUNDARY

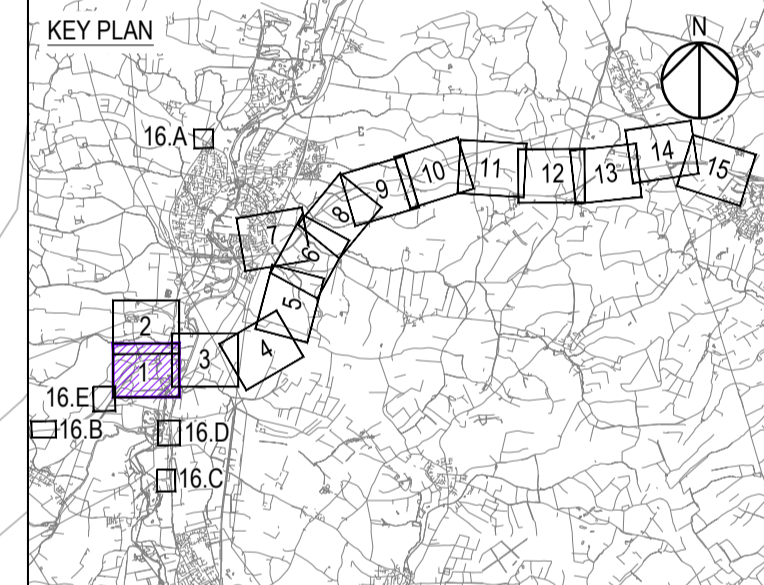

Final for DCO Application	GU	AP	02/02/21	P05
Revision Details	By	Check	Date	Suffix

Purpose of issue

DCO APPLICATION

Client
Highways England
Woodlands
Manton Lane
Manton Industrial Estate
Bedford
MK41 7LW

Development Consent Order Number
TR010044

Project Title
A428 BLACK CAT TO CAXTON GIBBET IMPROVEMENTS

Drawing Title
**LAND PLANS
REGULATION 5(2)(i)
SHEET 1**

Designed AECOM	Drawn GJ	Checked AP	Approved PG	Date 02/02/21
Internal Project No. 60541541		Suitability D7		
Scale @ A1 1:2500		Zone ZN1		
THIS DOCUMENT HAS BEEN PREPARED PURSUANT TO AND SUBJECT TO THE				

THIS DOCUMENT HAS BEEN PREPARED PURSUANT TO AND SUBJECT TO THE TERMS OF AECOM'S APPOINTMENT BY ITS CLIENT. AECOM ACCEPTS NO LIABILITY FOR ANY USE OF THIS DOCUMENT OTHER THAN BY ITS ORIGINAL CLIENT OR FOLLOWING AECOM'S EXPRESS AGREEMENT TO SUCH USE, AND ONLY FOR THE PURPOSES FOR WHICH IT WAS PREPARED AND PROVIDED.

Drawing Number HE551495 -ARD	1 Originator -LSI	1 Volume -	Rev P05
Location ZN1_SW_Z_ZZ	1 Type -DR	1 Role -DC	1 Number 2201

Rev Date: 08 February 2021 1:25:38
File Name: N:\CADD\TEMP\A428\A428_0428_LAND PLANS AND PLANS\A428_LAND PLANS REG_08022021

© Crown copyright and database rights 2016 Ordnance Survey 100030649 (2020)

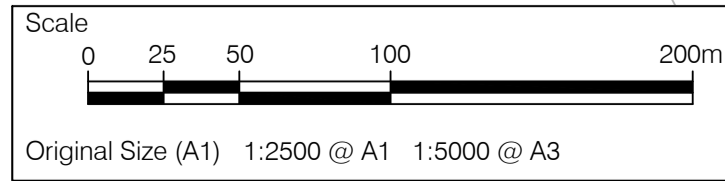

- NOTES
1. ALL DIMENSIONS ARE IN METRES UNLESS STATED OTHERWISE.
 2. DO NOT SCALE FROM THIS DRAWING, USE ONLY PRINTED DIMENSIONS.
 3. ALL EASEMENTS, SERVITUDES AND PRIVATE RIGHTS ARE PROPOSED TO BE EXTINGUISHED ON LAND THAT IS TO BE ACQUIRED UNLESS STATED OTHERWISE IN THE BOOK OF REFERENCE.
 4. THIS DRAWING IS TO BE READ IN CONJUNCTION WITH ALL OTHER PLANS AND DOCUMENTATION, IN PARTICULAR THE WORK PLANS [TR010044/APP/2.3] AND THE BOOK OF REFERENCE [TR010044/APP/4.3].

- LEGEND
- ORDER LIMITS
 - PERMANENT ACQUISITION
 - TEMPORARY POSSESSION
 - TEMPORARY POSSESSION AND ACQUISITION OF NEW RIGHTS
 - EXCLUSION FROM ORDER LIMITS
 - PARCEL NUMBERS
 - ADMINISTRATIVE BOUNDARY

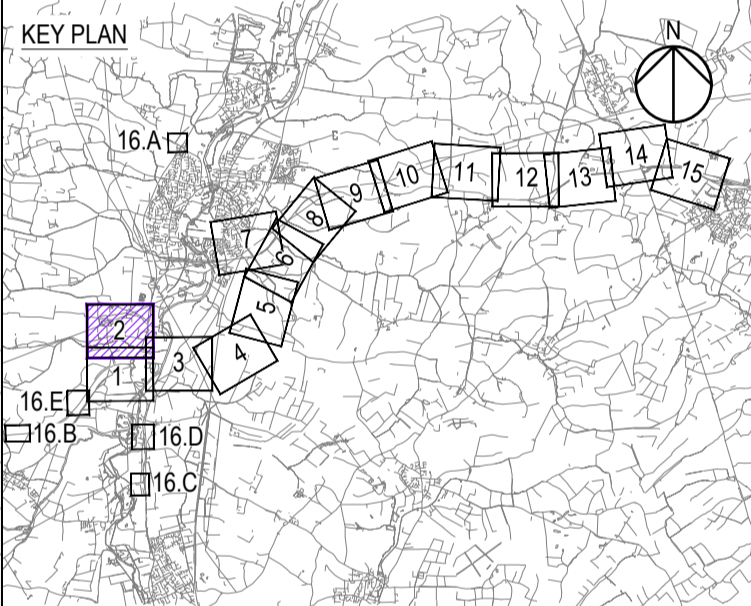

Final for DCO Application	GJ	AP	02/02/21	P05
Revision Details	By	Check	Date	Suffix

DCO APPLICATION

Client
Highways England
Woodlands
Manton Lane
Manton Industrial Estate
Bedford
MK41 7LW

Working on behalf of
highways england

Development Consent Order Number
TR010044

Project Title
A428 BLACK CAT TO CAXTON GIBBET IMPROVEMENTS

Drawing Title
**LAND PLANS
REGULATION 5(2)(i)
SHEET 2**

Designed AECOM	Drawn GJ	Checked AP	Approved PG	Date 02/02/21
Internal Project No. 60541541		Suitability D7		
Scale @ A1 1:2500		Zone ZN1		

THIS DOCUMENT HAS BEEN PREPARED PURSUANT TO AND SUBJECT TO THE TERMS OF AECOM'S APPOINTMENT BY ITS CLIENT. AECOM ACCEPTS NO LIABILITY FOR ANY USE OF THIS DOCUMENT OTHER THAN BY ITS ORIGINAL CLIENT OR FOLLOWING AECOM'S EXPRESS AGREEMENT TO SUCH USE, AND ONLY FOR THE PURPOSES FOR WHICH IT WAS PREPARED AND PROVIDED.

Drawing Number HE551495 -ARD -LSI - ZN1_SW_Z_ZZ -DR-DC-2202	Location I Type 1 Role 1 Number	Rev P05
---	------------------------------------	------------

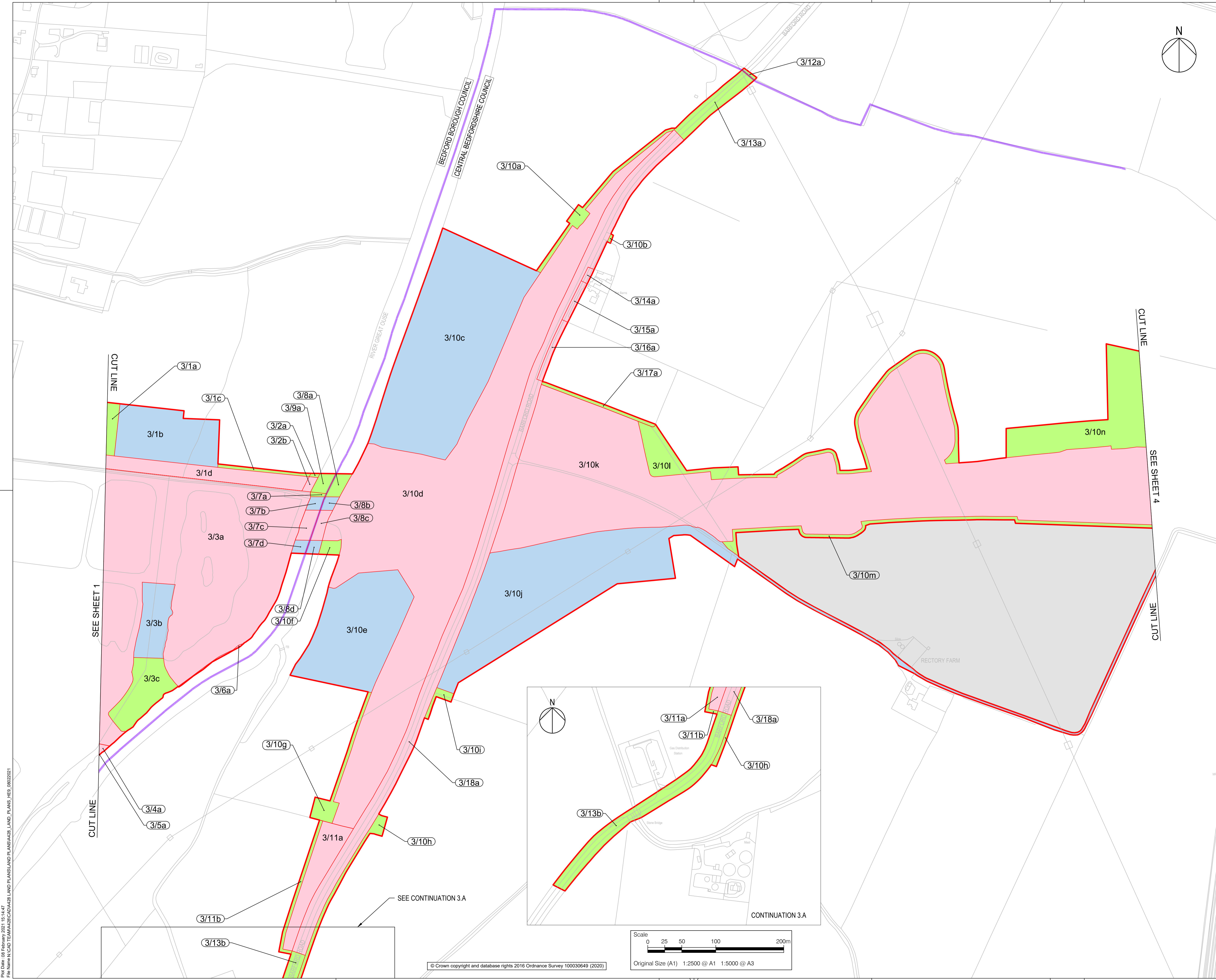

NOTES

- ALL DIMENSIONS ARE IN METRES UNLESS STATED OTHERWISE.
- DO NOT SCALE FROM THIS DRAWING, USE ONLY PRINTED DIMENSIONS.
- ALL EASEMENTS, SERVITUDES AND PRIVATE RIGHTS ARE PROPOSED TO BE EXTINGUISHED ON LAND THAT IS TO BE ACQUIRED UNLESS STATED OTHERWISE IN THE BOOK OF REFERENCE.
- THIS DRAWING IS TO BE READ IN CONJUNCTION WITH ALL OTHER PLANS AND DOCUMENTATION, IN PARTICULAR THE WORK PLANS [TR010044/APP/2.3] AND THE BOOK OF REFERENCE [TR010044/APP/4.3].

LEGEND

ORDER LIMITS

PERMANENT ACQUISITION

TEMPORARY POSSESSION

TEMPORARY POSSESSION AND ACQUISITION OF NEW RIGHTS

EXCLUSION FROM ORDER LIMITS

XXXX

PARCEL NUMBERS

ADMINISTRATIVE BOUNDARY

KEY PLAN

Final for DCO Application	GJ	AP	02/02/21	P05
Revision Details	By	Check	Date	Suffix

Purpose of issue

DCO APPLICATION

Client
Highways England
Woodlands
Manton Lane
Manton Industrial Estate
Bedford
MK41 7LW

Working on behalf of
highways england

Development Consent Order Number

TR010044

Project Title

A428 BLACK CAT TO CAXTON GIBBET IMPROVEMENTS

Drawing Title

**LAND PLANS
REGULATION 5(2)(i)
SHEET 3**

Designed AECOM	Drawn GJ	Checked AP	Approved PG	Date 02/02/21
Internal Project No. 60541541			Suitability D7	
Scale @ A1 1:2500			Zone ZN1	

THIS DOCUMENT HAS BEEN PREPARED PURSUANT TO AND SUBJECT TO THE TERMS OF AECOM'S APPOINTMENT BY ITS CLIENT. AECOM ACCEPTS NO LIABILITY FOR ANY USE OF THIS DOCUMENT OTHER THAN BY ITS ORIGINAL CLIENT OR FOLLOWING AECOM'S EXPRESS AGREEMENT TO SUCH USE, AND ONLY FOR THE PURPOSES FOR WHICH IT WAS PREPARED AND PROVIDED.

Drawing Number HE551495	Highways England PIN -ARD	1 Originator -LSI	1 Volume -	Rev P05
Location ZN1_SW_Z_ZZ -DR-DC-2203				1 Type 1

Plot Date: 18 February 2021 15:14:07
File Name: IN-CAD-TEMP\A428\CD\A428_LAND PLANS\HE551495.dwg

© Crown copyright and database rights 2016 Ordnance Survey 100030649 (2020)

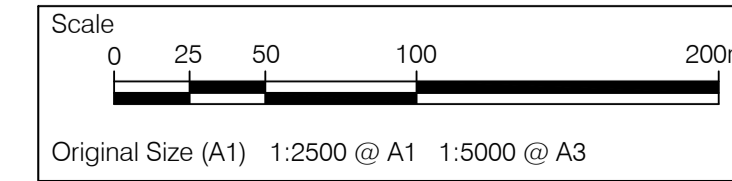

CONTINUATION 3.A

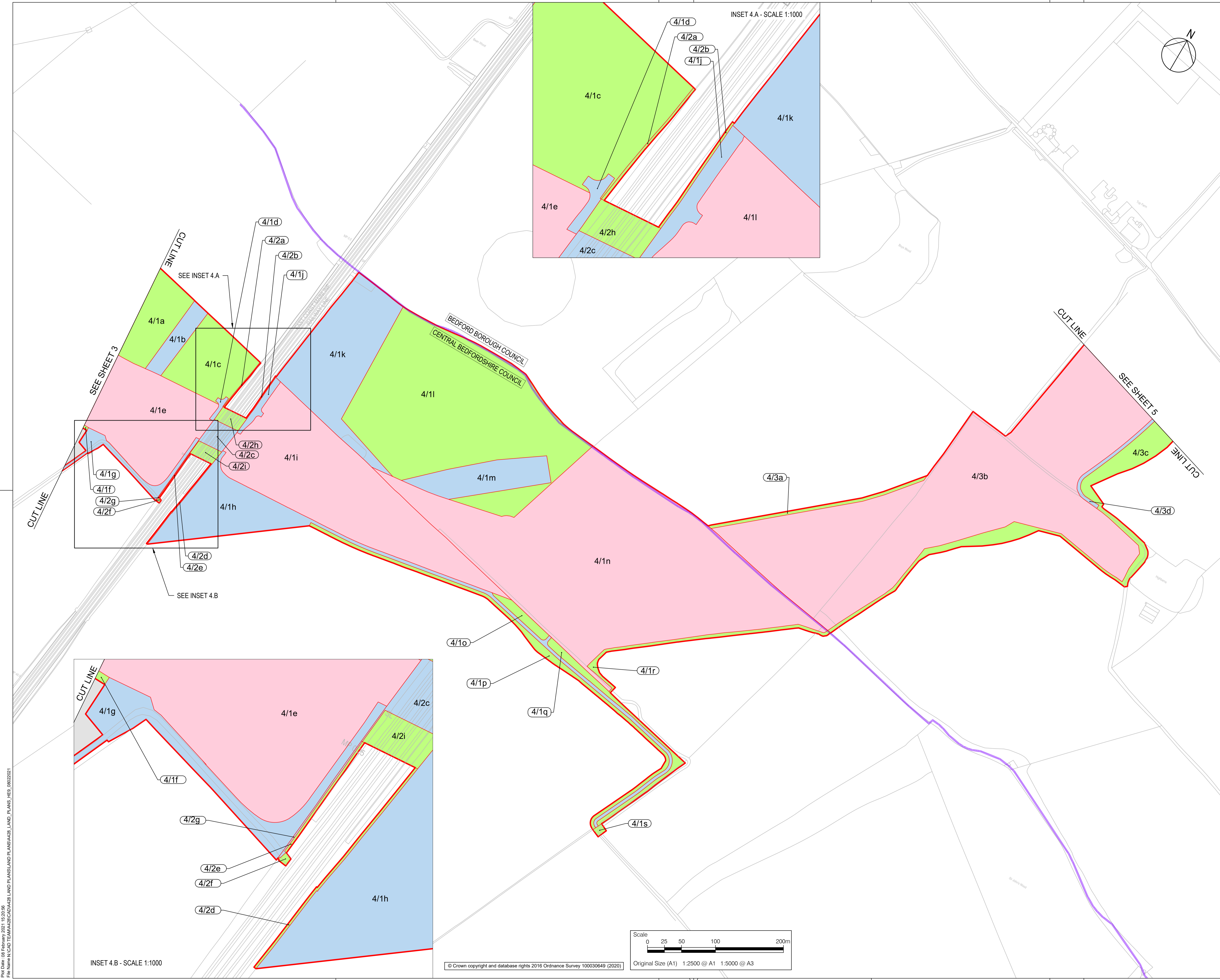

NOTES

- ALL DIMENSIONS ARE IN METRES UNLESS STATED OTHERWISE.
- DO NOT SCALE FROM THIS DRAWING, USE ONLY PRINTED DIMENSIONS.
- ALL EASEMENTS, SERVITUDES AND PRIVATE RIGHTS ARE PROPOSED TO BE EXTINGUISHED ON LAND THAT IS TO BE ACQUIRED UNLESS STATED OTHERWISE IN THE BOOK OF REFERENCE.
- THIS DRAWING IS TO BE READ IN CONJUNCTION WITH ALL OTHER PLANS AND DOCUMENTATION, IN PARTICULAR THE WORK PLANS [TR010044/APP/2.3] AND THE BOOK OF REFERENCE [TR010044/APP/4.3].

LEGEND

ORDER LIMITS

PERMANENT ACQUISITION

TEMPORARY POSSESSION

TEMPORARY POSSESSION AND ACQUISITION OF NEW RIGHTS

EXCLUSION FROM ORDER LIMITS

PARCEL NUMBERS

ADMINISTRATIVE BOUNDARY

KEY PLAN

Final for DCO Application	GJ	AP	02/02/21	P05
Revision Details	By	Check	Date	Suffix

Purpose of issue

DCO APPLICATION

Client
Highways England
Woodlands
Manton Lane
Manton Industrial Estate
Bedford
MK41 7LW

Development Consent Order Number
TR010044

Project Title
A428 BLACK CAT TO CAXTON GIBBET IMPROVEMENTS

Drawing Title
**LAND PLANS
REGULATION 5(2)(i)
SHEET 4**

Designed AECOM	Drawn GJ	Checked AP	Approved PG	Date 02/02/21
Internal Project No. 60541541			Suitability D7	
Scale @ A1 1:2500			Zone ZN2	

THIS DOCUMENT HAS BEEN PREPARED PURSUANT TO AND SUBJECT TO THE TERMS OF AECOM'S APPOINTMENT BY ITS CLIENT. AECOM ACCEPTS NO LIABILITY FOR ANY USE OF THIS DOCUMENT OTHER THAN BY ITS ORIGINAL CLIENT OR FOLLOWING AECOM'S EXPRESS AGREEMENT TO SUCH USE, AND ONLY FOR THE PURPOSES FOR WHICH IT WAS PREPARED AND PROVIDED.

Drawing Number Highways England PIN HE551495	1 Originator -ARD	1 Volume -LSI	Rev P05
Location ZN2_SW_Z_ZZ			1 Type -DR-DC-2204

Rev 001: 08 February 2021 15:03:35
File Name: IN-CAD-TEMP-428-DCO-A428_LAND_PLANS_HIE_06022021

© Crown copyright and database rights 2016 Ordnance Survey 100030649 (2020)

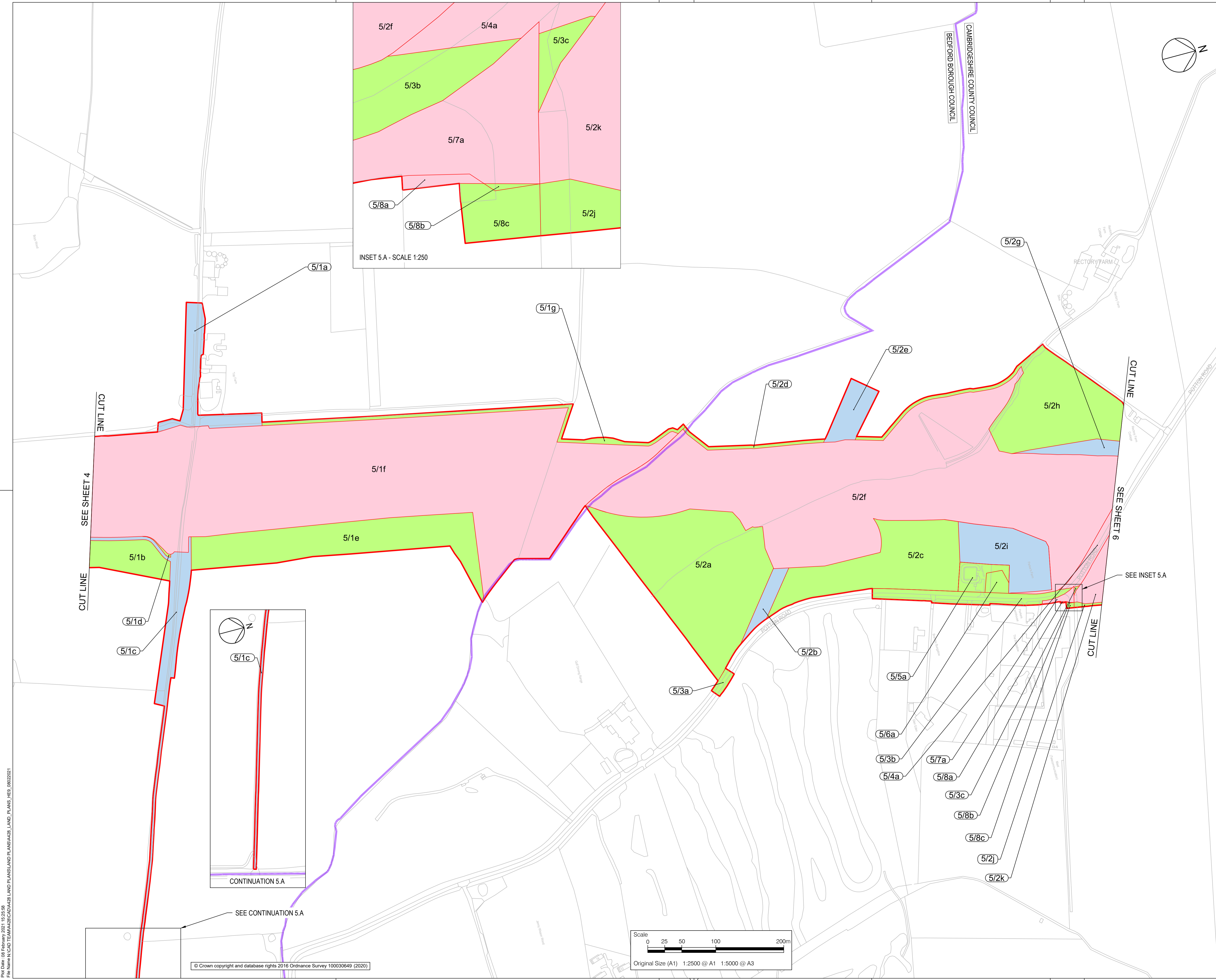

NOTES

- ALL DIMENSIONS ARE IN METRES UNLESS STATED OTHERWISE.
- DO NOT SCALE FROM THIS DRAWING, USE ONLY PRINTED DIMENSIONS.
- ALL EASEMENTS, SERVITUDES AND PRIVATE RIGHTS ARE PROPOSED TO BE EXTINGUISHED ON LAND THAT IS TO BE ACQUIRED UNLESS STATED OTHERWISE IN THE BOOK OF REFERENCE.
- THIS DRAWING IS TO BE READ IN CONJUNCTION WITH ALL OTHER PLANS AND DOCUMENTATION, IN PARTICULAR THE WORK PLANS [TR010044/APP/2.3] AND THE BOOK OF REFERENCE [TR010044/APP/4.3].

LEGEND

- ORDER LIMITS
- PERMANENT ACQUISITION
- TEMPORARY POSSESSION
- TEMPORARY POSSESSION AND ACQUISITION OF NEW RIGHTS
- EXCLUSION FROM ORDER LIMITS
- PARCEL NUMBERS
- ADMINISTRATIVE BOUNDARY

KEY PLAN

Final for DCO Application	GJ	AP	02/02/21	P05
Revision Details	By	Check	Date	Suffix

DCO APPLICATION

Client
Highways England
Woodlands
Manton Lane
Manton Industrial Estate
Bedford
MK41 7LW

Development Consent Order Number
TR010044

Project Title
A428 BLACK CAT TO CAXTON GIBBET IMPROVEMENTS

Drawing Title
**LAND PLANS
REGULATION 5(2)(i)
SHEET 5**

Designed AECOM	Drawn GJ	Checked AP	Approved PG	Date 02/02/21
Internal Project No. 60541541			Suitability D7	
Scale @ A1 1:2500			Zone ZN2	

THIS DOCUMENT HAS BEEN PREPARED PURSUANT TO AND SUBJECT TO THE TERMS OF AECOM'S APPOINTMENT BY ITS CLIENT. AECOM ACCEPTS NO LIABILITY FOR ANY USE OF THIS DOCUMENT OTHER THAN BY ITS ORIGINAL CLIENT OR FOLLOWING AECOM'S EXPRESS AGREEMENT TO SUCH USE, AND ONLY FOR THE PURPOSES FOR WHICH IT WAS PREPARED AND PROVIDED.

Drawing Number HE551495 -ARD	1 Originator -LSI -	1 Volume -	Rev P05
Location ZN2_SW_Z_ZZ -DR-DC-2205			1 Type 1 Role 1 Number

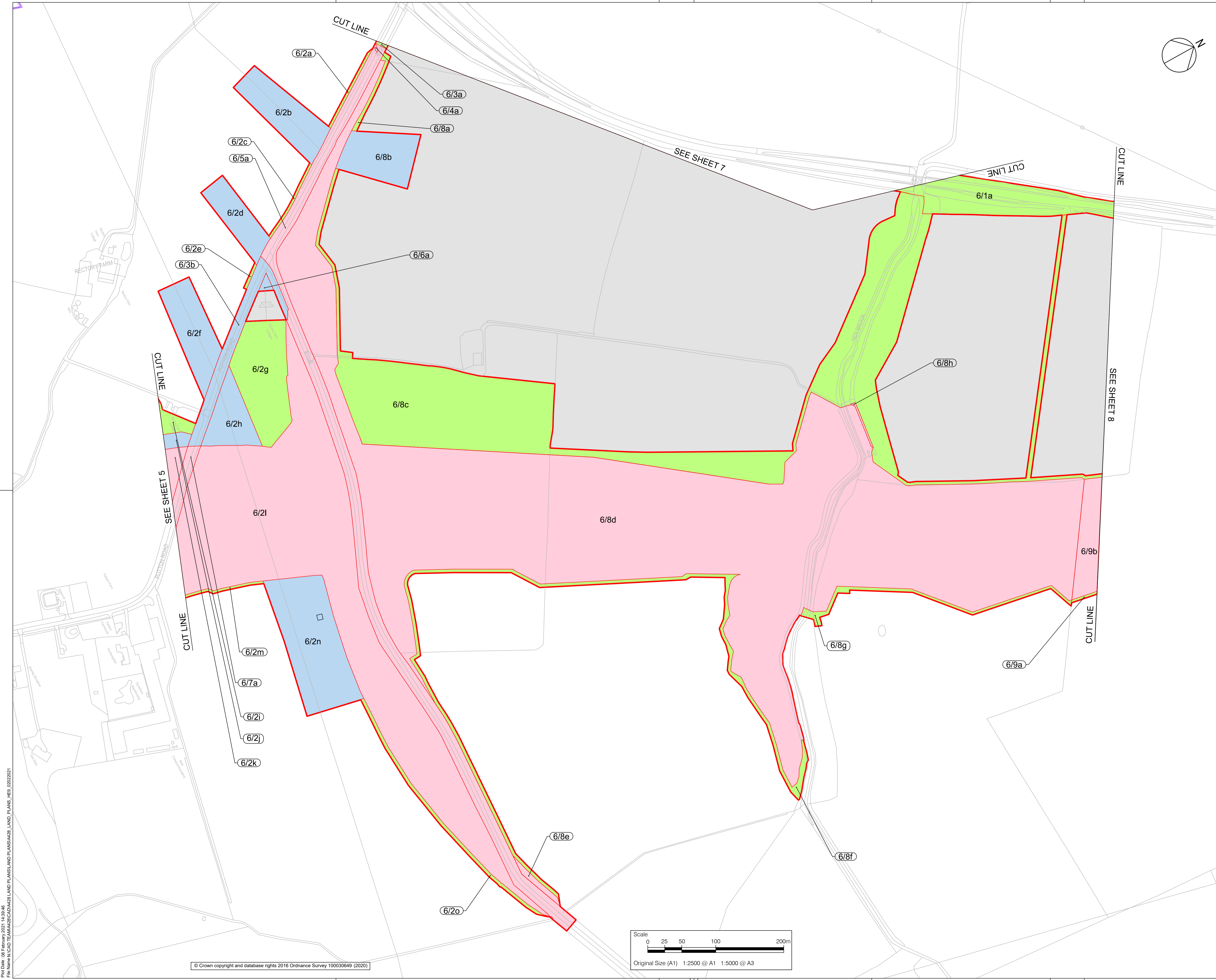

NOTES

- ALL DIMENSIONS ARE IN METRES UNLESS STATED OTHERWISE.
- DO NOT SCALE FROM THIS DRAWING, USE ONLY PRINTED DIMENSIONS.
- ALL EASEMENTS, SERVITUDES AND PRIVATE RIGHTS ARE PROPOSED TO BE EXTINGUISHED ON LAND THAT IS TO BE ACQUIRED UNLESS STATED OTHERWISE IN THE BOOK OF REFERENCE.
- THIS DRAWING IS TO BE READ IN CONJUNCTION WITH ALL OTHER PLANS AND DOCUMENTATION, IN PARTICULAR THE WORK PLANS [TR010044/APP/2.3] AND THE BOOK OF REFERENCE [TR010044/APP/4.3].

LEGEND

ORDER LIMITS

PERMANENT ACQUISITION

TEMPORARY POSSESSION

TEMPORARY POSSESSION AND ACQUISITION OF NEW RIGHTS

EXCLUSION FROM ORDER LIMITS

PARCEL NUMBERS

ADMINISTRATIVE BOUNDARY

KEY PLAN

Final for DCO Application	GJ	AP	02/02/21	P05
Revision Details	By	Check	Date	Suffix

Purpose of issue

DCO APPLICATION

Client
Highways England
Woodlands
Manton Lane
Manton Industrial Estate
Bedford
MK41 7LW

Development Consent Order Number
TR010044

Project Title
A428 BLACK CAT TO CAXTON GIBBET IMPROVEMENTS

Drawing Title
**LAND PLANS
REGULATION 5(2)(i)
SHEET 6**

Designed AECOM	Drawn GJ	Checked AP	Approved PG	Date 02/02/21
Internal Project No. 60541541			Suitability D7	
Scale @ A1 1:2500			Zone ZN2	

THIS DOCUMENT HAS BEEN PREPARED PURSUANT TO AND SUBJECT TO THE TERMS OF AECOM'S APPOINTMENT BY ITS CLIENT. AECOM ACCEPTS NO LIABILITY FOR ANY USE OF THIS DOCUMENT OTHER THAN BY ITS ORIGINAL CLIENT OR FOLLOWING AECOM'S EXPRESS AGREEMENT TO SUCH USE, AND ONLY FOR THE PURPOSES FOR WHICH IT WAS PREPARED AND PROVIDED.

Drawing Number HE551495	Highways England PIN -ARD	1 Originator -LSI	1 Volume -	Rev P05
Location ZN2_SW_Z_ZZ -DR-DC-2206				1 Type 1 Role 1 Number

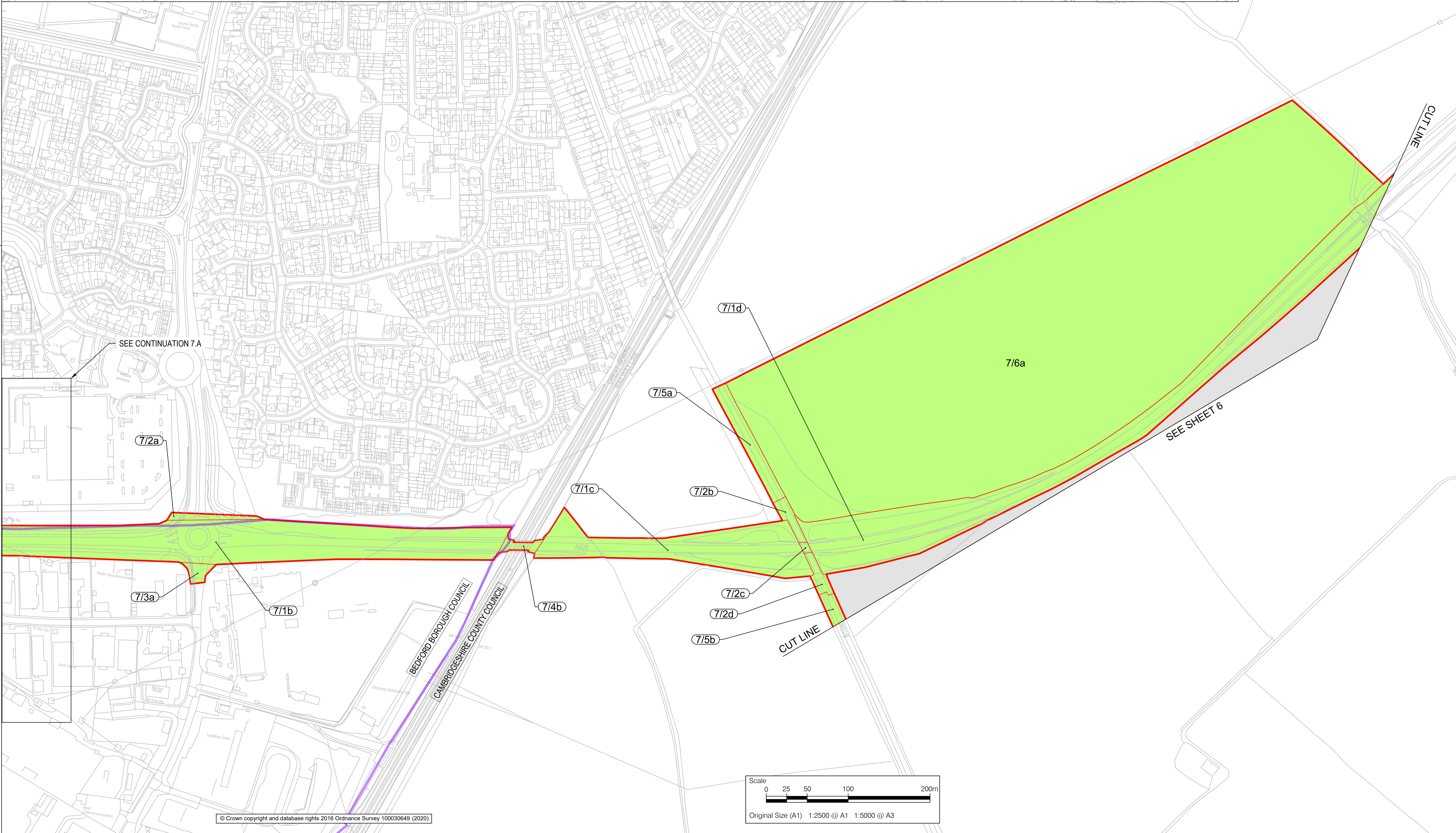
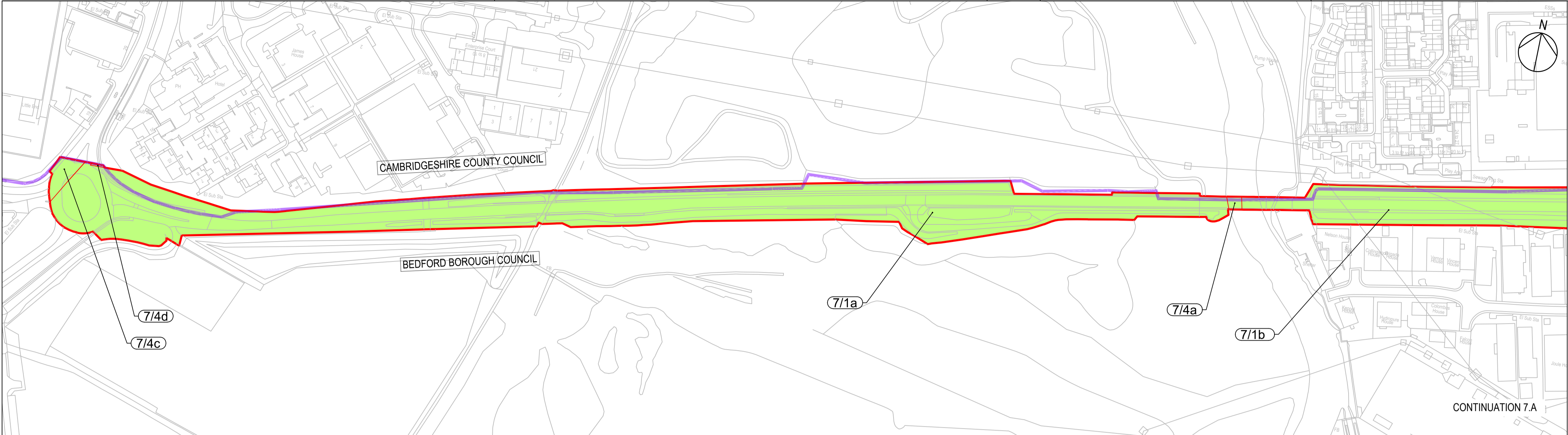

- NOTES
1. ALL DIMENSIONS ARE IN METRES UNLESS STATED OTHERWISE.
 2. DO NOT SCALE FROM THIS DRAWING, USE ONLY PRINTED DIMENSIONS.
 3. ALL EASEMENTS, SERVITUDES AND PRIVATE RIGHTS ARE PROPOSED TO BE EXTINGUISHED ON LAND THAT IS TO BE ACQUIRED UNLESS STATED OTHERWISE IN THE BOOK OF REFERENCE.
 4. THIS DRAWING IS TO BE READ IN CONJUNCTION WITH ALL OTHER PLANS AND DOCUMENTATION, IN PARTICULAR THE WORK PLANS [TR010044/APP/2.3] AND THE BOOK OF REFERENCE [TR010044/APP/4.3].

- LEGEND
- ORDER LIMITS
 - PERMANENT ACQUISITION
 - TEMPORARY POSSESSION
 - TEMPORARY POSSESSION AND ACQUISITION OF NEW RIGHTS
 - EXCLUSION FROM ORDER LIMITS
 - PARCEL NUMBERS
 - ADMINISTRATIVE BOUNDARY

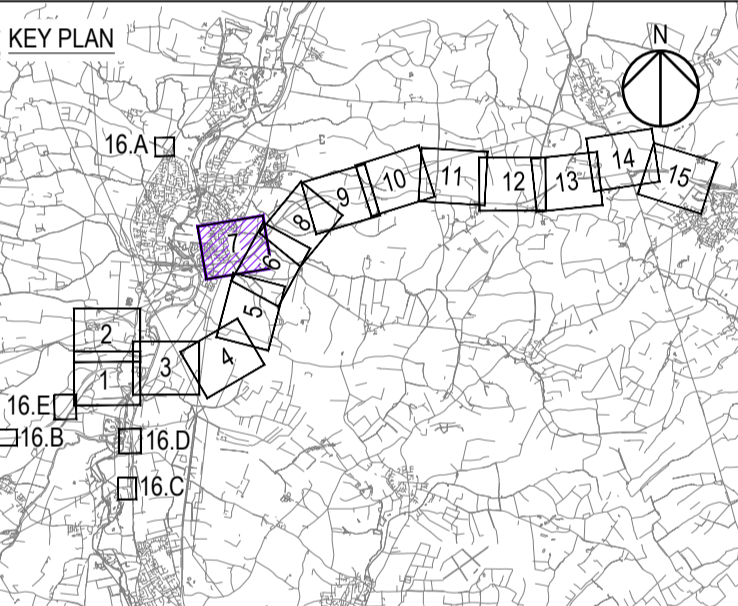

Final for DCO Application	GJ	AP	02/02/21	P05
Revision Details	By	Check	Date	Suffix

DCO APPLICATION

Client
Highways England
Woodlands
Manton Lane
Manton Industrial Estate
Bedford
MK41 7LW



Development Consent Order Number
TR010044

Project Title
A428 BLACK CAT TO CAXTON GIBBET IMPROVEMENTS

Drawing Title
LAND PLANS
REGULATION 5(2)(i)
SHEET 7

Designed AECOM	Drawn GJ	Checked AP	Approved PG	Date 02/02/21
Internal Project No. 60541541		Suitability D7		
Scale @ A1 1:2500		Zone ZN2		

THIS DOCUMENT HAS BEEN PREPARED PURSUANT TO AND SUBJECT TO THE TERMS OF AECOM'S APPOINTMENT BY ITS CLIENT. AECOM ACCEPTS NO LIABILITY FOR ANY USE OF THIS DOCUMENT OTHER THAN BY ITS ORIGINAL CLIENT OR FOLLOWING AECOM'S EXPRESS AGREEMENT TO SUCH USE, AND ONLY FOR THE PURPOSES FOR WHICH IT WAS PREPARED AND PROVIDED.

Drawing Number HE551495 -ARD -LSI - ZN2_SW_Z_ZZ -DR-DC-2207	Location I Type I Role I Number	Rev P05
---	------------------------------------	------------

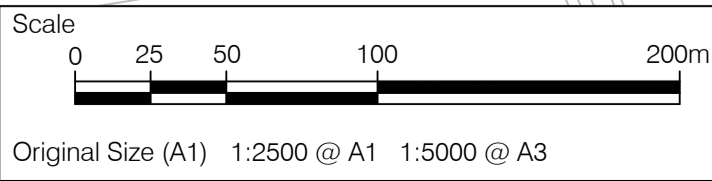

Rev Date: 08 February 2021 15:45:27
File Name: IN-CAD-TEMP-428-CAD-A428_LAND_PLANS_HES_08022021

© Crown copyright and database rights 2016 Ordnance Survey 100030649 (2020)

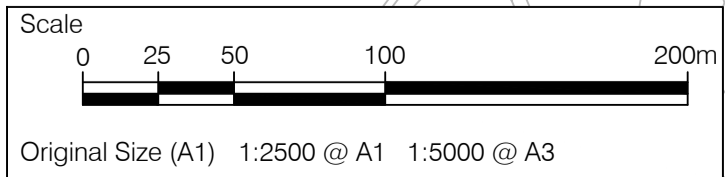

NOTES

1. ALL DIMENSIONS ARE IN METRES UNLESS STATED OTHERWISE.
2. DO NOT SCALE FROM THIS DRAWING, USE ONLY PRINTED DIMENSIONS.
3. ALL EASEMENTS, SERVITUDES AND PRIVATE RIGHTS ARE PROPOSED TO BE EXTINGUISHED ON LAND THAT IS TO BE ACQUIRED UNLESS STATED OTHERWISE IN THE BOOK OF REFERENCE.
4. THIS DRAWING IS TO BE READ IN CONJUNCTION WITH ALL OTHER PLANS AND DOCUMENTATION, IN PARTICULAR THE WORK PLANS [TR010044/APP/2.3] AND THE BOOK OF REFERENCE [TR010044/APP/4.3].

LEGEND

- ORDER LIMITS
- PERMANENT ACQUISITION
- TEMPORARY POSSESSION
- TEMPORARY POSSESSION AND ACQUISITION OF NEW RIGHTS
- EXCLUSION FROM ORDER LIMITS
- PARCEL NUMBERS
- ADMINISTRATIVE BOUNDARY

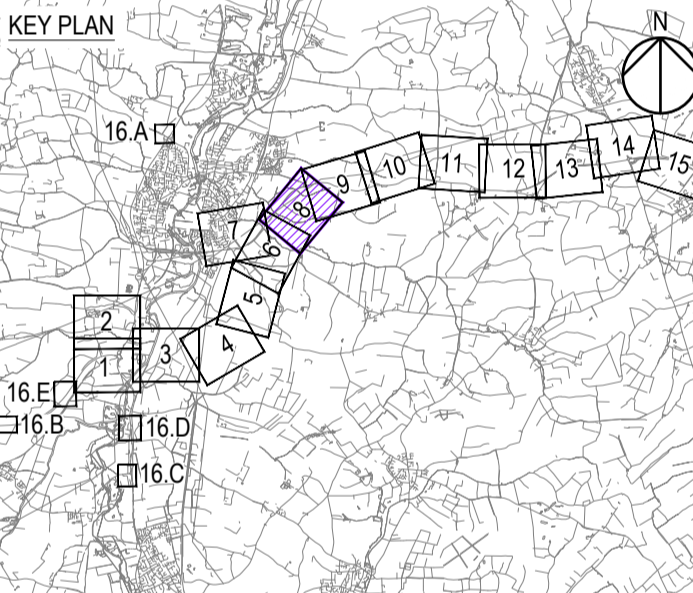

Final for DCO Application	GJ	AP	02/02/21 P05
Revision Details	By	Check	Date
Purpose of issue			Suffix

DCO APPLICATION

Client
Highways England
Woodlands
Manton Lane
Manton Industrial Estate
Bedford
MK41 7LW

Working on behalf of

Development Consent Order Number
TR010044

Project Title
A428 BLACK CAT TO CAXTON GIBBET IMPROVEMENTS

Drawing Title
**LAND PLANS
REGULATION 5(2)(i)
SHEET 8**

Designed AECOM	Drawn GJ	Checked AP	Approved PG	Date 02/02/21
Internal Project No. 60541541			Suitability D7	
Scale @ A1 1:2500			Zone ZN3	

THIS DOCUMENT HAS BEEN PREPARED PURSUANT TO AND SUBJECT TO THE TERMS OF AECOM'S APPOINTMENT BY ITS CLIENT. AECOM ACCEPTS NO LIABILITY FOR ANY USE OF THIS DOCUMENT OTHER THAN BY ITS ORIGINAL CLIENT OR FOLLOWING AECOM'S EXPRESS AGREEMENT TO SUCH USE, AND ONLY FOR THE PURPOSES FOR WHICH IT WAS PREPARED AND PROVIDED.

Drawing Number HE551495 -ARD	1 Originator -LSI	1 Volume -P05	Rev P05
Location ZN3_SW_Z_ZZ	1 Type -DR	1 Role -DC	1 Number 2208

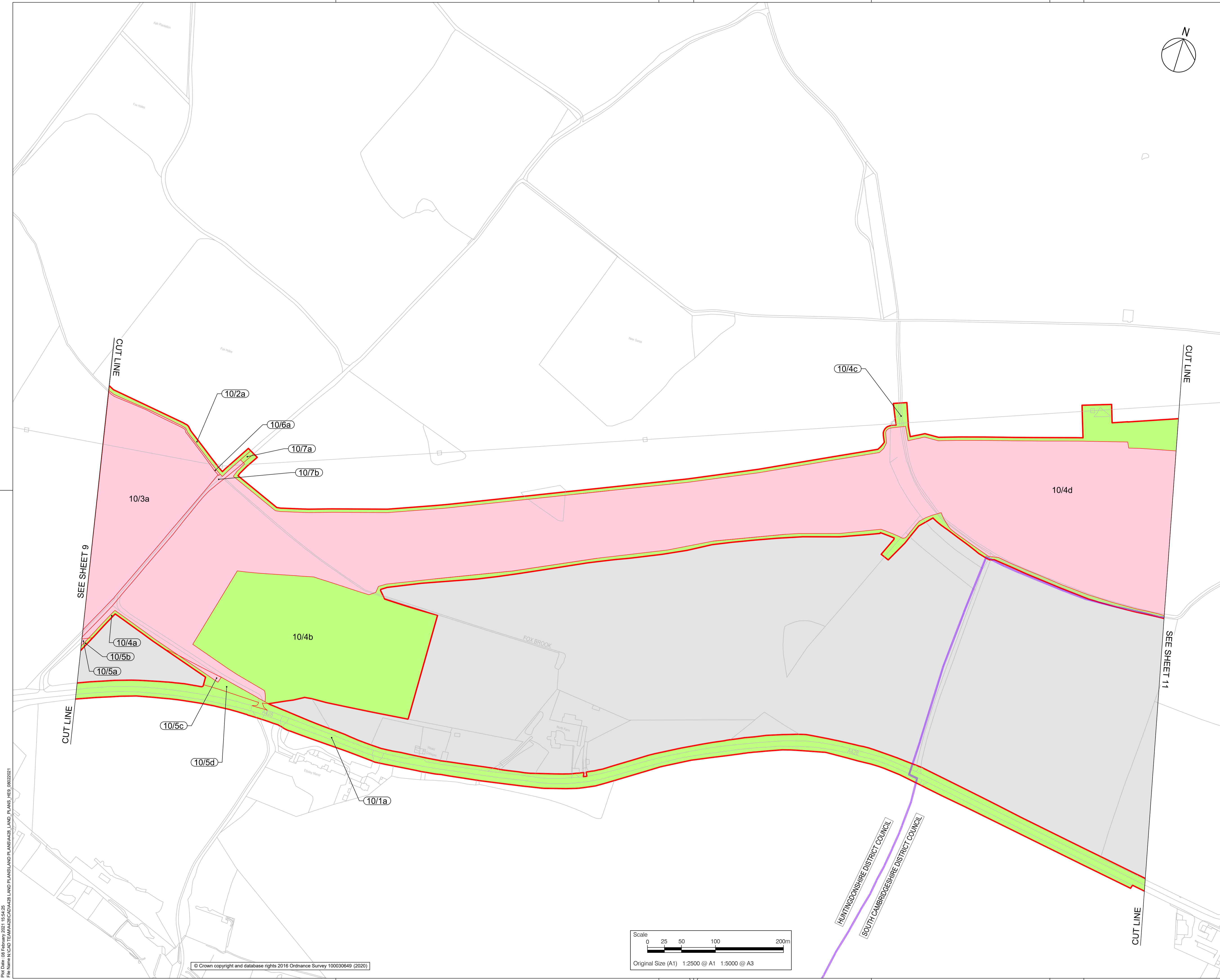

- NOTES
1. ALL DIMENSIONS ARE IN METRES UNLESS STATED OTHERWISE.
 2. DO NOT SCALE FROM THIS DRAWING, USE ONLY PRINTED DIMENSIONS.
 3. ALL EASEMENTS, SERVITUDES AND PRIVATE RIGHTS ARE PROPOSED TO BE EXTINGUISHED ON LAND THAT IS TO BE ACQUIRED UNLESS STATED OTHERWISE IN THE BOOK OF REFERENCE.
 4. THIS DRAWING IS TO BE READ IN CONJUNCTION WITH ALL OTHER PLANS AND DOCUMENTATION, IN PARTICULAR THE WORK PLANS [TR010044/APP/2.3] AND THE BOOK OF REFERENCE [TR010044/APP/4.3].

LEGEND

- ORDER LIMITS
- PERMANENT ACQUISITION
- TEMPORARY POSSESSION
- TEMPORARY POSSESSION AND ACQUISITION OF NEW RIGHTS
- EXCLUSION FROM ORDER LIMITS
- PARCEL NUMBERS
- ADMINISTRATIVE BOUNDARY

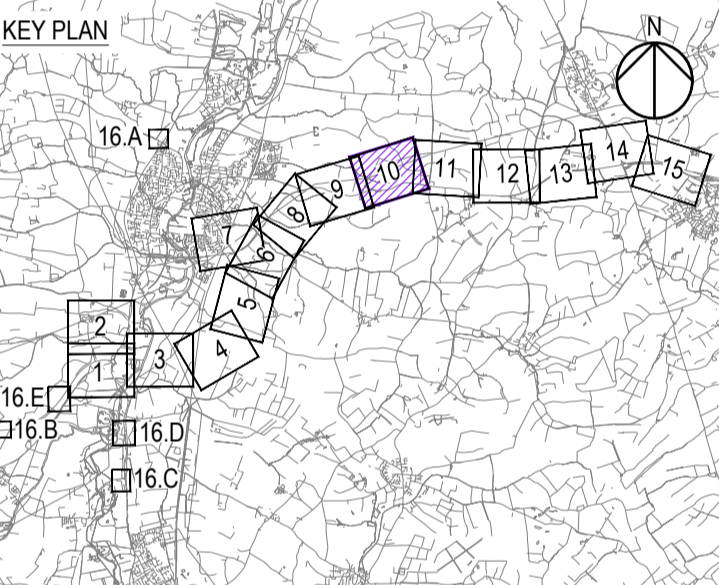

Final for DCO Application	GJ	AP	02/02/21	P05
Revision Details	By	Check	Date	Suffix

DCO APPLICATION

Client
Highways England
Woodlands
Manton Lane
Manton Industrial Estate
Bedford
MK41 7LW

Working on behalf of
highways england

Development Consent Order Number
TR010044

Project Title
A428 BLACK CAT TO CAXTON GIBBET IMPROVEMENTS

Drawing Title
LAND PLANS REGULATION 5(2)(i) SHEET 10

Designed AECOM	Drawn GJ	Checked AP	Approved PG	Date 02/02/21
Internal Project No. 60541541			Suitability D7	
Scale @ A1 1:2500			Zone ZN3	

THIS DOCUMENT HAS BEEN PREPARED PURSUANT TO AND SUBJECT TO THE TERMS OF AECOM'S APPOINTMENT BY ITS CLIENT. AECOM ACCEPTS NO LIABILITY FOR ANY USE OF THIS DOCUMENT OTHER THAN BY ITS ORIGINAL CLIENT OR FOLLOWING AECOM'S EXPRESS AGREEMENT TO SUCH USE, AND ONLY FOR THE PURPOSES FOR WHICH IT WAS PREPARED AND PROVIDED.

Drawing Number HE551495	Highways England PIN -ARD	1 Originator -LSI	1 Volume -	Rev P05
Location ZN3_SW_Z_ZZ				1 Type 1 Role 1 Number -DR-DC-2210

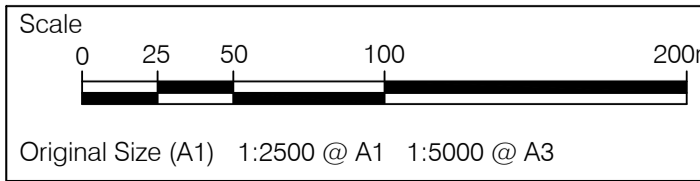

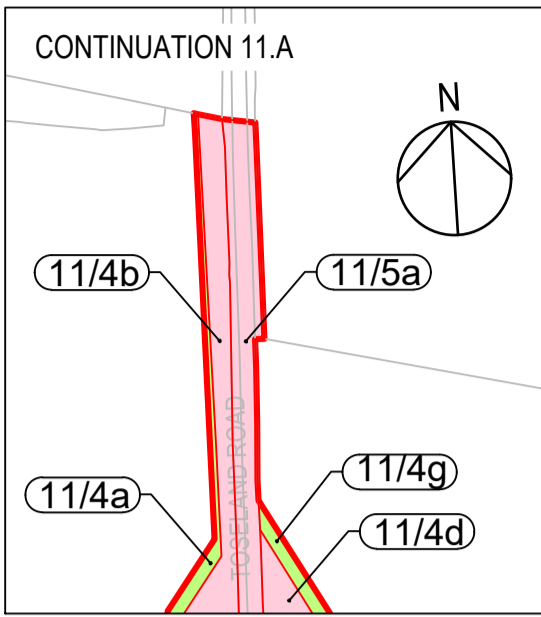

SEE CONTINUATION 11.A

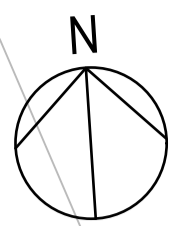

NOTES

1. ALL DIMENSIONS ARE IN METRES UNLESS STATED OTHERWISE.
2. DO NOT SCALE FROM THIS DRAWING, USE ONLY PRINTED DIMENSIONS.
3. ALL EASEMENTS, SERVITUDES AND PRIVATE RIGHTS ARE PROPOSED TO BE EXTINGUISHED ON LAND THAT IS TO BE ACQUIRED UNLESS STATED OTHERWISE IN THE BOOK OF REFERENCE.
4. THIS DRAWING IS TO BE READ IN CONJUNCTION WITH ALL OTHER PLANS AND DOCUMENTATION, IN PARTICULAR THE WORK PLANS [TR010044/APP/2.3] AND THE BOOK OF REFERENCE [TR010044/APP/4.3].

LEGEND

- ORDER LIMITS
- PERMANENT ACQUISITION
- TEMPORARY POSSESSION
- TEMPORARY POSSESSION AND ACQUISITION OF NEW RIGHTS
- EXCLUSION FROM ORDER LIMITS
- PARCEL NUMBERS
- ADMINISTRATIVE BOUNDARY

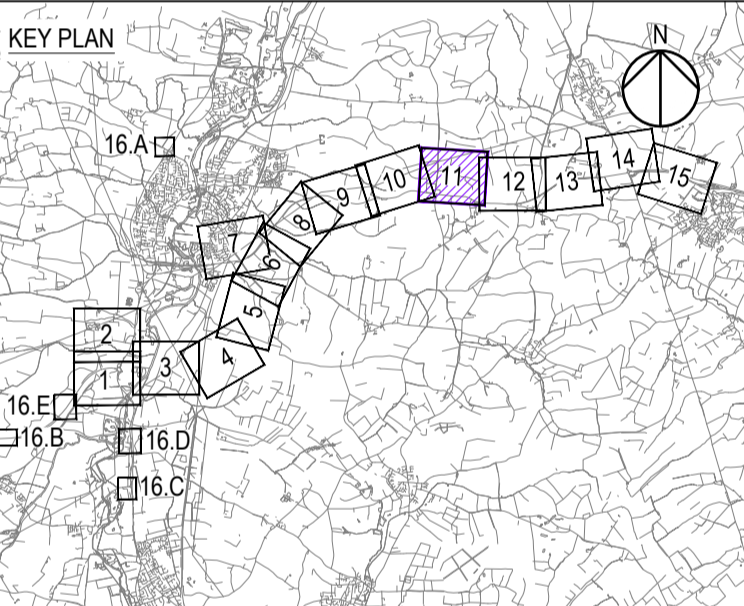

Final for DCO Application	GJ	02/02/21	P05
Revision Details	By	Date	Suffix
	Check		

DCO APPLICATION

Client
Highways England
Woodlands
Manton Lane
Manton Industrial Estate
Bedford
MK41 7LW



Development Consent Order Number
TR010044

Project Title
A428 BLACK CAT TO CAXTON GIBBET IMPROVEMENTS

Drawing Title
**LAND PLANS
REGULATION 5(2)(i)
SHEET 11**

Designed AECOM	Drawn GJ	Checked AP	Approved PG	Date 02/02/21
Internal Project No. 60541541			Suitability D7	
Scale @ A1 1:2500			Zone ZN4	

THIS DOCUMENT HAS BEEN PREPARED PURSUANT TO AND SUBJECT TO THE TERMS OF AECOM'S APPOINTMENT BY ITS CLIENT. AECOM ACCEPTS NO LIABILITY FOR ANY USE OF THIS DOCUMENT OTHER THAN BY ITS ORIGINAL CLIENT OR FOLLOWING AECOM'S EXPRESS AGREEMENT TO SUCH USE, AND ONLY FOR THE PURPOSES FOR WHICH IT WAS PREPARED AND PROVIDED.

Drawing Number HE551495	1 Originator -ARD	1 Volume -LSI	Rev P05
Location ZN4_SW_Z_ZZ -DR-DC-2211			1 Type 1 Role 1 Number

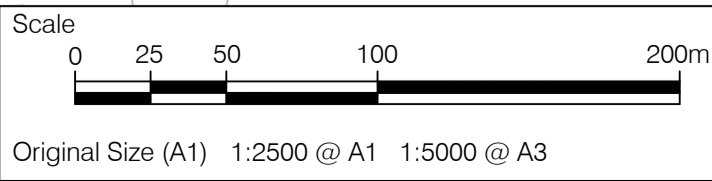

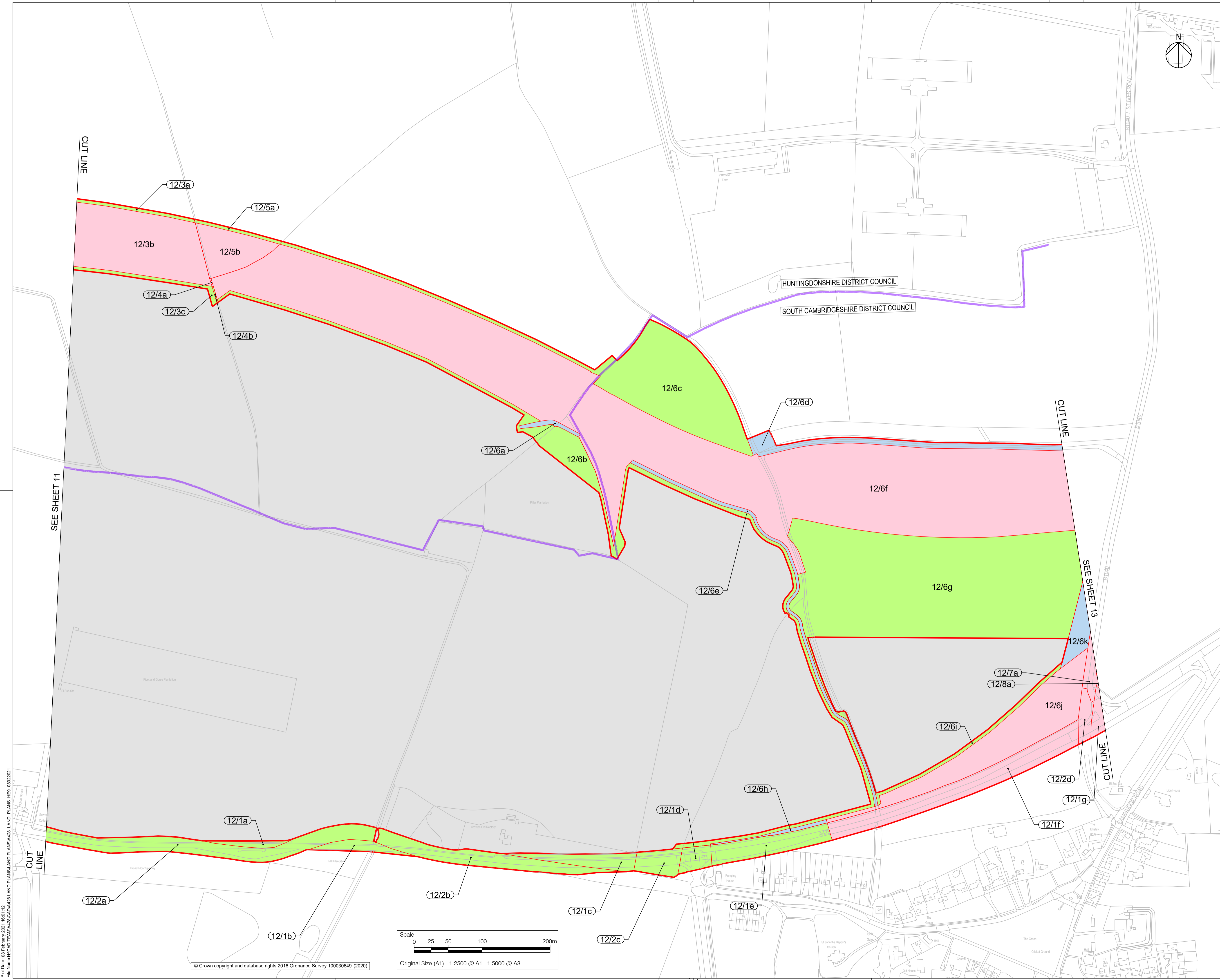

- NOTES
1. ALL DIMENSIONS ARE IN METRES UNLESS STATED OTHERWISE.
 2. DO NOT SCALE FROM THIS DRAWING, USE ONLY PRINTED DIMENSIONS.
 3. ALL EASEMENTS, SERVITUDES AND PRIVATE RIGHTS ARE PROPOSED TO BE EXTINGUISHED ON LAND THAT IS TO BE ACQUIRED UNLESS STATED OTHERWISE IN THE BOOK OF REFERENCE.
 4. THIS DRAWING IS TO BE READ IN CONJUNCTION WITH ALL OTHER PLANS AND DOCUMENTATION, IN PARTICULAR THE WORK PLANS [TR010044/APP/2.3] AND THE BOOK OF REFERENCE [TR010044/APP/4.3].

LEGEND

- ORDER LIMITS
- PERMANENT ACQUISITION
- TEMPORARY POSSESSION
- TEMPORARY POSSESSION AND ACQUISITION OF NEW RIGHTS
- EXCLUSION FROM ORDER LIMITS
- PARCEL NUMBERS
- ADMINISTRATIVE BOUNDARY

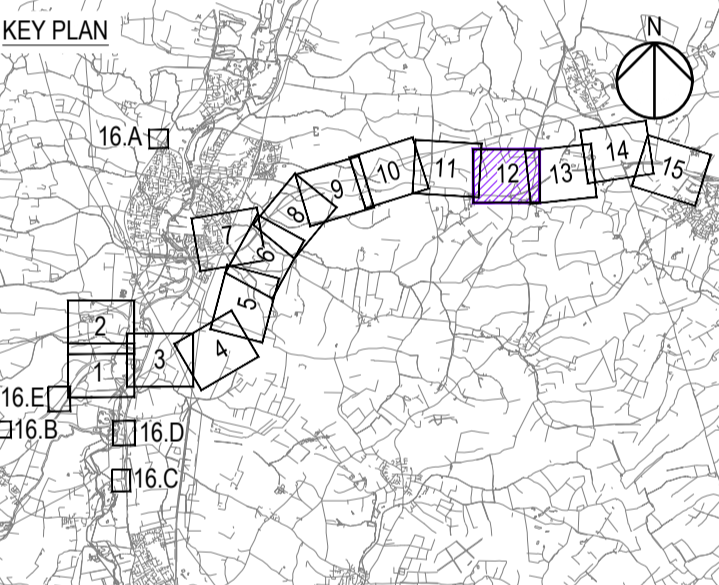

Final for DCO Application	GJ	AP	02/02/21	P05
Revision Details	By	Check	Date	Suffix

DCO APPLICATION

Client
Highways England
Woodlands
Manton Lane
Manton Industrial Estate
Bedford
MK41 7LW

Working on behalf of
highways england

Development Consent Order Number
TR010044

Project Title
A428 BLACK CAT TO CAXTON GIBBET IMPROVEMENTS

Drawing Title
LAND PLANS REGULATION 5(2)(i) SHEET 12

Designed AECOM	Drawn GJ	Checked AP	Approved PG	Date 02/02/21
Internal Project No. 60541541			Suitability D7	
Scale @ A1 1:2500			Zone ZN4	

THIS DOCUMENT HAS BEEN PREPARED PURSUANT TO AND SUBJECT TO THE TERMS OF AECOM'S APPOINTMENT BY ITS CLIENT. AECOM ACCEPTS NO LIABILITY FOR ANY USE OF THIS DOCUMENT OTHER THAN BY ITS ORIGINAL CLIENT OR FOLLOWING AECOM'S EXPRESS AGREEMENT TO SUCH USE, AND ONLY FOR THE PURPOSES FOR WHICH IT WAS PREPARED AND PROVIDED.

Drawing Number HE551495	1 Originator -ARD	1 Volume -LSI	Rev P05
Location ZN4_SW_Z_ZZ			1 Type 1 Role 1 Number -DR-DC-2212

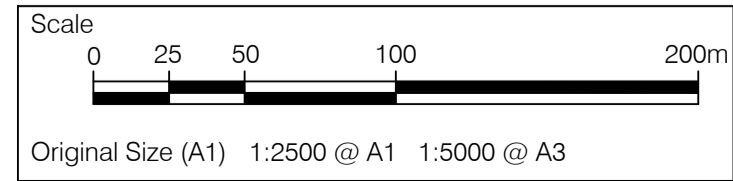

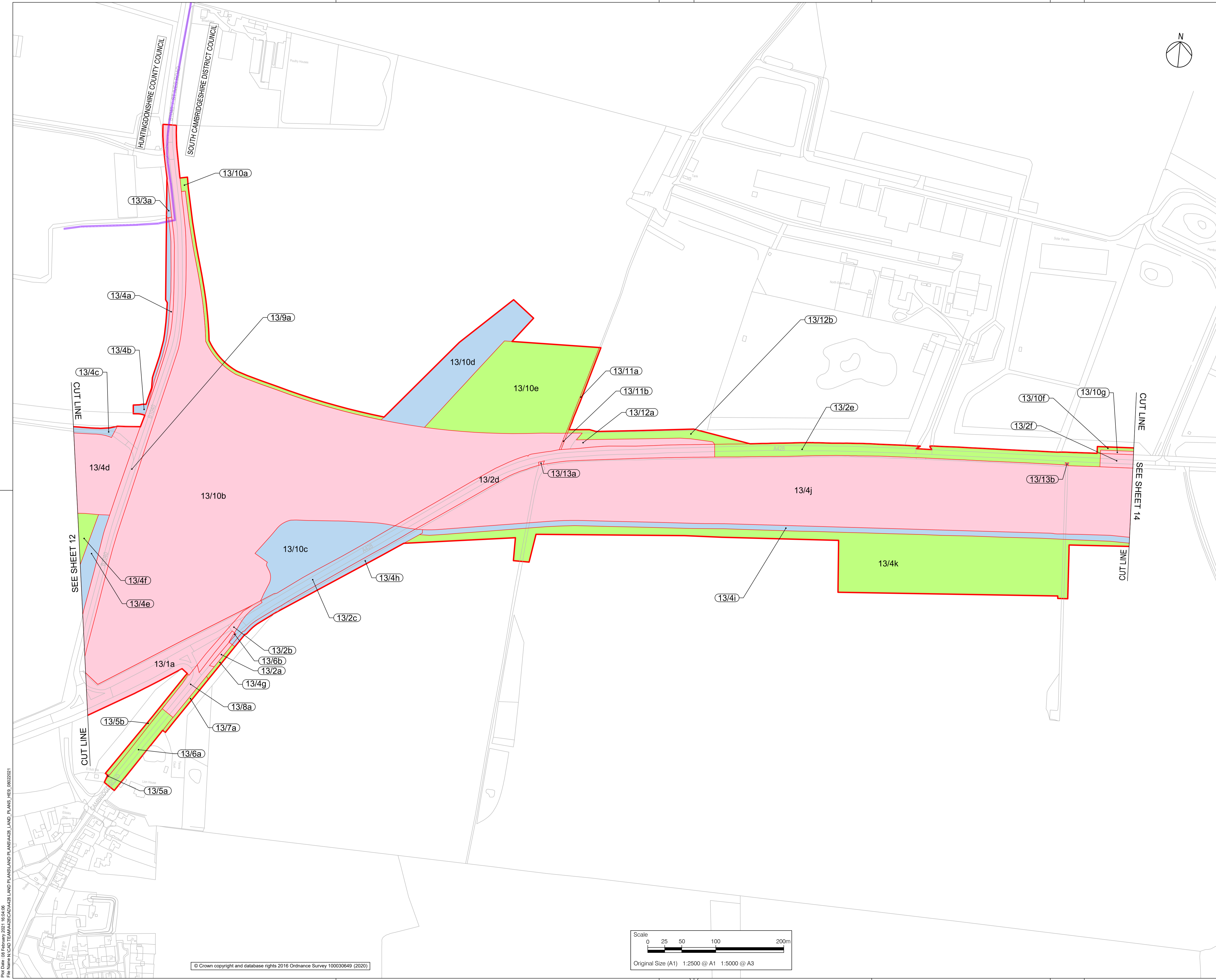

- NOTES
1. ALL DIMENSIONS ARE IN METRES UNLESS STATED OTHERWISE.
 2. DO NOT SCALE FROM THIS DRAWING, USE ONLY PRINTED DIMENSIONS.
 3. ALL EASEMENTS, SERVITUDES AND PRIVATE RIGHTS ARE PROPOSED TO BE EXTINGUISHED ON LAND THAT IS TO BE ACQUIRED UNLESS STATED OTHERWISE IN THE BOOK OF REFERENCE.
 4. THIS DRAWING IS TO BE READ IN CONJUNCTION WITH ALL OTHER PLANS AND DOCUMENTATION, IN PARTICULAR THE WORK PLANS [TR010044/APP/2.3] AND THE BOOK OF REFERENCE [TR010044/APP/4.3].

LEGEND

- ORDER LIMITS
- PERMANENT ACQUISITION
- TEMPORARY POSSESSION
- TEMPORARY POSSESSION AND ACQUISITION OF NEW RIGHTS
- EXCLUSION FROM ORDER LIMITS
- PARCEL NUMBERS
- ADMINISTRATIVE BOUNDARY

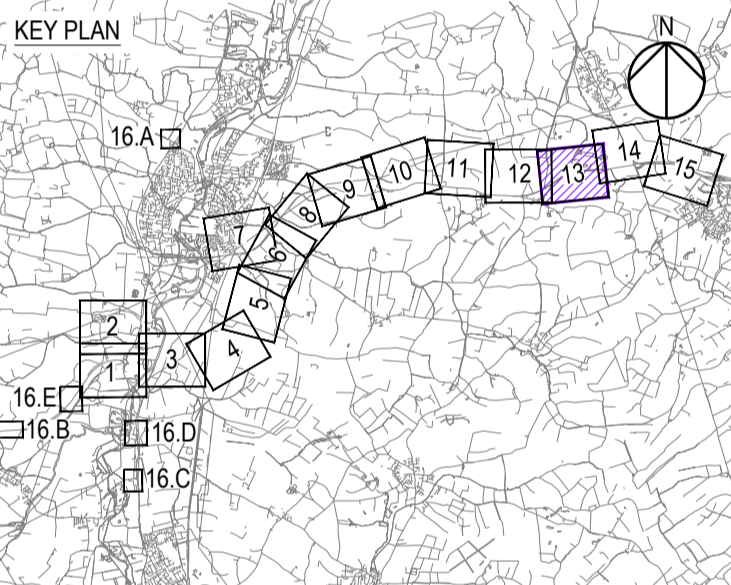

Final for DCO Application	GJ	02/02/21	P05
Revision Details	By	AP	Date
Purpose of issue	Check	Suffix	

DCO APPLICATION

Client
Highways England
Woodlands
Manton Lane
Manton Industrial Estate
Bedford
MK41 7LW

Working on behalf of
highways england

Development Consent Order Number
TR010044

Project Title
A428 BLACK CAT TO CAXTON GIBBET IMPROVEMENTS

Drawing Title
LAND PLANS REGULATION 5(2)(i) SHEET 13

Designed AECOM	Drawn GJ	Checked AP	Approved PG	Date 02/02/21
Internal Project No. 60541541			Suitability D7	
Scale @ A1 1:2500			Zone ZN4	

THIS DOCUMENT HAS BEEN PREPARED PURSUANT TO AND SUBJECT TO THE TERMS OF AECOM'S APPOINTMENT BY ITS CLIENT. AECOM ACCEPTS NO LIABILITY FOR ANY USE OF THIS DOCUMENT OTHER THAN BY ITS ORIGINAL CLIENT OR FOLLOWING AECOM'S EXPRESS AGREEMENT TO SUCH USE, AND ONLY FOR THE PURPOSES FOR WHICH IT WAS PREPARED AND PROVIDED.

Drawing Number HE551495 -ARD -LSI -	Highways England PIN ZN4_SW_Z_ZZ -DR-DC-2213	1 Originator 1 Volume 1 Type 1 Role 1 Number	Rev P05
--	---	--	------------

Rev Date: 18 February 2021 15:54:35
File Name: IN-CADD TEAM\A428\DCO\A428_LAND PLANS\HE5_09022021

© Crown copyright and database rights 2016 Ordnance Survey 100030649 (2020)

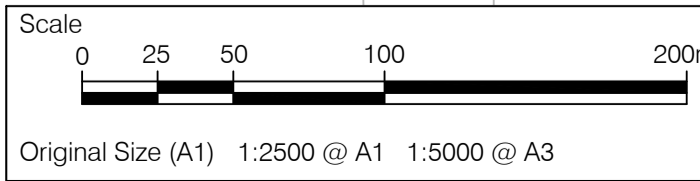

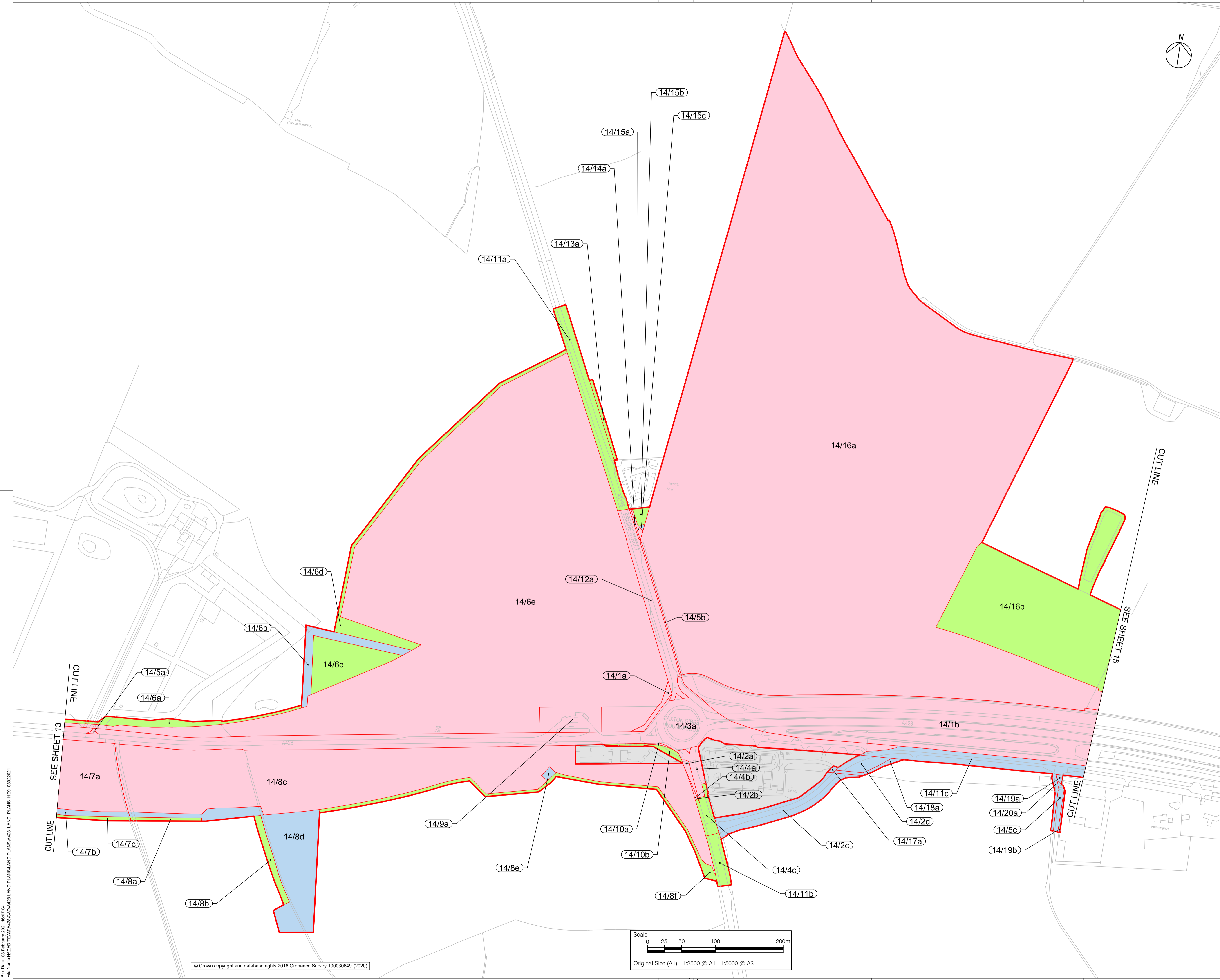

- NOTES
1. ALL DIMENSIONS ARE IN METRES UNLESS STATED OTHERWISE.
 2. DO NOT SCALE FROM THIS DRAWING, USE ONLY PRINTED DIMENSIONS.
 3. ALL EASEMENTS, SERVITUDES AND PRIVATE RIGHTS ARE PROPOSED TO BE EXTINGUISHED ON LAND THAT IS TO BE ACQUIRED UNLESS STATED OTHERWISE IN THE BOOK OF REFERENCE.
 4. THIS DRAWING IS TO BE READ IN CONJUNCTION WITH ALL OTHER PLANS AND DOCUMENTATION, IN PARTICULAR THE WORK PLANS [TR010044/APP/2.3] AND THE BOOK OF REFERENCE [TR010044/APP/4.3].

LEGEND

- ORDER LIMITS
- PERMANENT ACQUISITION
- TEMPORARY POSSESSION
- TEMPORARY POSSESSION AND ACQUISITION OF NEW RIGHTS
- EXCLUSION FROM ORDER LIMITS
- PARCEL NUMBERS
- ADMINISTRATIVE BOUNDARY

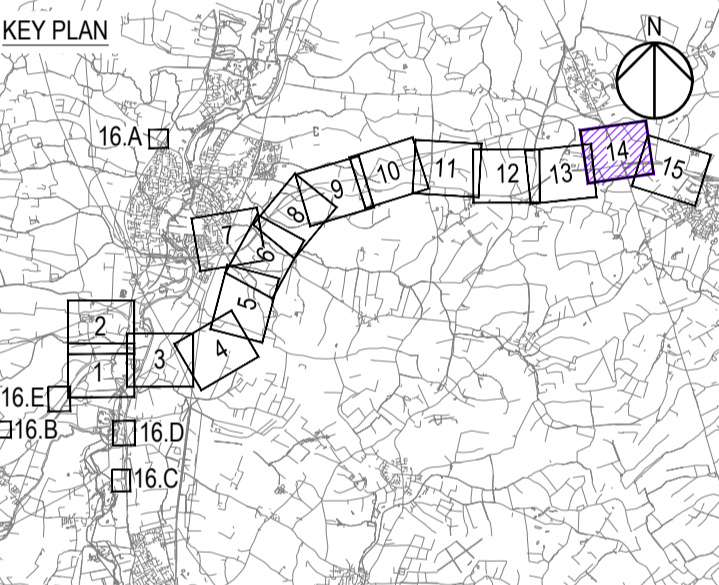

Final for DCO Application	GJ	AP	02/02/21	P05
Revision Details	By	Check	Date	Suffix

Purpose of issue

DCO APPLICATION

Client
Highways England
Woodlands
Manton Lane
Manton Industrial Estate
Bedford
MK41 7LW

Working on behalf of
highways england

Development Consent Order Number

TR010044

Project Title

A428 BLACK CAT TO CAXTON GIBBET IMPROVEMENTS

Drawing Title

**LAND PLANS
REGULATION 5(2)(i)
SHEET 14**

Designed AECOM	Drawn GJ	Checked AP	Approved PG	Date 02/02/21
Internal Project No. 60541541			Suitability D7	
Scale @ A1 1:2500			Zone ZN5	

THIS DOCUMENT HAS BEEN PREPARED PURSUANT TO AND SUBJECT TO THE TERMS OF AECOM'S APPOINTMENT BY ITS CLIENT. AECOM ACCEPTS NO LIABILITY FOR ANY USE OF THIS DOCUMENT OTHER THAN BY ITS ORIGINAL CLIENT OR FOLLOWING AECOM'S EXPRESS AGREEMENT TO SUCH USE, AND ONLY FOR THE PURPOSES FOR WHICH IT WAS PREPARED AND PROVIDED.

Drawing Number HE551495	Highways England PIN -ARD	I Originator -LSI	I Volume -	Rev P05
Location ZN5_SW_Z_ZZ				I Type -DR
I Role -DC				I Number 2214

Rev 004 - 18 February 2021 - 1:07:04
File Name: IN-CAD-TEMP\A428DCO\A428_LAND PLANS\HE5_09022021

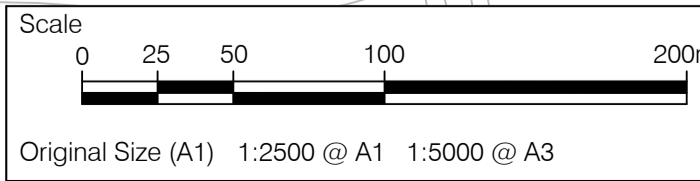



- NOTES
- ALL DIMENSIONS ARE IN METRES UNLESS STATED OTHERWISE.
 - DO NOT SCALE FROM THIS DRAWING, USE ONLY PRINTED DIMENSIONS.
 - ALL EASEMENTS, SERVITUDES AND PRIVATE RIGHTS ARE PROPOSED TO BE EXTINGUISHED ON LAND THAT IS TO BE ACQUIRED UNLESS STATED OTHERWISE IN THE BOOK OF REFERENCE.
 - THIS DRAWING IS TO BE READ IN CONJUNCTION WITH ALL OTHER PLANS AND DOCUMENTATION, IN PARTICULAR THE WORK PLANS [TR010044/APP/2.3] AND THE BOOK OF REFERENCE [TR010044/APP/4.3].

LEGEND

- ORDER LIMITS
- PERMANENT ACQUISITION
- TEMPORARY POSSESSION
- TEMPORARY POSSESSION AND ACQUISITION OF NEW RIGHTS
- EXCLUSION FROM ORDER LIMITS
- PARCEL NUMBERS
- ADMINISTRATIVE BOUNDARY

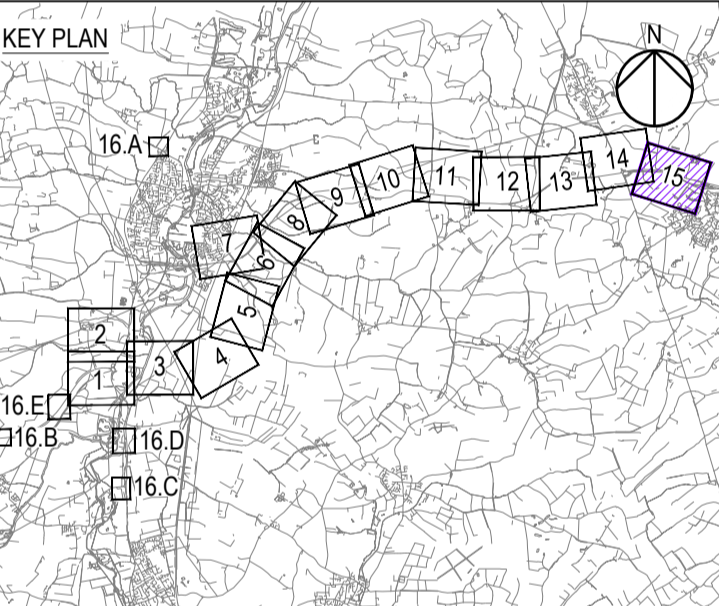

Final for DCO Application	GJ	AP	02/02/21	P05
Revision Details	By	Check	Date	Suffix

Purpose of issue

DCO APPLICATION

Client
Highways England
Woodlands
Manton Lane
Manton Industrial Estate
Bedford
MK41 7LW

Working on behalf of
highways england

Development Consent Order Number
TR010044

Project Title
A428 BLACK CAT TO CAXTON GIBBET IMPROVEMENTS

Drawing Title
LAND PLANS
REGULATION 5(2)(i)
SHEET 15

Designed AECOM	Drawn GJ	Checked AP	Approved PG	Date 02/02/21
Internal Project No. 60541541			Suitability D7	
Scale @ A1 1:2500			Zone ZN5	

THIS DOCUMENT HAS BEEN PREPARED PURSUANT TO AND SUBJECT TO THE TERMS OF AECOM'S APPOINTMENT BY ITS CLIENT. AECOM ACCEPTS NO LIABILITY FOR ANY USE OF THIS DOCUMENT OTHER THAN BY ITS ORIGINAL CLIENT OR FOLLOWING AECOM'S EXPRESS AGREEMENT TO SUCH USE, AND ONLY FOR THE PURPOSES FOR WHICH IT WAS PREPARED AND PROVIDED.

Drawing Number HE551495	Highways England PIN -ARD	I Originator -LSI	I Volume -	Rev P05
Location ZN5_SW_Z_ZZ				I Type -DR
I Role -DC				I Number 2215

Rev 0 Date: 08 February 2021 1:05:25
File Name: N:\CADD\TEMP\A428\DCO\A428_LAND PLANS\REG_09022021

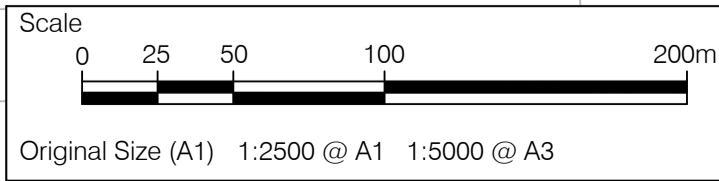

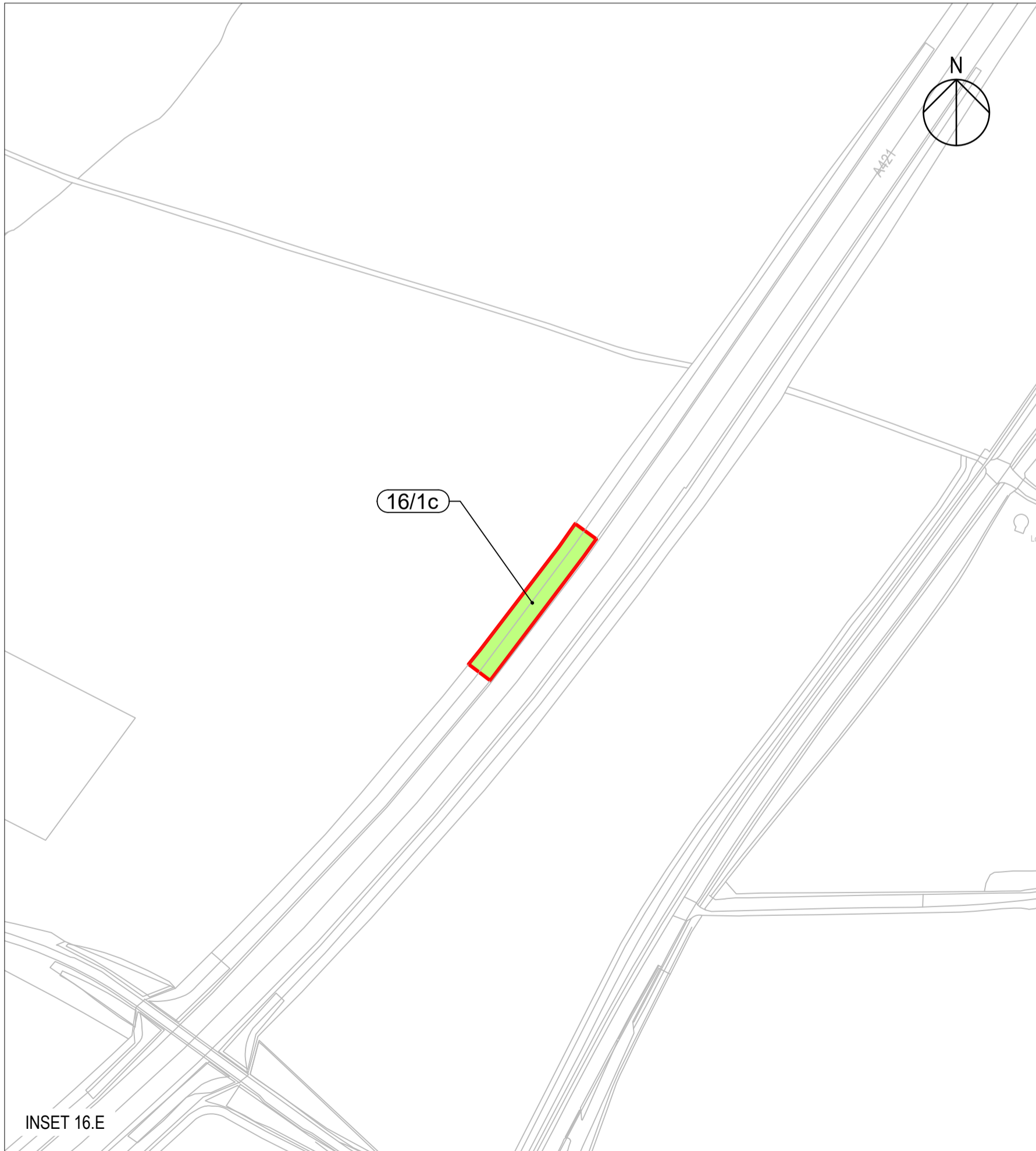
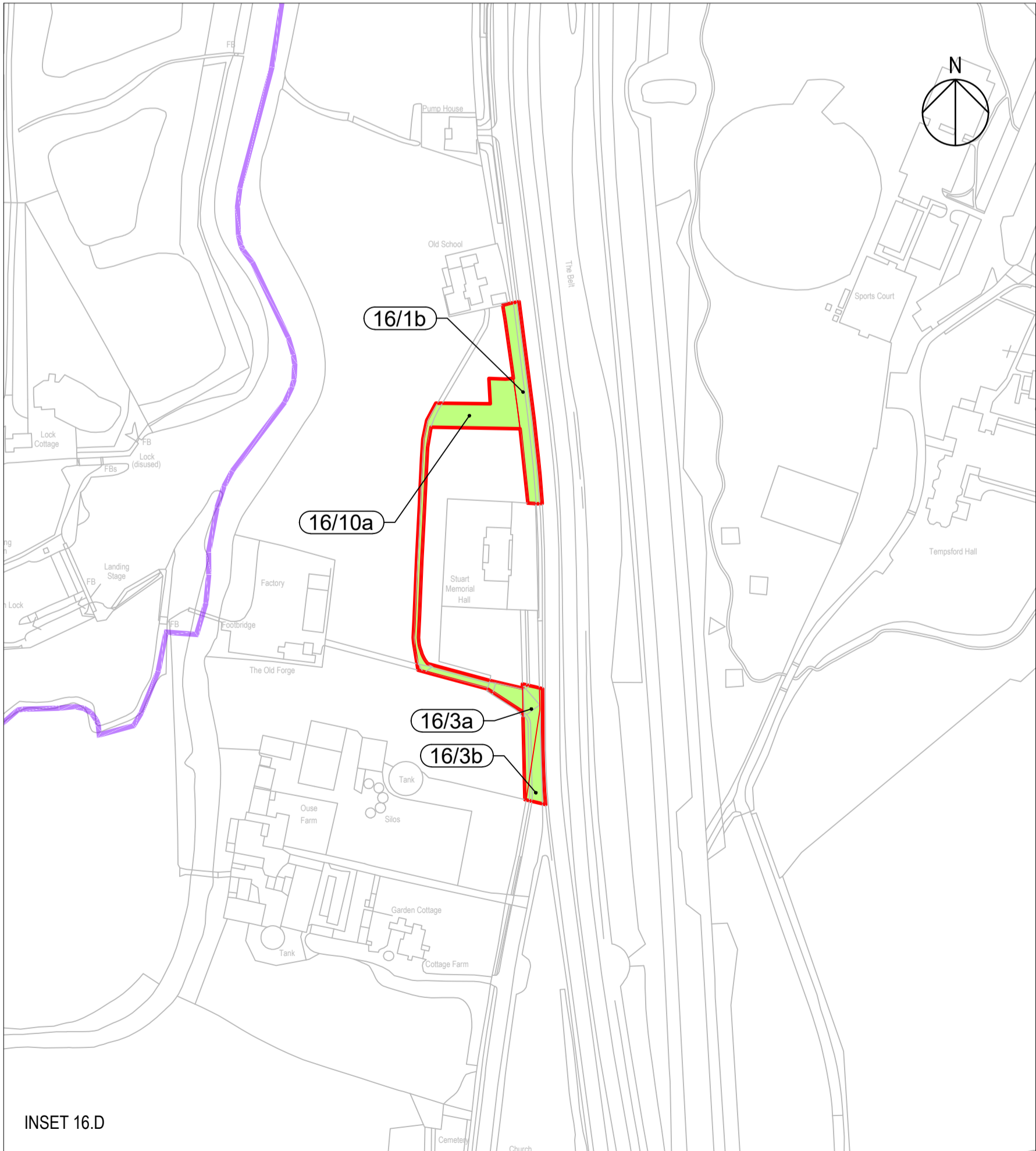
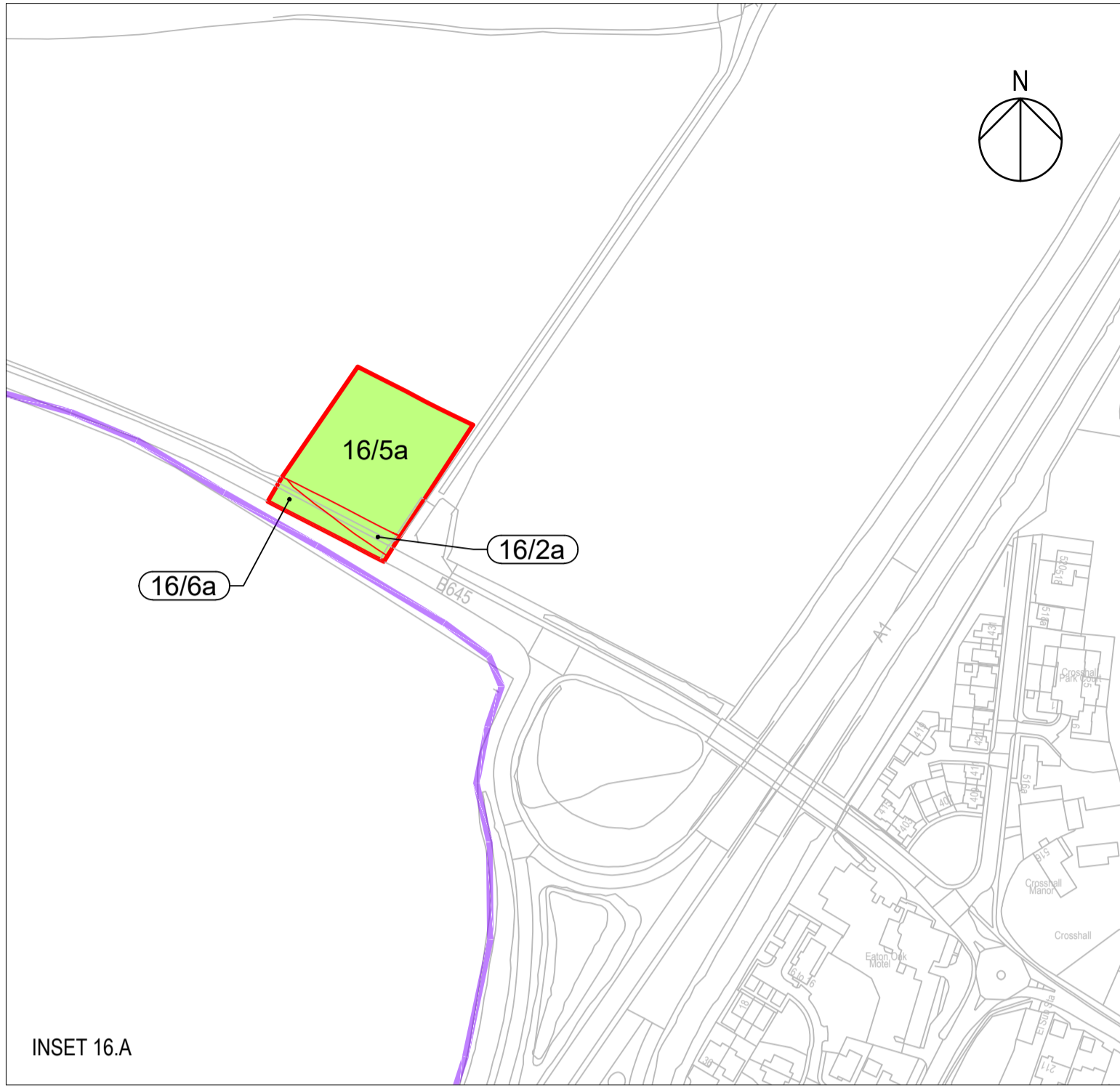

- NOTES
- ALL DIMENSIONS ARE IN METRES UNLESS STATED OTHERWISE.
 - DO NOT SCALE FROM THIS DRAWING, USE ONLY PRINTED DIMENSIONS.
 - ALL EASEMENTS, SERVITUDES AND PRIVATE RIGHTS ARE PROPOSED TO BE EXTINGUISHED ON LAND THAT IS TO BE ACQUIRED UNLESS STATED OTHERWISE IN THE BOOK OF REFERENCE.
 - THIS DRAWING IS TO BE READ IN CONJUNCTION WITH ALL OTHER PLANS AND DOCUMENTATION, IN PARTICULAR THE WORK PLANS [TR010044/APP/2.3] AND THE BOOK OF REFERENCE [TR010044/APP/4.3].

- LEGEND
- ORDER LIMITS
 - PERMANENT ACQUISITION
 - TEMPORARY POSSESSION
 - TEMPORARY POSSESSION AND ACQUISITION OF NEW RIGHTS
 - EXCLUSION FROM ORDER LIMITS
 - PARCEL NUMBERS
 - ADMINISTRATIVE BOUNDARY

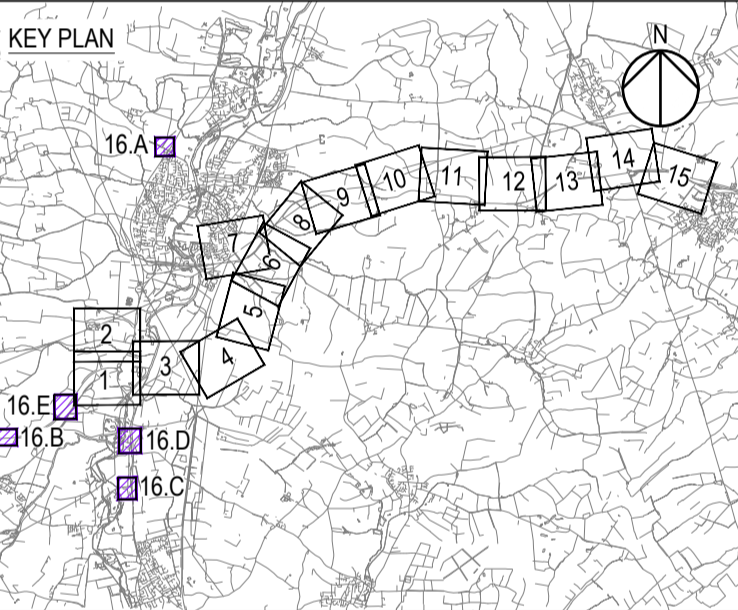

Final for DCO Application	GJ	AP	02/02/21
Revision Details	By	Check	Date
Purpose of issue			Suffix

DCO APPLICATION

Client
Highways England
Woodlands
Manton Lane
Manton Industrial Estate
Bedford
MK41 7LW



Development Consent Order Number
TR010044

Project Title
A428 BLACK CAT TO CAXTON GIBBET IMPROVEMENTS

Drawing Title
LAND PLANS REGULATION 5(2)(i) SHEET 16

Designed AECOM	Drawn GJ	Checked AP	Approved PG	Date 02/02/21
Internal Project No. 60541541			Suitability D7	
Scale @ A1 1:2500			Zone ZN5	

THIS DOCUMENT HAS BEEN PREPARED PURSUANT TO AND SUBJECT TO THE TERMS OF AECOM'S APPOINTMENT BY ITS CLIENT. AECOM ACCEPTS NO LIABILITY FOR ANY USE OF THIS DOCUMENT OTHER THAN BY ITS ORIGINAL CLIENT OR FOLLOWING AECOM'S EXPRESS AGREEMENT TO SUCH USE, AND ONLY FOR THE PURPOSES FOR WHICH IT WAS PREPARED AND PROVIDED.

Drawing Number HE551495	1 Originator -ARD	1 Volume -LSI	Rev P05
Location ZN5_SW_Z_ZZ	1 Type -DR	1 Role -DC	1 Number 2216

