

M54 to M6 Link Road
TR010054
Volume 2
2.2 Land Plans

Regulation 5(2)(i)

Planning Act 2008

Infrastructure Planning (Applications: Prescribed
Forms and Procedure) Regulations 2009

February 2021

Infrastructure Planning

Planning Act 2008

**The Infrastructure Planning
(Applications: Prescribed Forms and
Procedure) Regulations 2009**

M54 to M6 Link Road
Development Consent Order 202[]

Land Plans

Regulation Number	Regulation 5(2)(i)
Planning Inspectorate Scheme Reference	TR010054
Application Document Reference	2.2
Author	M54 to M6 Link Road Project Team and Highways England

Version	Date	Status of Version
P05	February 2021	Issued to the ExA at Deadline 6

1 Schedule of Plans in this Application Document

Drawing Number	Drawing Title	Revision
HE514465-GHX-LLO-M54_SW_PR_Z-DR-LR-1000	LAND PLANS REGUATION 5(2)(i) KEY SHEET TR010054/APP/2.2	P06
HE514465-GHX-LLO-Z1_SW_PR_Z-DR-LR-1001	LAND PLANS REGULATION 5(2)(i) SHEET 1 OF 10 TR010054/APP/2.2	P08
HE514465-GHX-LLO-Z1_SW_PR_Z-DR-LR-1002	LAND PLANS REGULATION 5(2)(i) SHEET 2 OF 10 TR010054/APP/2.2	P07
HE514465-GHX-LLO-Z1_SW_PR_Z-DR-LR-1003	LAND PLANS REGULATION 5(2)(i) SHEET 3 OF 10 TR010054/APP/2.2	P07
HE514465-GHX-LLO-Z1_SW_PR_Z-DR-LR-1004	LAND PLANS REGULATION 5(2)(i) SHEET 4 OF 10 TR010054/APP/2.2	P09
HE514465 -GHX -LLO Z2_SW_PR_Z -DR-LR-1005	LAND PLANS REGULATION 5(2)(i) SHEET 5 OF 10 TR010054/APP/2.2	P10
HE514465 -GHX -LLO Z2_SW_PR_Z -DR-LR-1006	LAND PLANS REGULATION 5(2)(i) SHEET 6 OF 10 TR010054/APP/2.2	P10
HE514465-GHX-LLO-Z3_SW_PR_Z-DR-LR-1007	LAND PLANS REGULATION 5(2)(i) SHEET 7 OF 10 TR010054/APP/2.2	P07
HE514465-GHX-LLO-Z3_SW_PR_Z-DR-LR-1008	LAND PLANS REGULATION 5(2)(i) SHEET 8 OF 10 TR010054/APP/2.2	P07
HE514465-GHX-LLO-Z3_SW_PR_Z-DR-LR-1009	LAND PLANS REGULATION 5(2)(i) SHEET 9 OF 10 TR010054/APP/2.2	P07
HE514465-GHX-LLO-Z3_SW_PR_Z-DR-LR-1010	LAND PLANS REGULATION 5(2)(i) SHEET 10 OF 10 TR010054/APP/2.2	P07



This map is reproduced from Ordnance Survey material with the permission of Ordnance Survey on behalf of the Controller of Her Majesty's Stationary Office © Crown copyright. Unauthorised reproduction infringes Crown copyright and may lead to prosecution or civil proceedings. Highways England 100030648/2019.

- NOTES
1. ALL DIMENSIONS IN METRES UNLESS STATED OTHERWISE.
 2. DO NOT SCALE FROM THIS DRAWING, USE ONLY PRINTED DIMENSIONS.
 3. ALL EASEMENTS, SERVITUDES AND PRIVATE RIGHTS ARE PROPOSED TO BE EXTINGUISHED ON LAND THAT IS TO BE ACQUIRED UNLESS STATED OTHERWISE IN THE BOOK OF REFERENCE.
 4. THIS DRAWING IS TO BE READ IN CONJUNCTION WITH ALL OTHER PLANS AND DOCUMENTATION, IN PARTICULAR THE WORK PLANS AND THE BOOK OF REFERENCE.
 5. THIS PLAN WAS AMENDED IN MAY 2020 TO REMOVE A SMALL AREA OF THE ORDER LIMITS WITHIN THE HIGHWAY BOUNDARY OF THE M54 PREVIOUSLY INCLUDED FOR THE REPLACEMENT OF A ROAD SIGN. THE REPLACEMENT OF THIS SIGN IS NO LONGER REQUIRED. THIS CHANGE MEANS THAT SHROPSHIRE COUNTY COUNCIL IS NO LONGER A HOST AUTHORITY FOR THE SCHEME.

- KEY
- LIMITS OF LAND TO BE ACQUIRED OR USED PERMANENTLY OR TEMPORARILY (THE ORDER LIMITS)
 - LAND NOT INCLUDED WITHIN THE ORDER LIMITS

First Issue	LD	SM	12/12/19	P01
Minor amendments to drawing frame	CH	SM	17/01/20	P02
Minor drawing frame amendments	CH	SM	24/01/20	P03
Inset A removed	CH	SM	24/02/20	P04
Notes amended on drawing frame	CH	SM	18/05/20	P05
OS Mapping & label amended	CG	TT	29/09/20	P06
Revision Details		By	Check	Date
				Suffix

Purpose of issue

DCO APPLICATION

Client

Highways England
2 Colmore Square
38 Colmore Circus
Birmingham
B4 6BN

Development Consent Order Number

TR010054

Project Title

M54 to M6
Link Road

Development Consent Order Drawing Number

TR010054/APP/2.2

Drawing Title

LAND PLANS
REGULATION 5(2)(i)
KEY SHEET

Designed SM	Drawn CG	Checked TF	Approved SM	Date 29/09/20
----------------	-------------	---------------	----------------	------------------

Internal Project No. 60536736	Suitability SB
Scale @ A1 1:20,000	Zone Development Consent Order

THIS DOCUMENT HAS BEEN PREPARED PURSUANT TO AND SUBJECT TO THE TERMS OF AECOM'S APPOINTMENT BY ITS CLIENT. AECOM ACCEPTS NO LIABILITY FOR ANY USE OF THIS DOCUMENT OTHER THAN BY ITS ORIGINAL CLIENT OR FOLLOWING AECOM'S EXPRESS AGREEMENT TO SUCH USE, AND ONLY FOR THE PURPOSES FOR WHICH IT WAS PREPARED AND PROVIDED.

Drawing Number HE514465	Highways England PIN -GHX	Originator -LLO	Volume -DR-LR-1000	Rev P06
Location M54_SW_PR_Z				Type Role Number



This map is reproduced from Ordnance Survey material with the permission of Ordnance Survey on behalf of the Controller of Her Majesty's Stationary Office © Crown copyright. Unauthorised reproduction infringes Crown copyright and may lead to prosecution or civil proceedings. Highways England 100030649/2019

NOTES

1. ALL DIMENSIONS IN METRES UNLESS STATED OTHERWISE.

2. DO NOT SCALE FROM THIS DRAWING, USE ONLY PRINTED DIMENSIONS.

3. ALL EASEMENTS, SERVITUDES AND PRIVATE RIGHTS ARE PROPOSED TO BE EXTINGUISHED ON LAND THAT IS TO BE ACQUIRED UNLESS STATED OTHERWISE IN THE BOOK OF REFERENCE.

4. THIS DRAWING IS TO BE READ IN CONJUNCTION WITH ALL OTHER PLANS AND DOCUMENTATION, IN PARTICULAR THE WORK PLANS AND THE BOOK OF REFERENCE.

5. THIS PLAN WAS AMENDED IN MAY 2020 TO REMOVE A SMALL AREA OF THE ORDER LIMITS WITHIN THE HIGHWAY BOUNDARY OF THE M54 PREVIOUSLY INCLUDED FOR THE REPLACEMENT OF A ROAD SIGN. THE REPLACEMENT OF THIS SIGN IS NO LONGER REQUIRED. THIS CHANGE MEANS THAT SHROPSHIRE COUNTY COUNCIL IS NO LONGER A HOST AUTHORITY FOR THE SCHEME.

KEY

— LIMITS OF LAND TO BE ACQUIRED OR USED PERMANENTLY OR TEMPORARILY (THE ORDER LIMITS)

— PLOT REFERENCE NUMBER (REFER TO BOOK OF REFERENCE FOR FURTHER INFORMATION)

LAND NOT INCLUDED WITHIN THE ORDER LIMITS

LAND TO BE ACQUIRED

LAND TO BE USED

LAND TO BE USED TEMPORARILY AND RIGHTS TO BE ACQUIRED PERMANENTLY

NO POWERS SOUGHT IN DCO

First issue	LD	SM	21/10/19	P01
Update following client review	LD	SM	05/11/19	P02
Minor amendments to drawing frame	LD	SM	22/11/19	P03
Pre DCO Submission Amendments	LD	SM	16/12/19	P04
Plot amendments following client review	CH	SM	16/01/20	P05
Updates to plot numbers and minor drawing frame amendments	CH	SM	24/01/20	P06
Inset A Removed	CH	SM	24/02/20	P07
Notes amended on drawing frame	CH	SM	18/05/20	P08
Revision Details	By	Check	Date	Suffix

Purpose of issue

DCO APPLICATION

Client

Highways England
2 Colmore Square
38 Colmore Circus
Birmingham
B4 6BN

Development Consent Order Number

TR010054

Project Title

M54 to M6
Link Road

Development Consent Order Drawing Number

TR010054/APP/2.2

Drawing Title

LAND PLANS
REGULATION 5(2)(i)
SHEET 1 OF 10

Designed SM	Drawn CH	Checked JB	Approved SM	Date 18/05/20
----------------	-------------	---------------	----------------	------------------

Internal Project No.
60536736

Suitability
S8

Scale @ A1
1:2500

Zone
Development Consent Order

THIS DOCUMENT HAS BEEN PREPARED PURSUANT TO AND SUBJECT TO THE TERMS OF AECOM'S APPOINTMENT BY ITS CLIENT. AECOM ACCEPTS NO LIABILITY FOR ANY USE OF THIS DOCUMENT OTHER THAN BY ITS ORIGINAL CLIENT OR FOLLOWING AECOM'S EXPRESS AGREEMENT TO SUCH USE, AND ONLY FOR THE PURPOSES FOR WHICH IT WAS PREPARED AND PROVIDED.

Drawing Number Highways England PIN HE514465	Originator -GHX	Volume -LLO	Rev P08
Z1_SW_PR_Z	-DR-LR-1001		
Location	Type	Role	Number

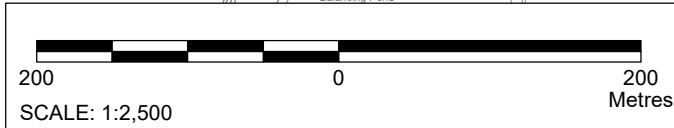

NO POWERS SOUGHT IN DCO

200 0 200
SCALE: 1:2,500 Metres

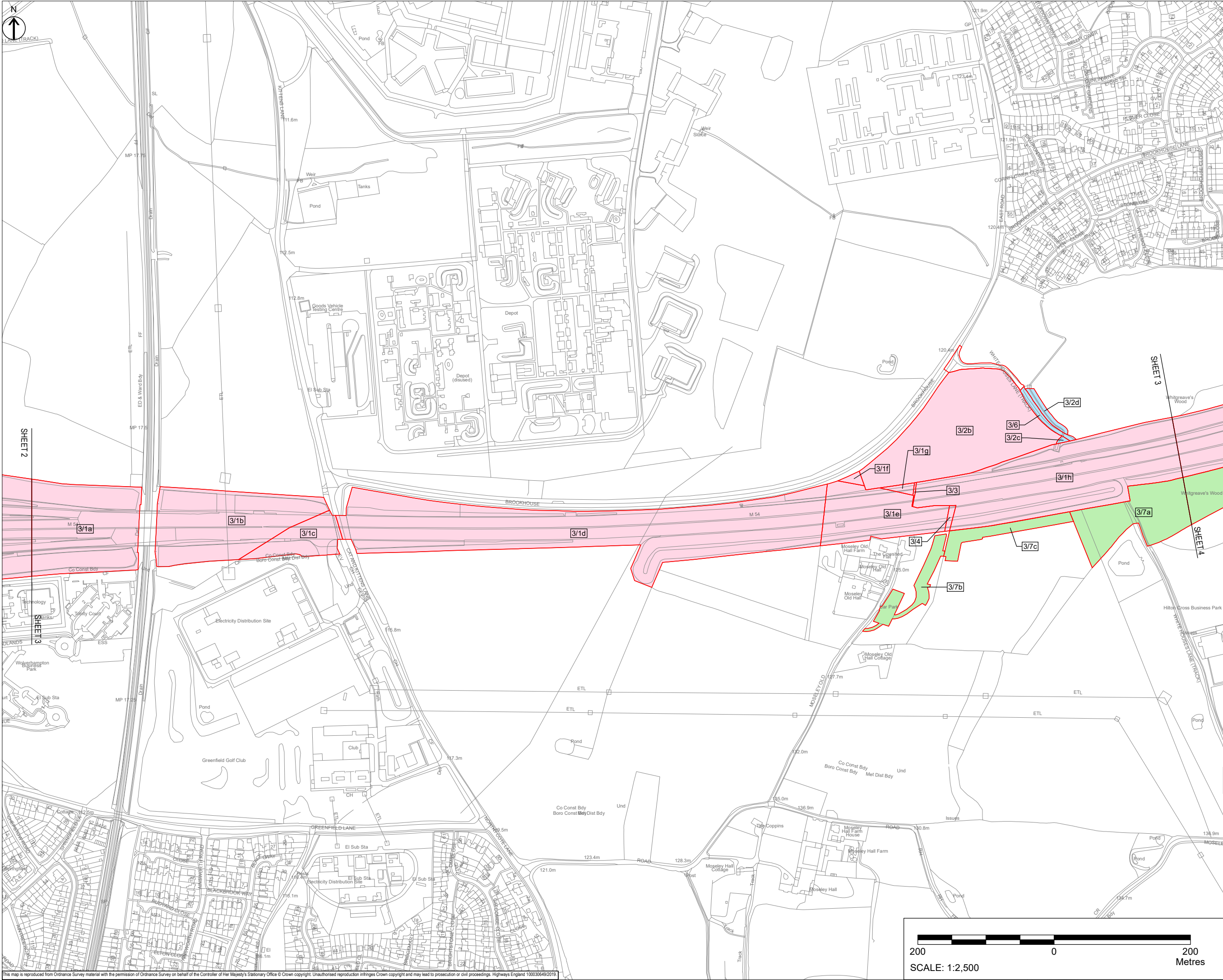

NOTES

1. ALL DIMENSIONS IN METRES UNLESS STATED OTHERWISE.
2. DO NOT SCALE FROM THIS DRAWING, USE ONLY PRINTED DIMENSIONS.
3. ALL EASEMENTS, SERVITUDES AND PRIVATE RIGHTS ARE PROPOSED TO BE EXTINGUISHED ON LAND THAT IS TO BE ACQUIRED UNLESS STATED OTHERWISE IN THE BOOK OF REFERENCE.
4. THIS DRAWING IS TO BE READ IN CONJUNCTION WITH ALL OTHER PLANS AND DOCUMENTATION, IN PARTICULAR THE WORK PLANS AND THE BOOK OF REFERENCE.

KEY

- LIMITS OF LAND TO BE ACQUIRED OR USED PERMANENTLY OR TEMPORARILY (THE ORDER LIMITS)
- PLOT REFERENCE NUMBER (REFER TO BOOK OF REFERENCE FOR FURTHER INFORMATION)
- LAND NOT INCLUDED WITHIN THE ORDER LIMITS
- LAND TO BE ACQUIRED
- LAND TO BE USED TEMPORARILY
- LAND TO BE USED TEMPORARILY AND RIGHTS TO BE ACQUIRED PERMANENTLY
- NO POWERS SOUGHT IN DCO

First Issue	LD	SM	21/10/19	P01
Update following client review	LD	SM	05/11/19	P02
Minor amendments to drawing frame	LD	SM	22/11/19	P03
Pre DCO Submission Amendments	LD	SM	16/12/19	P04
Plot amendments following client review	CH	SM	16/01/20	P05
Updates to plot numbers and minor drawing frame amendments	CH	SM	24/01/20	P06
Notes amended on drawing frame	CH	SM	18/05/20	P07
Revision Details	By	Check	Date	Suffix

Purpose of issue

DCO APPLICATION

Client
Highways England
2 Colmore Square
38 Colmore Circus
Birmingham
B4 6BN

Development Consent Order Number
TR010054

Project Title
M54 to M6 Link Road

Development Consent Order Drawing Number
TR010054/APP/2.2

Drawing Title
**LAND PLANS
REGULATION 5(2)(i)
SHEET 3 OF 10**

Designed SM	Drawn CH	Checked JB	Approved SM	Date 18/05/20
Internal Project No. 60536736		Suitability S8		
Scale @ A1 1:2500		Zone Development Consent Order		

THIS DOCUMENT HAS BEEN PREPARED PURSUANT TO AND SUBJECT TO THE TERMS OF AECOM'S APPOINTMENT BY ITS CLIENT. AECOM ACCEPTS NO LIABILITY FOR ANY USE OF THIS DOCUMENT OTHER THAN BY ITS ORIGINAL CLIENT OR FOLLOWING AECOM'S EXPRESS AGREEMENT TO SUCH USE, AND ONLY FOR THE PURPOSES FOR WHICH IT WAS PREPARED AND PROVIDED.

Drawing Number HE514465	Originator -GHX	Volume -LLO	Rev P07
Location Z1_SW_PR_Z	Type -DR-LR-1003	Role -DR-LR-1003	Number

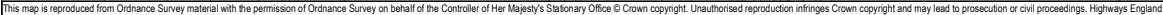

Drawing Number		Originator		Volume		Rev	
Highways England PIN							
HE514465		-GHX		-LLO			
Z1_SW_PR_Z				-DR-LR-1004			
Location		Type		Role		Number	

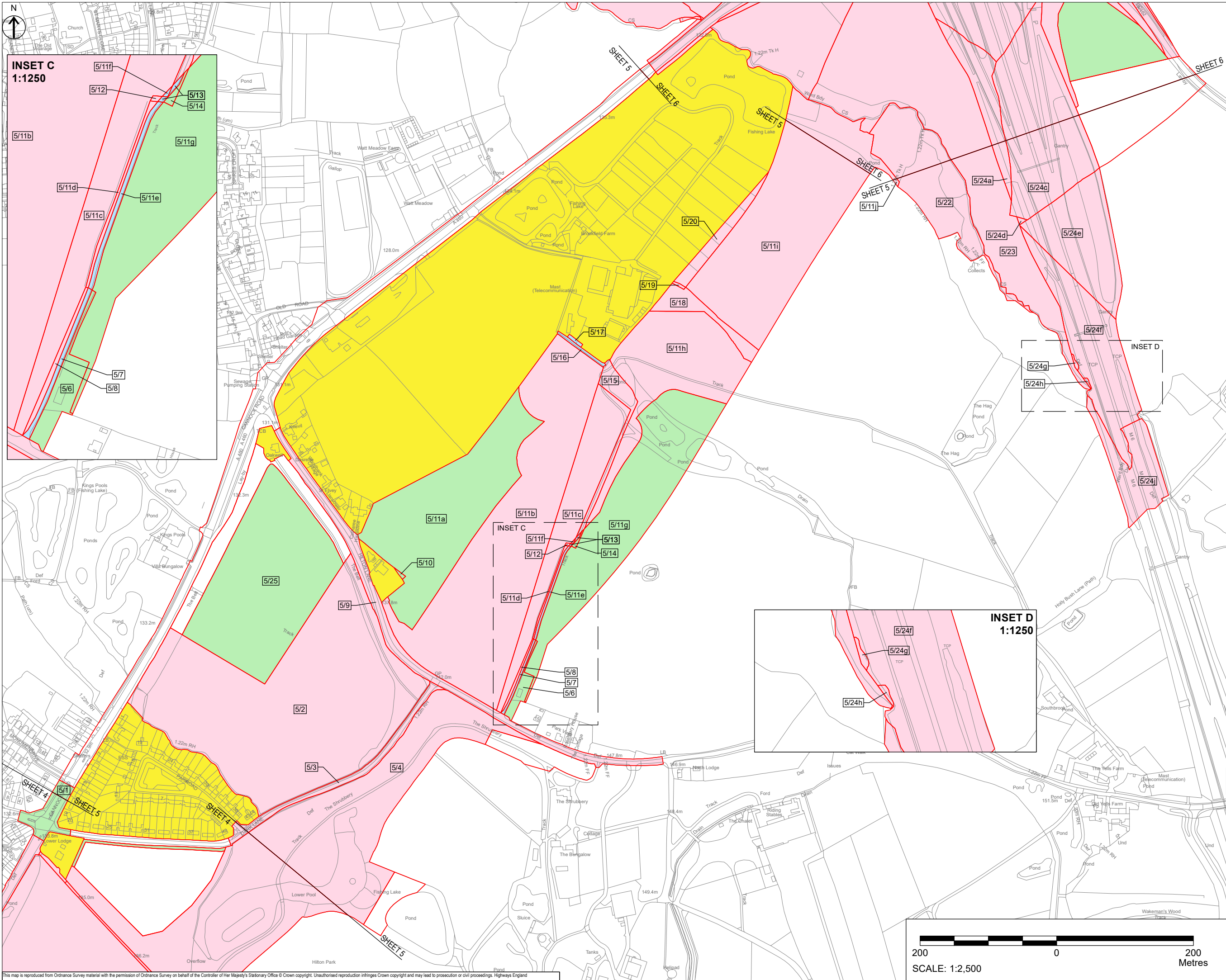

NOTES

1. ALL DIMENSIONS IN METRES UNLESS STATED OTHERWISE.

2. DO NOT SCALE FROM THIS DRAWING, USE ONLY PRINTED DIMENSIONS.

3. ALL EASEMENTS, SERVITUDES AND PRIVATE RIGHTS ARE PROPOSED TO BE EXTINGUISHED ON LAND THAT IS TO BE ACQUIRED UNLESS STATED OTHERWISE IN THE BOOK OF REFERENCE.

4. THIS DRAWING IS TO BE READ IN CONJUNCTION WITH ALL OTHER PLANS AND DOCUMENTATION, IN PARTICULAR THE WORK PLANS AND THE BOOK OF REFERENCE.

KEY

— LIMITS OF LAND TO BE ACQUIRED OR USED PERMANENTLY OR TEMPORARILY (THE ORDER LIMITS)

— PLOT REFERENCE NUMBER (REFER TO BOOK OF REFERENCE FOR FURTHER INFORMATION)

LAND NOT INCLUDED WITHIN THE ORDER LIMITS

LAND TO BE ACQUIRED

LAND TO BE USED TEMPORARILY

LAND TO BE USED TEMPORARILY AND RIGHTS TO BE ACQUIRED PERMANENTLY

NO POWERS SOUGHT IN DCO

First Issue	LD	SM	21/10/19	P01
Update following client review	LD	SM	05/11/19	P02
Minor amendments to drawing frame	LD	SM	22/11/19	P03
Pre DCO Submission Amendments	LD	SM	16/12/19	P04
Plot amendments following client review	CH	SM	16/01/20	P05
Updates to plot numbers and minor drawing frame amendments	CH	SM	24/01/20	P06
Notes amended on drawing frame	CH	SM	18/05/20	P07
Land parcels and land take requirements amended to reflect Scheme changes submitted to the ExA in October 2020	CG	SM	28/09/20	P08
Sheet updated to reflect parcel changes made beyond the cut line on Sheet 6	CG	SM	14/12/20	P09
Sheet updated to reflect parcel changes made beyond the cut line on Sheet 4	AH	SM	09/02/21	P10
Revision Details	By	Check	Date	Suffix

Purpose of issue

DCO APPLICATION

Client

Highways England

2 Colmore Square

38 Colmore Circus

Birmingham

B4 6BN

Development Consent Order Number

TR010054

Project Title

M54 to M6 Link Road

Development Consent Order Drawing Number

TR010054/APP/2.2

Drawing Title

LAND PLANS

REGULATION 5(2)(i)

SHEET 5 OF 10

Designed	SM	Drawn	AH	Checked	TF	Approved	SM	Date	09/02/21
Internal Project No.	60536736	Suitability	—						
Scale @ A1	1:2500	Zone	Whole Site						

THIS DOCUMENT HAS BEEN PREPARED PURSUANT TO AND SUBJECT TO THE TERMS OF AECOM'S APPOINTMENT BY ITS CLIENT. AECOM ACCEPTS NO LIABILITY FOR ANY USE OF THIS DOCUMENT OTHER THAN BY ITS ORIGINAL CLIENT OR FOLLOWING AECOM'S EXPRESS AGREEMENT TO SUCH USE, AND ONLY FOR THE PURPOSES FOR WHICH IT WAS PREPARED AND PROVIDED.

Drawing Number	HE514465	Originator	-GHX	Volume	-LLO	Rev	P10
Location	Z2_SW_PR_Z	Type	-DR-LR-1005	Role			

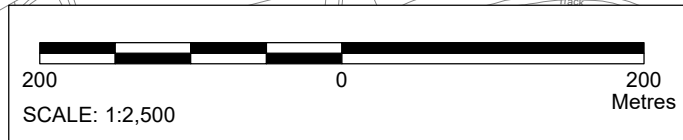

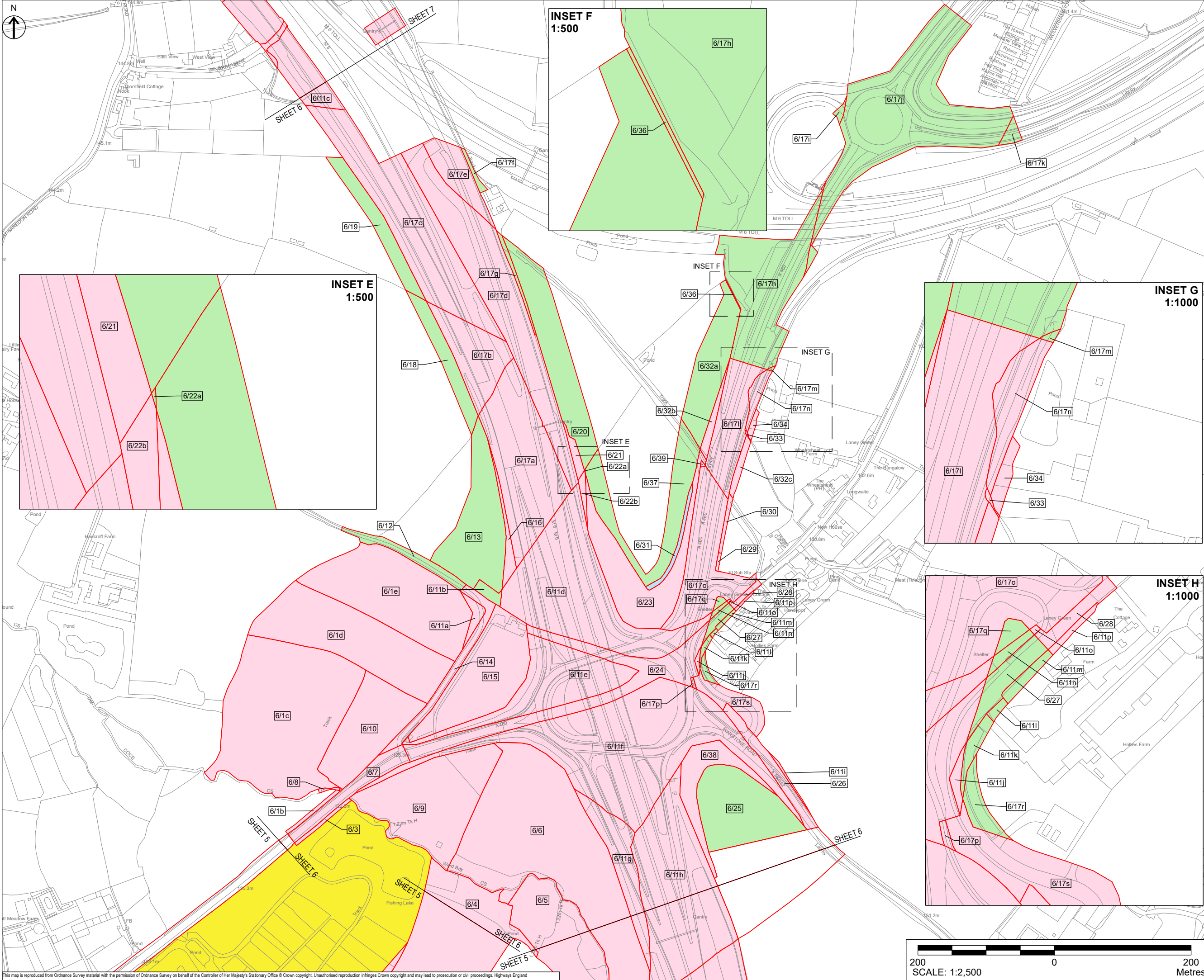

- NOTES
1. ALL DIMENSIONS IN METRES UNLESS STATED OTHERWISE.
 2. DO NOT SCALE FROM THIS DRAWING. USE ONLY PRINTED DIMENSIONS.
 3. ALL EASEMENTS, SERVITUDES AND PRIVATE RIGHTS ARE PROPOSED TO BE EXTINGUISHED ON LAND THAT IS TO BE ACQUIRED UNLESS STATED OTHERWISE IN THE BOOK OF REFERENCE.
 4. THIS DRAWING IS TO BE READ IN CONJUNCTION WITH ALL OTHER PLANS AND DOCUMENTATION, IN PARTICULAR THE WORK PLANS AND THE BOOK OF REFERENCE.
- KEY
- LIMITS OF LAND TO BE ACQUIRED OR USED PERMANENTLY OR TEMPORARILY (THE ORDER LIMITS)
 - PLOT REFERENCE NUMBER (REFER TO BOOK OF REFERENCE FOR FURTHER INFORMATION)
 - LAND NOT INCLUDED WITHIN THE ORDER LIMITS
 - LAND TO BE ACQUIRED
 - LAND TO BE USED
 - LAND TO BE USED TEMPORARILY AND RIGHTS TO BE ACQUIRED PERMANENTLY
 - NO POWERS SOUGHT IN DCO

First Issue	LD	SM	21/10/19	P01
Update following client review	LD	SM	05/11/19	P02
Minor amendments to drawing frame	LD	SM	22/11/19	P03
Pre DCO Submission Amendments	LD	SM	16/12/19	P04
Plot amendments following client review	CH	SM	16/01/20	P05
Updates to plot numbers and minor drawing frame amendments	CH	SM	24/01/20	P06
Notes amended on drawing frame	CH	SM	18/05/20	P07
Land parcels and land take requirements amended to reflect Scheme changes submitted to the Ex in October 2020	CG	SM	10/09/20	P08
New parcel 6/38 created to accommodate permanent land take required for junction	CG	SM	14/12/20	P09
Land parcels amended to add plot 6/39	AH	SM	09/02/21	P10
Revision Details	By	Check	Date	Suffix

DCO APPLICATION

Client
Highways England
2 Colmore Square
38 Colmore Circus
Birmingham
B4 6BN

Development Consent Order Number
TR010054

Project Title
M54 to M6
Link Road

Development Consent Order Drawing Number
TR010054/APP/2.2

Drawing Title
LAND PLANS
REGULATION 5(2)(i)
SHEET 6 OF 10

Designed SM	Drawn AH	Checked TF	Approved SM	Date 09/02/21
Internal Project No. 60536736		Suitability SB		
Scale @ A1 1:2500		Zone Development Consent Order		

THIS DOCUMENT HAS BEEN PREPARED PURSUANT TO AND SUBJECT TO THE TERMS OF AECOM'S APPOINTMENT BY ITS CLIENT. AECOM ACCEPTS NO LIABILITY FOR ANY USE OF THIS DOCUMENT OTHER THAN BY ITS ORIGINAL CLIENT OR FOLLOWING AECOM'S EXPRESS AGREEMENT TO SUCH USE, AND ONLY FOR THE PURPOSES FOR WHICH IT WAS PREPARED AND PROVIDED.

Drawing Number HE514465	Originator -GHX	Volume -LLO	Rev P10
Location 22_SW_PR_Z	Type -DR-LR-1006	Role -DR-LR-1006	Number -DR-LR-1006

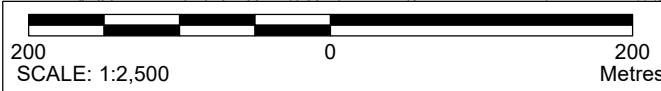

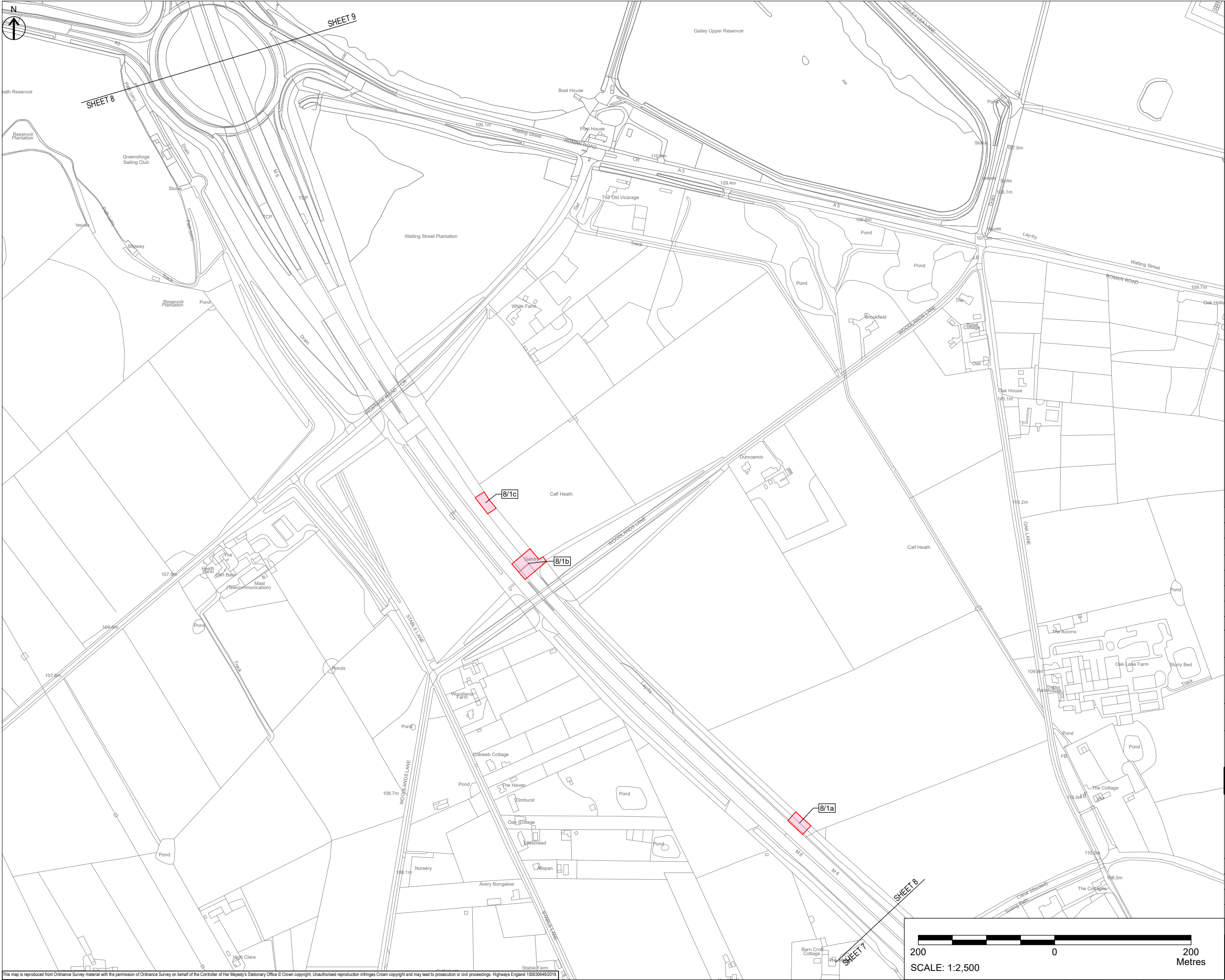

NOTES

1. ALL DIMENSIONS IN METRES UNLESS STATED OTHERWISE.

2. DO NOT SCALE FROM THIS DRAWING, USE ONLY PRINTED DIMENSIONS.

3. ALL EASEMENTS, SERVITUDES AND PRIVATE RIGHTS ARE PROPOSED TO BE EXTINGUISHED ON LAND THAT IS TO BE ACQUIRED UNLESS STATED OTHERWISE IN THE BOOK OF REFERENCE.

4. THIS DRAWING IS TO BE READ IN CONJUNCTION WITH ALL OTHER PLANS AND DOCUMENTATION, IN PARTICULAR THE WORK PLANS AND THE BOOK OF REFERENCE.

KEY

LIMITS OF LAND TO BE ACQUIRED OR USED PERMANENTLY OR TEMPORARILY (THE ORDER LIMITS)

PLOT REFERENCE NUMBER (REFER TO BOOK OF REFERENCE FOR FURTHER INFORMATION)

LAND NOT INCLUDED WITHIN THE ORDER LIMITS

LAND TO BE ACQUIRED PERMANENTLY

LAND TO BE USED TEMPORARILY

LAND TO BE USED TEMPORARILY AND RIGHTS TO BE ACQUIRED PERMANENTLY

NO POWERS SOUGHT IN DCO

First Issue	LD	SM	21/10/19	P01
Update following client review	LD	SM	05/11/19	P02
Minor amendments to drawing frame	LD	SM	22/11/19	P03
Pre DCO Submission Amendments	LD	SM	16/12/19	P04
Plot amendments following client review	CH	SM	16/01/20	P05
Updates to plot numbers and minor drawing frame amendments	CH	SM	24/01/20	P06
Notes amended on drawing frame	CH	SM	18/05/20	P07
Revision Details	By	Check	Date	Suffix

DCO APPLICATION

Client
Highways England
2 Colmore Square
38 Colmore Circus
Birmingham
B4 6BN

Development Consent Order Number

TR010054

Project Title

M54 to M6
Link Road

Development Consent Order Drawing Number

TR010054/APP/2.2

Drawing Title

LAND PLANS
REGULATION 5(2)(i)
SHEET 8 OF 10

Designed SM	Drawn CH	Checked JB	Approved SM	Date 18/05/20
Internal Project No. 60536736		Suitability S8		
Scale @ A1 1:2500		Zone Development Consent Order		

THIS DOCUMENT HAS BEEN PREPARED PURSUANT TO AND SUBJECT TO THE TERMS OF AECOM'S APPOINTMENT BY ITS CLIENT. AECOM ACCEPTS NO LIABILITY FOR ANY USE OF THIS DOCUMENT OTHER THAN BY ITS ORIGINAL CLIENT OR FOLLOWING AECOM'S EXPRESS AGREEMENT TO SUCH USE, AND ONLY FOR THE PURPOSES FOR WHICH IT WAS PREPARED AND PROVIDED.

Drawing Number HE514465	Originator -GHX	Volume -LLO	Rev P07
Z3_SW_PR_Z	-DR-LR-1008		
Location	Type	Role	Number



This map is reproduced from Ordnance Survey material with the permission of Ordnance Survey on behalf of the Controller of Her Majesty's Stationary Office © Crown copyright. Unauthorised reproduction infringes Crown copyright and may lead to prosecution or civil proceedings. Highways England 100030649/2019.

NOTES

1. ALL DIMENSIONS IN METRES UNLESS STATED OTHERWISE.
2. DO NOT SCALE FROM THIS DRAWING, USE ONLY PRINTED DIMENSIONS.
3. ALL EASEMENTS, SERVITUDES AND PRIVATE RIGHTS ARE PROPOSED TO BE EXTINGUISHED ON LAND THAT IS TO BE ACQUIRED UNLESS STATED OTHERWISE IN THE BOOK OF REFERENCE.
4. THIS DRAWING IS TO BE READ IN CONJUNCTION WITH ALL OTHER PLANS AND DOCUMENTATION, IN PARTICULAR THE WORK PLANS AND THE BOOK OF REFERENCE.

KEY

- LIMITS OF LAND TO BE ACQUIRED OR USED PERMANENTLY OR TEMPORARILY (THE ORDER LIMITS)
- 123 PLOT REFERENCE NUMBER (REFER TO BOOK OF REFERENCE FOR FURTHER INFORMATION)
- LAND NOT INCLUDED WITHIN THE ORDER LIMITS
- LAND TO BE ACQUIRED
- LAND TO BE USED TEMPORARILY
- LAND TO BE USED TEMPORARILY AND RIGHTS TO BE ACQUIRED PERMANENTLY
- NO POWERS SOUGHT IN DCO

First Issue	LD	SM	21/10/19	P01
Update following client review	LD	SM	05/11/19	P02
Minor amendments to drawing frame	LD	SM	22/11/19	P03
Pre DCO Submission Amendments	LD	SM	16/12/19	P04
Plot amendments following client review	CH	SM	16/01/20	P05
Updates to plot numbers and minor drawing frame amendments	CH	SM	24/01/20	P06
Notes amended on drawing frame	CH	SM	18/05/20	P07
Revision Details		By	Check	Date
Purpose of issue		DCO APPLICATION		
Client		<div><div>Highways England 2 Colmore Square 38 Colmore Circus Birmingham B4 6BN</div><div></div></div>		
Development Consent Order Number		TR010054		
Project Title		M54 to M6 Link Road		
Development Consent Order Drawing Number		TR010054/APP/2.2		
Drawing Title		LAND PLANS REGULATION 5(2)(i) SHEET 9 OF 10		
Designed SM	Drawn CH	Checked JB	Approved SM	Date 18/05/20
Internal Project No. 60536736		Suitability S8		
Scale @ A1 1:2500		Zone Development Consent Order		
THIS DOCUMENT HAS BEEN PREPARED PURSUANT TO AND SUBJECT TO THE TERMS OF AECOM'S APPOINTMENT BY ITS CLIENT. AECOM ACCEPTS NO LIABILITY FOR ANY USE OF THIS DOCUMENT OTHER THAN BY ITS ORIGINAL CLIENT OR FOLLOWING AECOM'S EXPRESS AGREEMENT TO SUCH USE, AND ONLY FOR THE PURPOSES FOR WHICH IT WAS PREPARED AND PROVIDED.				
Drawing Number HE514465	Highways England PIN Z3_SW_PR_Z	Originator -GHX	Volume -LLO	Rev P07
Location		Development Consent Order		DR-LR-1009

200

0

200

Metres

SCALE: 1:2,500

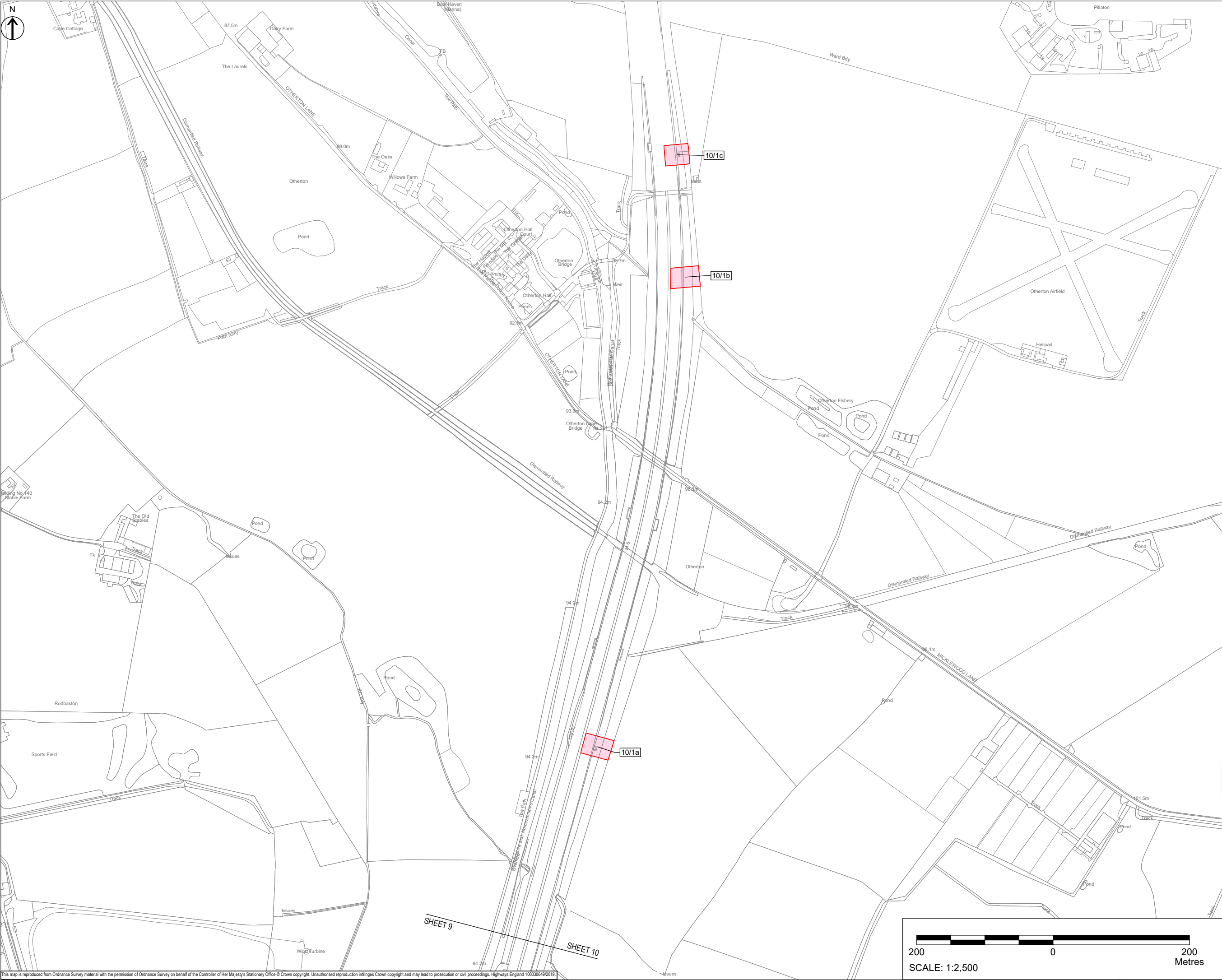

NOTES

1. ALL DIMENSIONS IN METRES UNLESS STATED OTHERWISE.

2. DO NOT SCALE FROM THIS DRAWING, USE ONLY PRINTED DIMENSIONS.

3. ALL EASEMENTS, SERVITUDES AND PRIVATE RIGHTS ARE PROPOSED TO BE EXTINGUISHED ON LAND THAT IS TO BE ACQUIRED UNLESS STATED OTHERWISE IN THE BOOK OF REFERENCE.

4. THIS DRAWING IS TO BE READ IN CONJUNCTION WITH ALL OTHER PLANS AND DOCUMENTATION, IN PARTICULAR THE WORK PLANS AND THE BOOK OF REFERENCE.

KEY

— LIMITS OF LAND TO BE ACQUIRED OR USED PERMANENTLY OR TEMPORARILY (THE ORDER LIMITS)

— P23 PLOT REFERENCE NUMBER (REFER TO BOOK OF REFERENCE FOR FURTHER INFORMATION)

LAND NOT INCLUDED WITHIN THE ORDER LIMITS

LAND TO BE ACQUIRED PERMANENTLY

LAND TO BE USED TEMPORARILY

LAND TO BE USED TEMPORARILY AND RIGHTS TO BE ACQUIRED PERMANENTLY

NO POWERS SOUGHT IN DCO

First Issue	LD	SM	21/10/19	P01
Update following client review	LD	SM	05/11/19	P02
Minor amendments to drawing frame	LD	SM	22/11/19	P03
Pre DCO Submission Amendments	LD	SM	16/12/19	P04
Plot amendments following client review	CH	SM	16/01/20	P05
Updates to plot numbers and minor drawing frame amendments	CH	SM	24/01/20	P06
Notes amended on drawing frame	CH	SM	18/05/20	P07
Revision Details	By	Check	Date	Suffix

Purpose of issue

DCO APPLICATION

Client
Highways England
2 Colmore Square
38 Colmore Circus
Birmingham
B4 6BN

Development Consent Order Number

TR010054

Project Title

M54 to M6 Link Road

Development Consent Order Drawing Number

TR010054/APP/2.2

Drawing Title

LAND PLANS
REGULATION 5(2)(i)
SHEET 10 OF 10

Designed SM	Drawn CH	Checked JB	Approved SM	Date 18/05/20
----------------	-------------	---------------	----------------	------------------

Internal Project No. 60536736	Suitability SB
Scale @ A1 1:2500	Zone Development Consent Order

THIS DOCUMENT HAS BEEN PREPARED PURSUANT TO AND SUBJECT TO THE TERMS OF AECOM'S APPOINTMENT BY ITS CLIENT. AECOM ACCEPTS NO LIABILITY FOR ANY USE OF THIS DOCUMENT OTHER THAN BY ITS ORIGINAL CLIENT OR FOLLOWING AECOM'S EXPRESS AGREEMENT TO SUCH USE, AND ONLY FOR THE PURPOSES FOR WHICH IT WAS PREPARED AND PROVIDED.

Drawing Number HE514465	Originator -GHX	Volume -LLO	Rev P07
Location Z3_SW_PR_Z	Type -DR	Role -LR	Number 1010

