

DO NOT SCALE

100
0 10
Millimetres

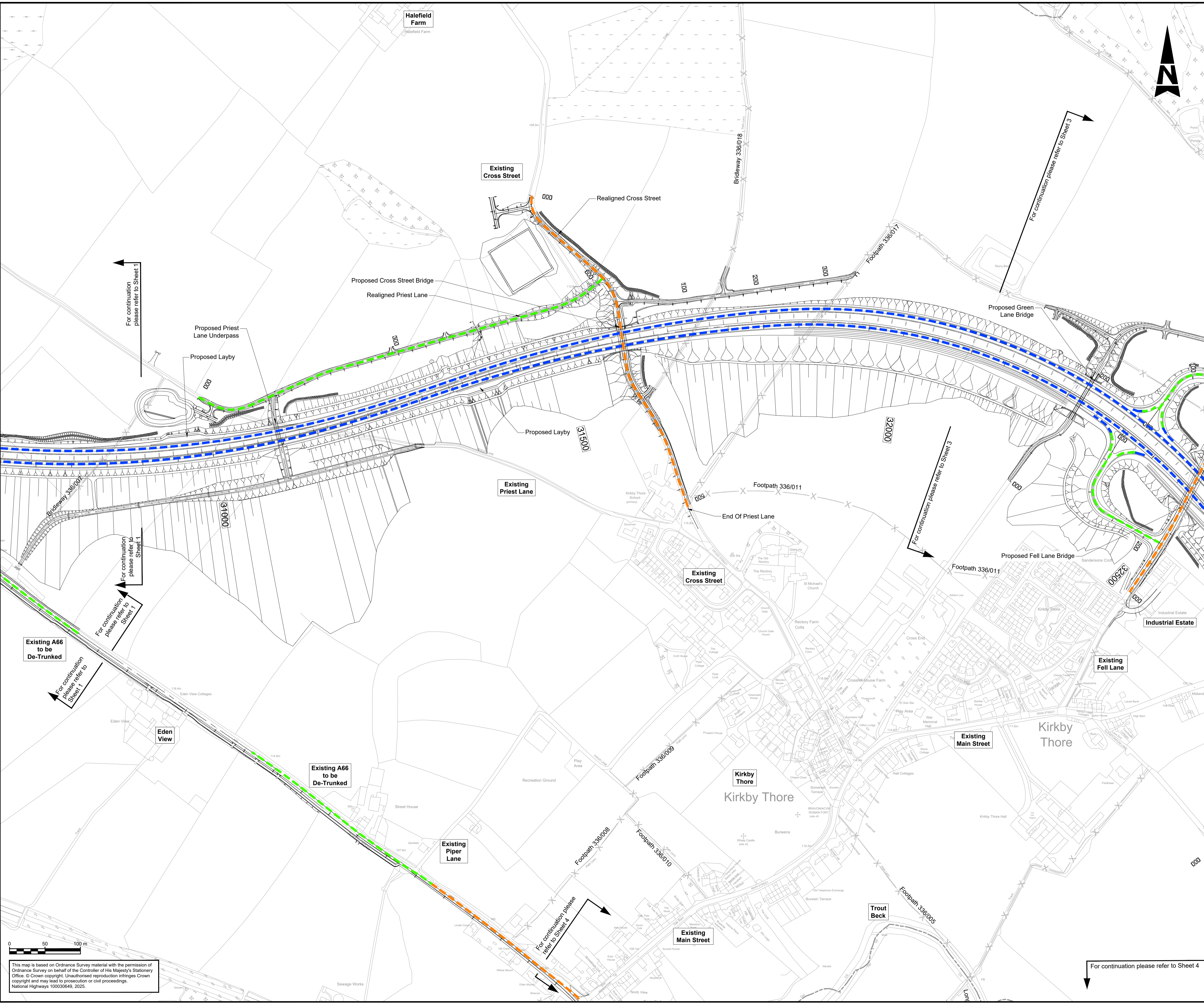

NOTES

- ALL DIMENSIONS ARE IN METRES UNLESS NOTED OTHERWISE.
- THESE TRAFFIC REGULATION MEASURES (SPEED LIMITS) PLANS SHOULD BE READ IN CONJUNCTION WITH OTHER PLANS AND APPLICATION DOCUMENTS, IN PARTICULAR THE DEVELOPMENT CONSENT ORDER SCHEDULE ENTITLED 'TRAFFIC REGULATION MEASURES, ETC' THE TRAFFIC REGULATION MEASURES (CLEARWAYS AND PROHIBITIONS) PLANS, THE CLASSIFICATION OF ROADS PLANS AND THE DE-TRUNKING PLANS.

KEY

- THE SCHEME (SHOWN FOR ILLUSTRATIVE PURPOSES ONLY)
- PROPOSED NATIONAL SPEED LIMIT ON DUAL CARRIAGEWAY AND SLIP ROADS (70MPH)
- PROPOSED NATIONAL SPEED LIMIT ON SINGLE CARRIAGEWAY ROAD (60MPH)
- PROPOSED 30MPH SPEED LIMIT
- EXISTING PUBLIC RIGHT OF WAY
- PARISH BOUNDARY
- CHAINAGE (MEASURED DISTANCE ALONG THE SCHEME LENGTH)

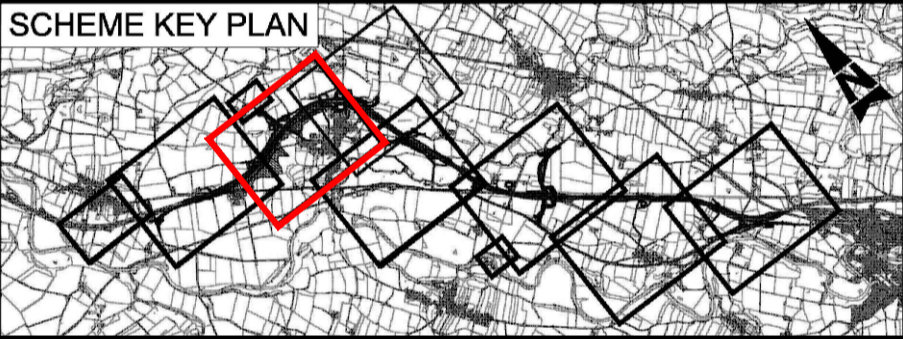
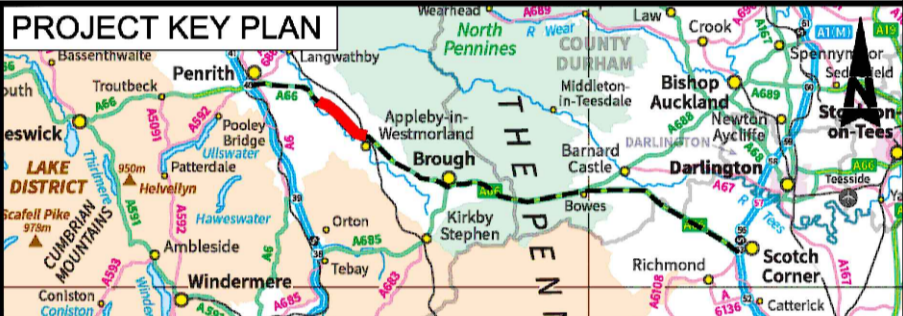

Description							
Status	Revision	Drawn	Checked	Reviewed	Authorised	Issue Date	
Description							
Status	Revision	Drawn	Checked	Reviewed	Authorised	Issue Date	
Description							
Status	Revision	Drawn	Checked	Reviewed	Authorised	Issue Date	
Description							
Updated to include post DCO changes							
Status	Revision	Drawn	Checked	Reviewed	Authorised	Issue Date	
S4	P01	KH	JG	AS	AS	19/12/24	
Description							
Updated following collaborative review							
Status	Revision	Drawn	Checked	Reviewed	Authorised	Issue Date	
S3	P02	KH	JG	AS	AS	10/06/25	
Drawing Suitability							Status
FOR REVIEW / COMMENT							S3

PINS Reference Number
TR010062/APP/5.23

Client
3 Piccadilly Place
Manchester
M1 3BN

Project Title
A66 NORTHERN TRANS-PENNINE PROJECT
SCHEME 0405
TEMPLE SOWERBY TO APPLEBY

Drawing Title
TRAFFIC REGULATION MEASURES
(SPEED LIMITS) PLANS
REGULATION 5(2)(O)
SHEET 2 OF 7

Drawing Number
Project
HE615324
004_AL_SCHEM
Location
A1
Scale
@ A1
1:2500
Project Ref. No.
HE615324
Sheet
2 of 7
Rev.
P02

This map is based on Ordnance Survey material with the permission of Ordnance Survey on behalf of the Controller of His Majesty's Stationary Office. © Crown copyright. Unauthorised reproduction infringes Crown copyright and may lead to prosecution or civil proceedings.
National Highways 100030649, 2025.