

DO NOT SCALE

Millimetres

0

10

100

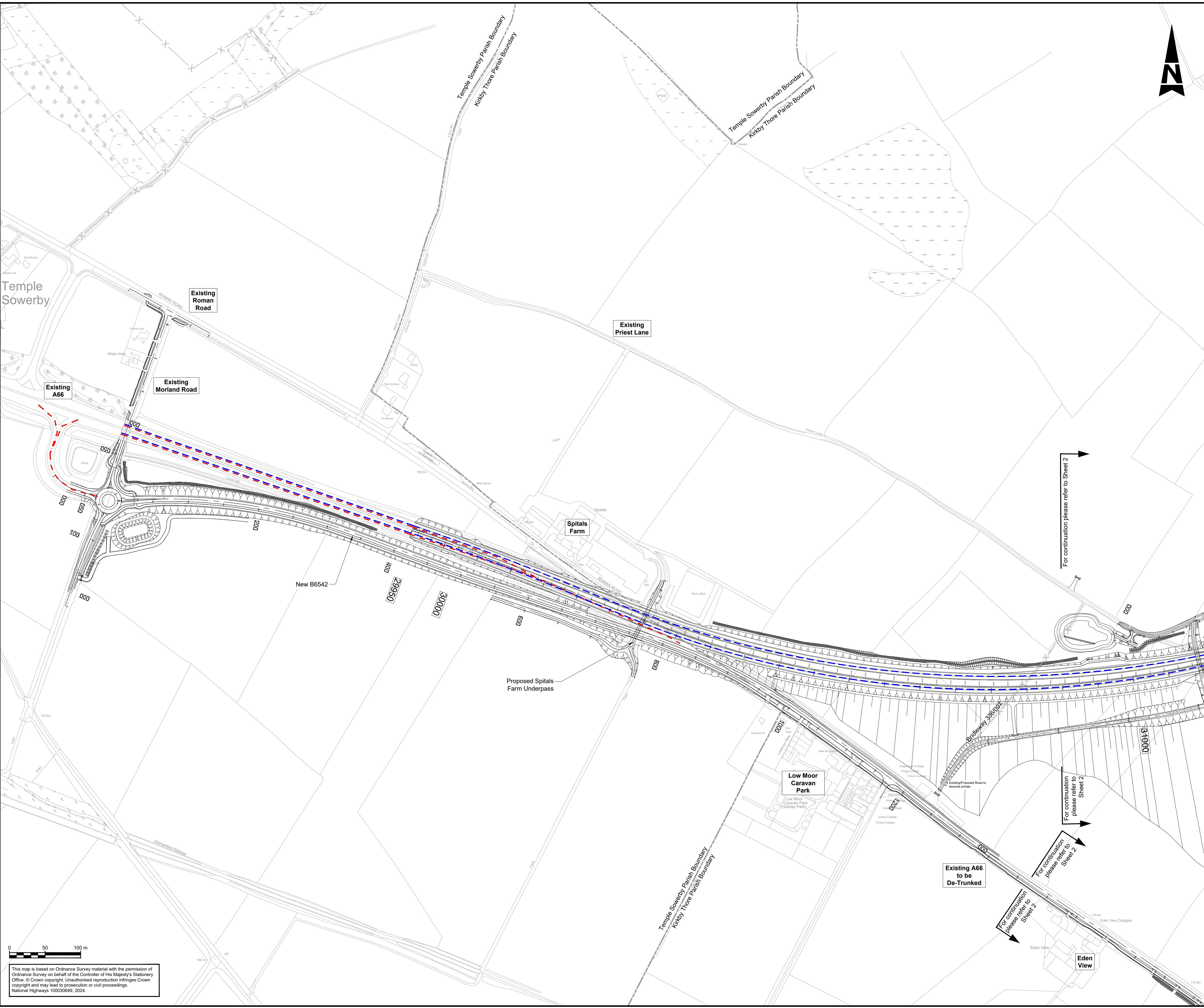

NOTES

- ALL DIMENSIONS ARE IN METRES UNLESS NOTED OTHERWISE.
- THESE TRAFFIC REGULATION MEASURES (CLEARWAYS AND PROHIBITIONS) PLANS SHOULD BE READ IN CONJUNCTION WITH OTHER PLANS AND APPLICATION DOCUMENTS, IN PARTICULAR THE DEVELOPMENT CONSENT ORDER SCHEDULE ENTITLED 'TRAFFIC REGULATION MEASURES, ETC', THE TRAFFIC REGULATION MEASURES (SPEED LIMITS) PLANS, THE CLASSIFICATION OF ROADS PLANS AND THE DE-TRUNKING PLANS.

KEY

- THE SCHEME (SHOWN FOR ILLUSTRATIVE PURPOSES)
- PROPOSED CLEARWAY EXTENTS ON TRUNK ROAD (TO INCLUDE VERGES, HARD SHOULDERS AND SLIP ROADS; AND TO EXCLUDE LAYBYS)
- EXTENTS OF EXISTING CLEARWAY TO BE REVOKED OR PARTIALLY REVOKED
- EXISTING PUBLIC RIGHT OF WAY
- PARISH BOUNDARY
- CHAINAGE (MEASURED DISTANCE ALONG THE SCHEME LENGTH)

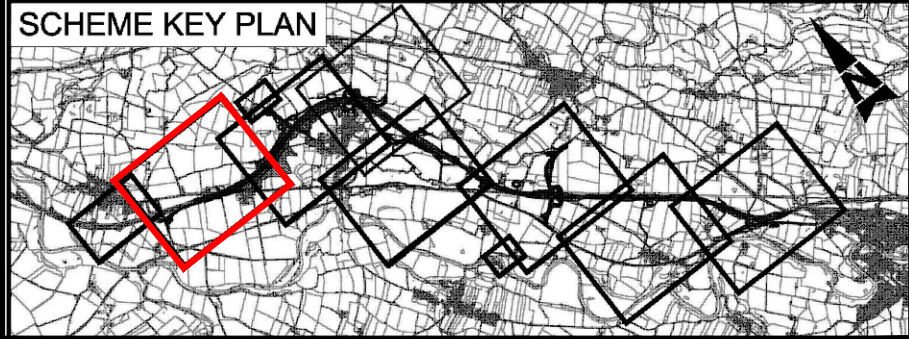
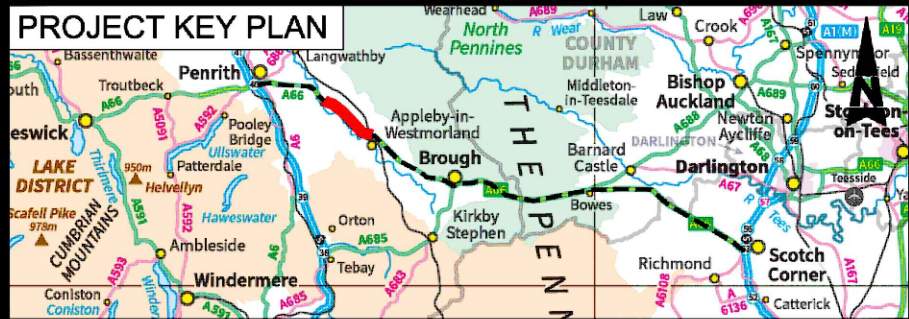

Description	Status	Revision	Drawn	Checked	Reviewed	Authorised	Issue Date
Description	Status	Revision	Drawn	Checked	Reviewed	Authorised	Issue Date
Description	Status	Revision	Drawn	Checked	Reviewed	Authorised	Issue Date
Description Updated to include post DCO changes	S4	Revision P01	Drawn KH	Checked JG	Reviewed AS	Authorised AS	Issue Date 19/12/24
Description Updated following collaborative review	S3	Revision P02	Drawn KH	Checked JG	Reviewed AS	Authorised AS	Issue Date 31/07/25
Drawing Suitability	FOR REVIEW / COMMENT						Status S3

PINS Reference Number
TR010062/APP/5.22

Client
3 Piccadilly Place
Manchester
M1 3BN



Project Title
A66 NORTHERN TRANS-PENNINE PROJECT
SCHEME 0405
TEMPLE SOWERBY TO APPELBY

Drawing Title
TRAFFIC REGULATION MEASURES
(CLEARWAYS AND PROHIBITIONS) PLANS
REGULATION 5(2)(O)
SHEET 1 OF 7

Drawing Number
Project
HE615324
004_AL_SCHEM
Location
A1
Scale
@ A1:
1:2500
Project Ref. No.
HE615324
Originator
BBA
Volume
HAC
DR
CH
301601
Type
Role
Number
Sheet
1 of 7
Rev.
P02

This map is based on Ordnance Survey material with the permission of Ordnance Survey on behalf of the Controller of His Majesty's Stationary Office. © Crown copyright. Unauthorised reproduction infringes Crown copyright and may lead to prosecution or civil proceedings.
National Highways 100030640, 2024.